



Stereo Speakers with Wireless Bluetooth Technology



XC-5222

User Manual

材质：80g书纸
印色：正反单黑
尺寸：210mm*145mm
20150911年有修改

Box Contents
2 x Wireless Speakers
1 x 3.5mm audio cable
1 x USB power cable

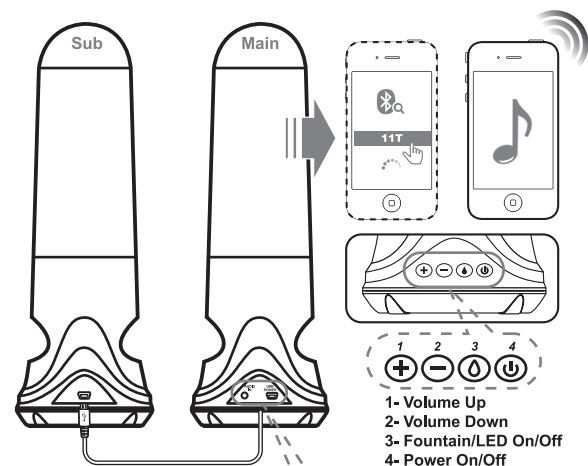

PLAY FROM A BLUETOOTH DEVICE

- Step 1: Connect two speakers
- Step 2: Turn on the Power from main speaker
- Step 3: Activate the Bluetooth function in your Bluetooth device
- Step 4: Select "11T" on your Bluetooth device for pairing. (For some devices, you may need to input "0000" as pairing password.)
- Step 5: Start music play on your Bluetooth device.

Note: The effective operation range between the speaker and your Bluetooth device is approximately 10 meters (30 feet).

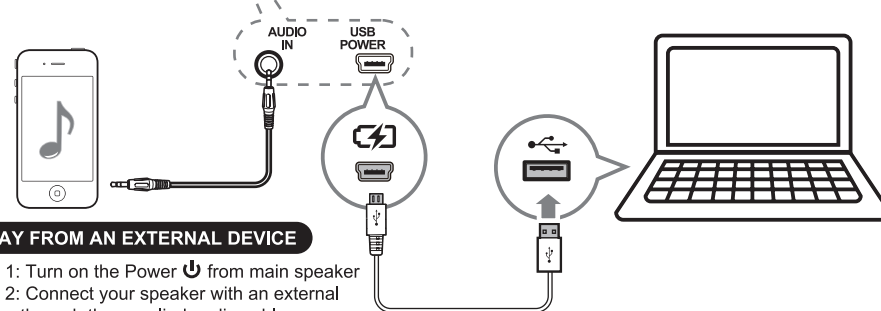

PLAY FROM AN EXTERNAL DEVICE

- Step 1: Turn on the Power from main speaker
- Step 2: Connect your speaker with an external device through the supplied audio cable.
- Step 3: Start music play on your device.

TROUBLESHOOTING

Warning

- Never remove the casing of this apparatus.

To keep the warranty valid, never try to repair the system yourself.

If you encounter problems when using this apparatus, check the following points before requesting service.

No power

- Recharge your speaker.

No sound

- Adjust volume on your mobile phone or PC/Mac.
- Make sure that your Bluetooth mobile phone is within the effective operation range.
- Check if you have selected the correct audio source.

No response from the speaker

- Restart the speaker.

Distributed by:
TechBrands by Electus Distribution Pty.Ltd.
NSW 2116 Australia
Ph: 1300 738 555
Int'l: +61 2 8832 3200
Fax: 1300 738 500
www.techbrands.com