

LED Table Lamp & Work Light

SL-3139

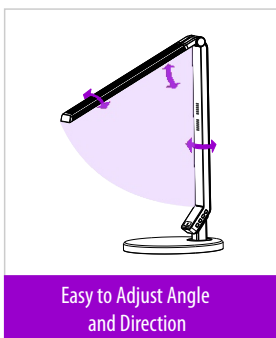
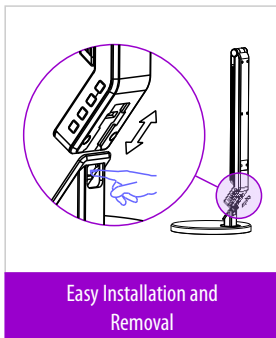

Guide:

- Remove contents with in the box
- The back of the light's bracket has a tab that clicks in to the top part of the base
- Once the light is connected to the base, use the supplied power adaptor to connect to the DC input socket (refer to box for the lamp parts list).
- You are able to adjust the light angle by moving the arm part up to 85°, down to 90°, rotate 340° or swivel 360° (mind the lead from the power adaptor when adjusting the base).
- Press the Power button on the Touch Sensitive Button Panel to turn the Lamp On or Off.
- Press the Up or Down button on the Touch Sensitive Button Panel to adjust the colour temperature output.

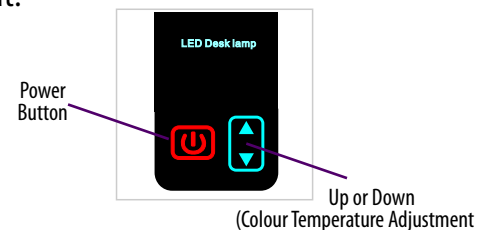

No Ultraviolet



No Flash



Safe Low Voltage



Long Life LEDs

NOTE:

- If movement is limited, do not apply force, this will damage the unit
- Always use the parts included with the lamp
- The Lamp Arm may become warm if used for a long period continuously
- Keep unit away from any heat source or high temperatures
- Do not get the unit wet

Specifications:

Colour Temperature:	3000-5500K
Power:	12V, 9W Max
Illumination:	270 Lumens Max
Luminous Intensity:	800 Lux Max
Lamp Holder Arm:	340° swivel
Base:	360° swivel
Arm:	85° Up / 90° Down
Dimensions:	
* Light Arm (folded):	345(L)mm
* Light Arm (extended):	665(H)mm
* Base:	199(Dia.) x 16(H)mm

Distributed by:
TechBrands by
Electus Distribution Pty. Ltd.
320 Victoria Rd, Rydalmere
NSW 2116 Australia

Ph: 1300 738 555
Int'l: +61 2 8832 3200
Fax: 1300 738 500

www.techbrands.com

Made in China