

## Basic Troubleshooting

QP5588 ( 8-30VDC Power Source Measure DC50A )

### LED not displayed

Check the power source is correct voltage and correct polarity.

### Display appears scrambled

Check that all connections are correct and tight.  
Check that there is no harsh interference nearby.

### Just display 1 or -1

Voltage out of range.  
Check the connection of signals cable.

### Caution

Do not disassemble  
The power polarity is not reversed

### Installation Size

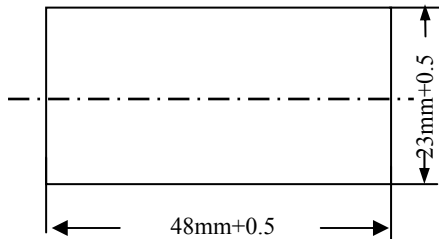

## Digital Panel Meter MANUAL

**Distributed by:**  
**Electus Distribution Pty Ltd**  
**320 Victoria Rd**  
**Rydalmere NSW 2116 Australia**  
**Phone: 1300 738 555**  
**Fax: 1300 738 500**  
**[www.electusdistribution.com.au](http://www.electusdistribution.com.au)**

## QP5588 Digital Voltmeter

Power Source DC8-30V measure DC voltage

### FEATURES:

- Ultra-bright LED display
- Polarity: Automatic Sensing
- Automatic Calibration upon zero reading for 0V input
- High accuracy and Low cost
- Easy to install
- Re-calibrated by adjusting the calibration potentiometer
- Ideal for auto, boat, industrial, commercial & domestic use

### OPERATION SPECIFICATIONS:

Power Source	DC8-30V
Maximum Count	1999 (4 digit)
Operating Temperature	0 to 55□
Storage Temperature	-10 to 80□
Relative humidity	20%~80%
Weight	30-35g
Dimension	W50mm x H26mm x D23.5mm
Panel Cutout	48mm×23mm
Sample Frequency	400ms

### PARAMETER:

	Model	Range	Resolution	Input Impedance	Max Voltage Input	Accuracy
●	QP5588	±199.9mV	0.1mV	100MΩ	±10V	±0.3%+1digit

### WIRING DIAGRAM:

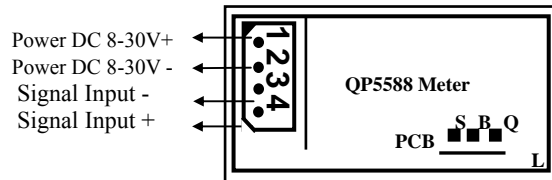

- PIN 1: DC8-30V +(Positive supply)
- PIN 2: DC8-30V - (Negative shunt supply)
- PIN 3: Signal Input - (Negative sense)
- PIN 4: Signal Input + (Positive sense)

### MEASURE DC50A WITH 75mV/50A Shunt [Resolution: 0.1A]

#### CAUTION:

50A shunt MUST be connected in the negative loop of the circuit.

