



**Wi-Fi RFID Access Keypad
with Backlit Keypad
LA-5358**

1. Introduction, Features and Specifications

1.1 Introduction

Wi-Fi RFID Access Keypad realises the card reading and keypad operation functions, lock, alarm, ring bell, exit button and the magnetic contact switch on the door.

The access host supports 125KHz EM and HID cards.

It controls 1 door, supports up to 2000 users in total, each user has one card and one pin. The access control unit supports 1 master code, one manager add card, one manager delete card, 1 anti-duress card and 1 anti-duress pin, providing users with easy operation and safe guarantee.

1.2 Features

- Control Doors Remotely
- Free iOS® & Android App
- Touch Keypad
- Control Via Access Controller or Single Door Entry
- Waterproof
- Backlit keypad
- Anti-Tamper & Anti-Vandal

1.3 Specifications:

Voltage:	12-24VDC
Card Type:	EM 125KHz / HID
Card Reading Distance:	3-6cm
Adjustable Door Relay time:	0-99 seconds
Adjustable Alarm Time:	1-3 minutes
Weigand Interface:	26-37 bit
Wiring Connection:	Electric Lock, Exit Button, External Alarm
IP Rating:	IP65
Standby Current:	35mA
Dimensions:	125(H) x 83(W) x 22(D)mm

2. Installation & Wiring Diagram

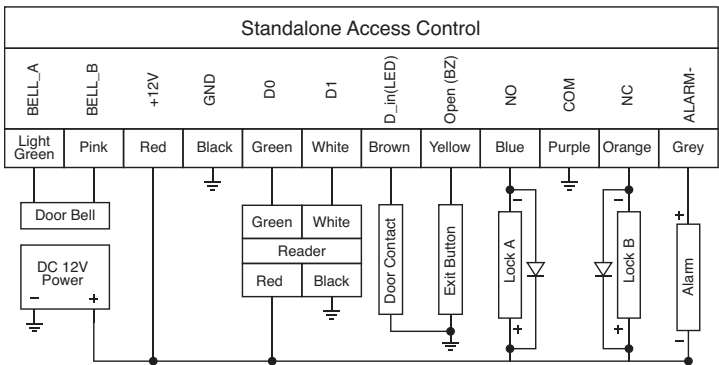

LA5358 Single Door (DC Power Supply)

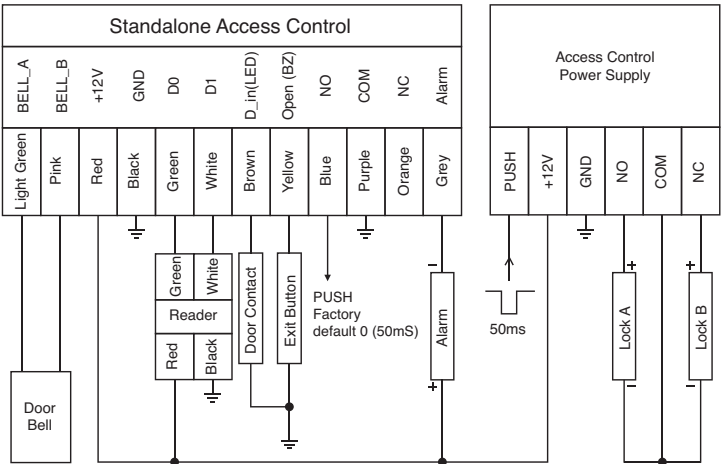

LA5358 Single Door (Special Access Control Power Supply)

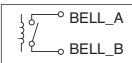

Principle of Door Bell Connector

Each press of door bell button, contact of relay in BELL_A and BELL_B will close contact for 200ms then release.

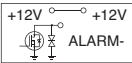

Principle of Alarm Connector

The field-effect tube will be conducted when alarm is activated; it will be not conducted when alarm is removed.

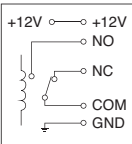

Principle of Electronic Lock

The relay will close contact to unlock the lock and will release after unlocking
 COM: Common, Relay Contact
 NC: Normal Close, Normally Keep Closed to COM
 NO: Normal Open, Normally Keep Opened to COM

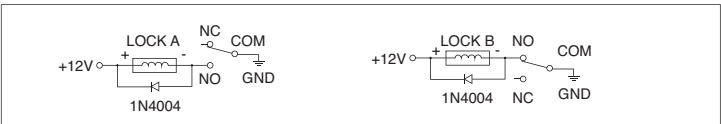

Wiring of Electronic Lock

Connect COM and GND, connect two ends of electronic lock with +12V and NO (or NC), complete circuit.

Type A electronic lock: Fail Secure lock (Unlock when power on), such as Electronic Controlling Lock, smart lock. etc.

Type B electronic lock: Fail Safe Lock (Unlock when power off), such as Electromagnetic Lock, Electronic Bolt Lock, etc.

1N4004 Diode: Prevent high voltage to two ends of the electronic lock while the contact of relay disconnect. Without diode, there will be a high voltage pulse interference to circuits and the life time of the relay will be greatly reduced.

3. Manager Cards Operation

3.1. Add user card(s) (In dual door mode, users can be only added to zone 1)

Read manager add card Read User card Read manager Add Card
Cards can be added continuously.

3.2. Delete User Card(s)

Read manager delete card Read User Card Read Manager Delete Card
Cards can be deleted continuously.

4. User Operation

4.1. To unlock the lock by one card: Read valid card once, the lock will be unlocked.

4.2. To unlock the lock for card and PIN users

Read valid card once Input 4-6 digits PIN #, the lock will be unlocked.

4.3. To unlock the lock for card or PIN users

Read valid card OR Input 4-6 digits PIN #, the lock will be unlocked

4.4. To unlock the lock for multi-cards: Read 2-10pcs valid cards (time interval can not exceed 5s), the lock will be unlocked.

Precondition: Set the door entry by card only, and set “2-10” for opening the door by multi-cards

4.5. Toggle Mode

In normal mode, every time a valid card/tag read or PIN input, the replay will operate, for the preset replay pulse time.

Every time a valid card/tag read or PIN input in. Toggle mode, the relay changes state, which will not turn back until read card/tag or input PIN again.

4.6. To change the PIN of a PIN user

- Read Card Input Old PIN # Input new PIN # Input new PIN #

OR

- User ID number Input old PIN # Input new PIN # Input new PIN #

Remark: For users without card, must get ID number and initial PIN from the master. For Zone 1, the first digit of PIN must be “1”; for Zone 2, the first digit of PIN must be “2” for the card users with PIN “1234”, must use reading card to change the PIN for the first time.

4.7. Door Bell

Press the door bell button on the access control unit, the buzzer will sound ring back tone, at the same time, the I box's built-in door bell or the outdoor bell will ring.

Remark: When the work mode is set in Auto Mode (Factory Default Mode), there will be no ring back tone without the I Box.

5. Alarm

5.1. Anti Tamper Alarm

When the access control unit is disassembled illegally, the access control unit's buzzer and the external alarm will operate.

5.2. Door Status Switch

When connect with door status switch, if the door is opened illegally, the access control unit's buzzer and the external alarm will operate.

5.3. Anti-Duress Alarm

When read zone 1 duress card / input 8digits duress PIN or zone 2 duress card / input 8 digits duress PIN, then press #, the corresponding lock will open, at the same time, the external alarm will operate, but the access control unit's buzzer will not operate.

5.4. To remove the alarm

Read valid card or input master code can remove the alarm. If there is no operation, the alarm will remove automatically after 1 minute.

6. Keypad Lockout or Alarm

To prevent consecutive enter of an invalid master code, user password, or anti-duress or invalid card, this function will be activated after 10 times consecutive errors input. There are 3 modes available: No keypad lockout or alarm, keypad locked for 10 minutes, alarm for 1-3 minutes.

7. To Reset to Factory Default

Keypad access control, power off, keep pressing * and power on, the logo will turn in orange after 1 second, release it until hearing two shot beep, then hearing a long beep, enter normal mode, reset to factory default setting is successful.

Touch panel access control. Power off, power on, the logo will turn in orange after 1 second, press * within 1 second, release it until hearing two shot beep, then hearing a long beep, enter normal mode, reset to factory default setting is successful.

Remark: Reset to factory default, the users' information is still retained.

8. Sound and Light Indication

Operation Status	Logo Colour	Buzzer
Standby	White	
Press Key		Short Ring
Read Card	Green	Long Ring
Unlock the Lock	Green	Long Ring
Operation Successful	Green	Long Ring
Operation Failed		2 Short Ring
PIN Inputting	Slow Flash Red	
Card & PIN Reading	Slow Flash Red	
Multi-Card Reading	Slow Flash Red	
1st Menu	Slow Flash Red	
2nd Menu	Slow Flash Orange	
Under Setting	Orange	
Manager Card Reading	Orange	2 Short Ring
Manager Card Exit	White	Long Ring
Alarm	Quick Shine in Red	Alarm
Ring-back Tone		Ding-Dong

9. Master Setting

Logo LED Light Indication		Remarks	Functions
White Logo	Red Logo LED Flash	Factory Default: 888888	To enter the programming mode
*	6-8 digits Master code #		

Enter Master Operation Mode. It will return to normal mode if there is no right Master PIN input in 5 seconds. After input of right master PIN, it will also return to normal mode if there is no valid operation in 30 seconds. Press “#” to confirm the input number, return to previous menu by press “*”; the logo light will indicate the operation mode.

Note: that to undertake the following programming, the master user must be logged in.

9.1. Basic Operation:

Basic Operation			
Red Flash	Orange	Functions	Remarks
0	6~8 digits new master code #Repeat 6~8 digits new master code #	Factory Default: 888888	Change the master code
1	Read Card	1. The user ID number is any number among 1-2000. 2. Card number must be 8 or 10 digits, if the card number is less than 8 or 10 digits, input 0 before the card number 3. User can be added continuously without exiting the program.	Rotate Operation ³ To add card users ²
	1~2000(ID), #, read card	To add PIN users	
2	Read Card	Delete one Card	Rotate Operation
	8 or 10 digits card number ¹ #		
	1~2000(User ID number), #, 4~6 digits PIN, #	Delete one user	
2	0000, # (Note: This is a dangerous option, so use with care)	Delete all users	
3	0, #	Entry is by Card only	To set open way
	1, #	Entry is by Card and PIN together	
	2, #	Entry is by either card or PIN (Factory default setting)	
4	0, #	To set door relay time 50mS	Factory default setting: 50mS
	1-99, #	To set door relay time 1-99S	

Note:

1. 8 digits card number, such as: 118, 32319, some cards has no mark of the first 3 digits 118, remains 32319, it requires to add card by read card, adding cards by input card number is not acceptable; 10 digits card number, such as 0007765567, some cards has no mark of the first 3 digits 000, remains 7765567, requires to input 10 digits 0007765567 by add 000 before 7765567.
2. A PIN 1234 is added for a card, it can not be used to unlock the lock, can be used to change PIN.
3. After one card is added, you can continue to add other cards or PIN without exiting the mode 1.

9.2. Advanced Operation:

Advanced Application				
Red Flash	Orange Flash	Orange	Functions	Remarks
6	0	Orange Flash	Pairing the smartphone with Wi-Fi	Pairing the smartphone with Wi-Fi
	1	Read Card	Set add card	To add card user
	2	Read Card	Set delete card	To delete card user
	3	Read Card	To set duress users	To set duress user
	4	8 digits duress PIN, #	To set duress PIN	To set duress PIN
	5	0, #	Automatic mode (Factory default)	Relay setting
	6	1, #	Set Zone 1 as Auto-lock switch ¹	
	7	1-10, #	Factory default setting: 1	To set open door by multi cards ²
	9	User ID Number # card number # card quantity #	The card number must be consecutive card quantity is between 1-2000	To add a series cards users ³
		1	Administrator open door 1	Exit automatic ⁴
System Setting				
7	0	1-15, #	Factory default setting: 0	To set facility code
	1	0, #	Wiegand reader mode	To set working mode
		1, #	Standalone for single door (Factory default)	
		5, #	Anti-passback for single door	
	2	26-37, #	(Factory default setting: 26)	To set Wiegand format
	3	0,#	4-6 digis key press sends card number	To set keypad transmission format
		1, #	Each key press sends 4 bit output data (Factory default)	
		2, #	Each key press sends 8 bit output data	
	4	0, #	Close Alarm ⁵	To set Alarm
		1-3, #	Alarm time is 0-3 minutes for option (Factory default 1 minute)	

Operational Setting				
8	1	0, #	Indicator light OFF ⁶	To set logo LED light
		1, #	Indicator light ON (Factory default)	
	2	0, #	Disable Buzzer ⁷	
		1, #	Enable Buzzer (Factory Default)	
	3	0, #	Disable Keypad Backlight	
		1, #	Enable Keypad Backlight (Factory Default)	
		2, #	Auto Mode ⁸	
	4	0,#	Disable anti tamper alarm (Factory Default)	
		1, #	Enable anti-tamper alarm	
	5	0, #	No keypad lockout or alarm (Factory Default)	
		1, #	In 10 minutes, if there's 10 times ⁹ invalid card or wrong password, the device will lock on for 10 minutes.	
		2, #	In 10 minutes, if there's 10 times invalid card or wrong password, the device will alarm.	

Remark:

1. Everytime a valid card/tag read or PIN input in Toggle mode, the relay changes state, which will not turn back until read card/tag or input PIN again.
2. The door will open only when read the valid card quantity up to the quantity set. It is only for Card Only mode.
3. The card number must be consecutive, Card quantity is between 1-2000.
4. After unlocking, enter the normal working state.
5. After closed the alarm, anti-tamper, anti-duress and door magnetic alarm are invalid.
6. Refers to static state, normal indication according to operation.
7. Enter the administration for password correctly, the buzzer alarm in the normal phonation.
8. Each key press or read card, keypad backlight will light 30S delay after the close, in close state, the first key is just to start the keyboard light, no any function.
9. 10 times consecutive errors including: enter an invalid master code, user password, or anti-duress or invalid card.

10. Various Working Modes Application

The device has 3 working modes:

1. Wiegand Reader
2. Standalone for single door (Factory Default Setting)
3. Anti-pass back for single door

Through Wiegand data lines, can make the device and external card reader are connected together, to realise of various functions.

Card number and PIN etc information will store in the device.

The external reader only read card or as a device for input PIN, you can connect with a numbers of readers, but function all same.

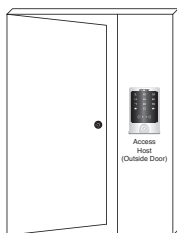

Standalone for Single Door

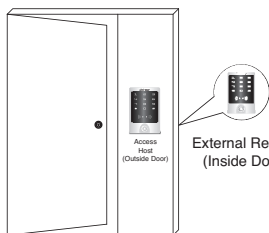

Anti-passback for Single Door

10.1 Wiegand Reader Mode

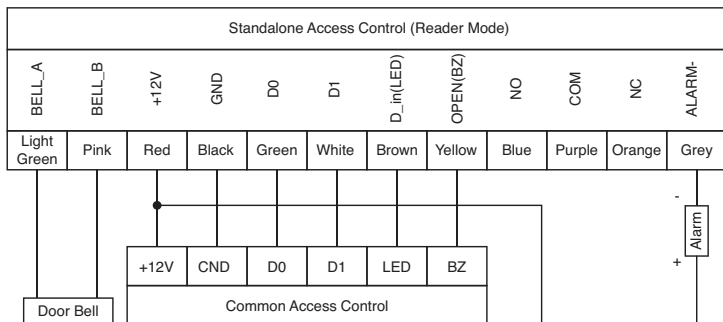

LA5358 Reader Wiring Diagram

In this mode, the access host works as reader, it can be done below settings.

Administrator Setting				
White	Red Flash	Functions	Remarks	
*	6-8 Digits Master Code #	End Programming Mode	Factory Default: 888888	
Reader Setting				
Red Flash	Orange Flash	Orange	Functions	Remarks
0		6~8 digits new master code # Repeat 6~8 digits new master code #	Factory Default: 888888	Change the master code
7	0	0-15, #	Factory default setting: 0	To set facility code
	2	26-37, #	Factory default setting: 26	To set Wiegand format
	3	0, #	4-6 digits key press sends card number	To set keypad transmission format
		1, #	Each key press sends 4 bit output data	
2, #	Each key press sends 8 bit output data			

	4	0, #	Close Alarm	To set Alarm
		1-3, #	Alarm time is 0-3 minutes for option	
		0, #	No door bell function	To set door bell function
		1, #	Built-in door bell - ON (Factory default setting)	
		2, #	External door bell - ON	
		3, #	Built-in & external door bell - ON	
8	1	0, #	Disable	To set logo LED light
		1, #	Enable (Factory default setting)	
	2	0, #	OFF - The device will be in silence except enter the programming mode	To set keypad tone ON or OFF
		1, #	ON - The device will give the voice when press the keys (Factory default setting)	
	3	0, #	Disable keypad backlight	To set keypad backlight
		1, #	Enable keypad backlight (Factory default setting)	
		2, #	Automatic mode Normally it is off (sleeping mode) but wake up with human approach	To set keypad backlight
	4	0, #	Disable anti-tamper alarm (Factory default setting)	To set anti-tamper alarm
		1, #	Enable anti-tamper alarm	

When LED level is low, logo light will turn Green, after 30 seconds or LED level rising, logo light will return to normal. When BZ level is low, the Buzzer will beep, after 30 seconds or BZ level rising, the Buzzer will return to normal.

When the access host worked as reader, both card number and keypad transmits in Wiegand format, the output data are shown by the Low Level of D0 & D1 cable:

D0: Low level means 0, green cable

D1: Low Level means 1, white cable

The Pulse Width of Low level is 40uS, Bit period is 2mS.

The digit of Car number can be set to 26~27Bit, should be matched with the controller. (Factory default is 26Bit) Wiegand 26 card reader, HID card can output Wiegand 26~37 automatically, other cards are output Wiegand 26 compulsively. Wiegand 27~37 card reader, all cards are forced output Wiegand 27~37.

Keypad transmission can be set in the following 3 modes.

Model 0: The reader will transmit the PIN data when it receives the last key (#) press after PIN code

Format: Decimal card number with 10-digit, Facility Code (1st ~ 4th digit) + PIN Code (5th ~10th digit)

(Facility code is any digits between 0~15, PIN code is 4~6 digits).

Example: Facility code: 15

PIN code: 2999

Press 2999#, then output format will be: 0015002999

PIN code: 999999

Press 999999#, then output format will be 0015999999

Model1: 4-Bit

The output data is provided in following format after every key is pressed:

1 (0001), 2 (0010), 3 (0011)

4 (0100), 5 (0101), 6(0110)

7 (0111), 8 (01110000), 9(01101001)

* (01011010), 0 (11110000), # (01001011)

10.2 Standalone for Single Door

In this mode, the access host uses can open the door by valid card or PIN, it supports connecting external card reader for exiting door.

When input duress PIN/Card, the door will open, at the same time, the external alarm operates.

10.3. Anti-passback for Single Door

- In this mode, access host install outside is for entering door, external reader inside for exiting door, they build up a single door anti-passback system, access host is the anti-passback master unit.
- Read valid card or input PIN on access host, door will open; read valid card or input PIN on external reader door will open.
- When input duress PIN/Card, the door will open, at the same time, the external alarm operates
- When input duress PIN/Card on external reader, the door will open, at the same time, the external alarm operates.
- Open type forced Card Only, the user PIN is invalid.
- The users can only enter door when read valid card on access host, and exit from the inside external reader, if without the entering record from access host, the users can not exit from the inside reader, also the users can't enter in twice without the first exit record.

10.4. WiFi Function introduction

This model added Wi-Fi function based on door access controller. User can open the door from any distance when Wi-Fi is connected. This instruction is only for Wi-Fi function, for more details please refer to full instructions.

- Installation of "eWeLink" app:
 1. For IOS hand phone, scan the below left side QR code or find "eWeLink" at apple store. And please update to latest version.
 2. For android hand phone, scan the below right side QR code or search "eWeLink" at search engine for app. And please update to latest version.



IOS QR code



Android QR code

- Registration and login "eWeLink" user account:
 1. Open "eWeLink" app on user's phone, register new account step by step for the first time use with user's phone number or email address. Please note that password should not less than 8 digital numbers.
 2. After successful registration, the user need to login with user's own registered phone number or email and password. The app will not close until user logout, once its logged out the user has to login again.



11. Simple Troubleshooting

Fault Phenomenon	Fault Cause	Reason & Solution
Reading distance is too close	<ol style="list-style-type: none"> 1. Card problem 2. Switch power supply interferences card reading 	<ol style="list-style-type: none"> 1. Please use original made card 2. Wiring power supply and access host shell to ground wire.
Set user PIN failed	<ol style="list-style-type: none"> 1. Wrong way of PIN setting 2. Setting PIN under card reading mode 	<ol style="list-style-type: none"> 1. In mode of two Doors 1, the 1st digit of PIN must be 1. Two doors 2, the 1st digit of PIN must be 2. 2. User PIN cannot be 1234 3. User PIN only can be 4~6 digits
Can't open door after inputting user's PIN	Use 1234 as user's PIN	1234 is the initial value, can't be used to open doors, unless after resting them to other 4~6 digits.
Alarm under normal situation	Light leaking when install access host	Leaning on wall closely when install access host
No reaction when reading card	Not on standby status	Exit by pressing * until logo light turns to white
Keypad light off	Set keypad light mode improperly	<ol style="list-style-type: none"> 1. Set the keypad light to always On or automatic mode 2. Under automatic mode, keypad light will turn on when people are approaching
Cannot enter Administrator Setting Mode	Forget master code	Reset to Factory Default, default master code is 888888, need to reset conditions and specifications, but users' information is still retained.

Distributed by:
 TechBrands by Electus Distribution Pty. Ltd.
 320 Victoria Rd, Rydalmere
 NSW 2116 Australia
 Ph: 1300 738 555
 Int'l: +61 2 8832 3200
 Fax: 1300 738 500
 www.techbrands.com
 Made in China

Door Access Controller

Hand phone instruction

1. Introduction :

This model added Wi-Fi function based on door access controller. User can open the door from any distance when Wi-Fi is connected. This instruction is only for Wi-Fi function, for more details please refer to LA5358 product's full instruction.

2. Download "Ewelink" APP & install

1. For IOS system, please scan the left QR or search Ewelink APP from app store.
2. For Android system, please scan the right QR or search Ewelink app from the app market. Please make sure you download the latest version or else the system will ask you to update to the latest version.



iOS QR



Android QR

3. Registration and login "eWeLink" user account :

1. Open "eWeLink" app on user's phone, register new account step by step for the first time use with user's phone number or email address. Please note that password should not less than 8 digital numbers.
2. After successful registration, the user need to login with user's own registered phone number or email and password. The app will not close until user logout, once its logged out the user has to login again.

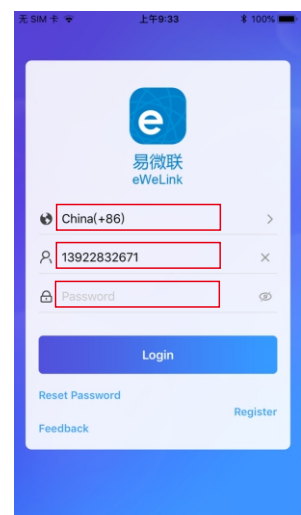

4. Pair the door access controller with the cell phone WiFi

First, user needs to press *888888#60 to enter the setting mode.

Open eWeLink App, click the "add" button to begin pairing your device. Then press on the device lock icon and hold more than 5 seconds, the green LED on top left corner will flash quickly. On eWeLink App press the "quick pairing Mode" next step, when successfully paired, the green LED on top left corner normally on. Let's take iPhone for example, see below detailed instruction:

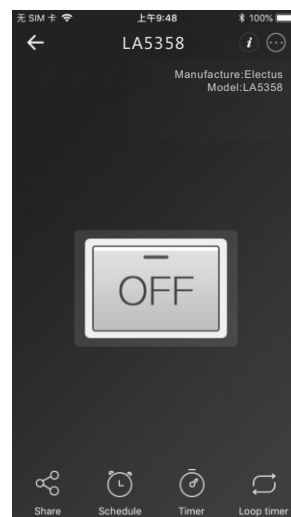
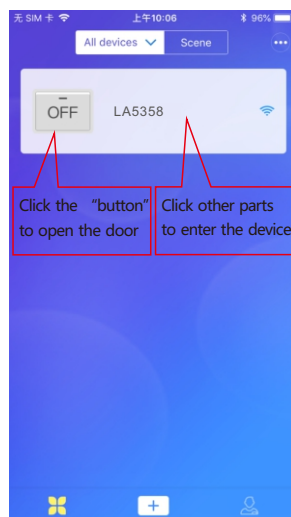
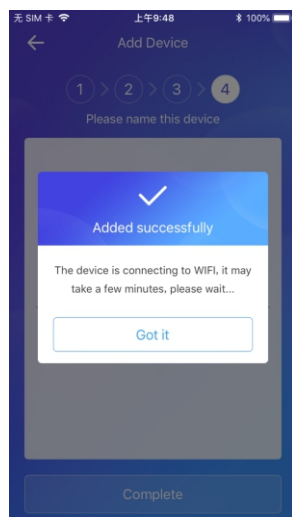
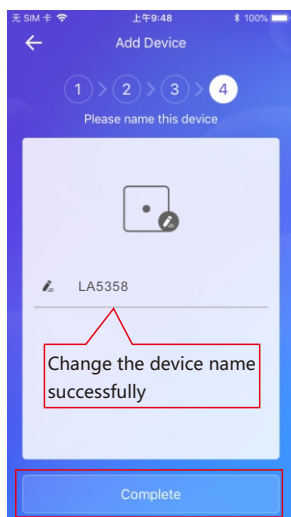
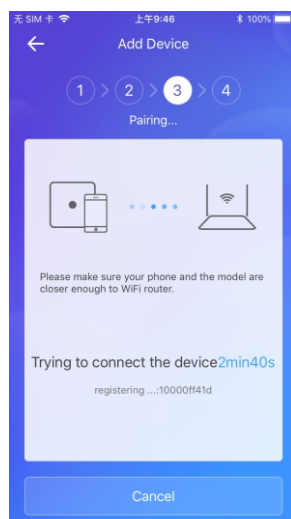
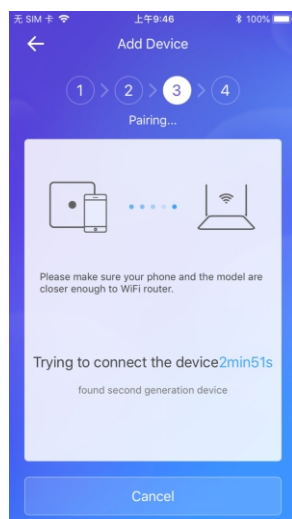
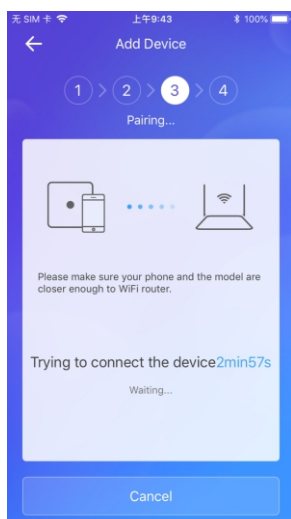
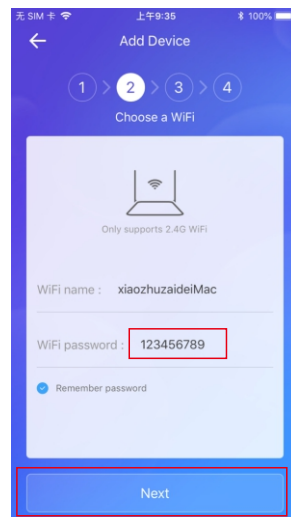
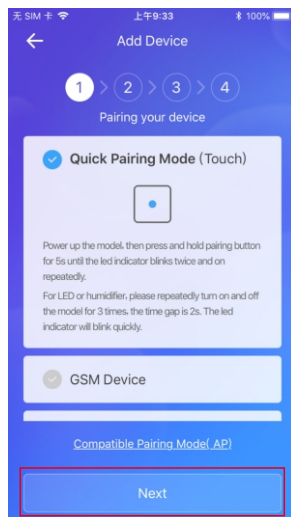
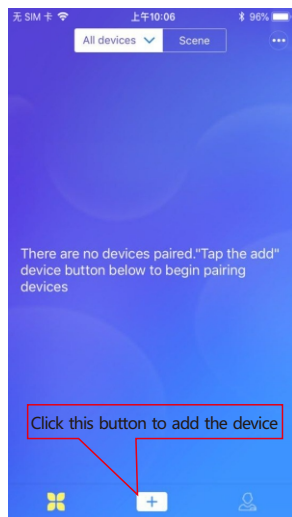

5. How to Open & How to Share

1. Click ON/OFF to open the door
2. Share function, the main account is the first account added the device, you can share the operation authorization to friends, and achieve multi-person joint control. The shared account must keep online. The steps are as follows:
3. Both the main account and the shared account can delete the device at any time, and there is no need for the other party online.

1. Enter into the main operation interface

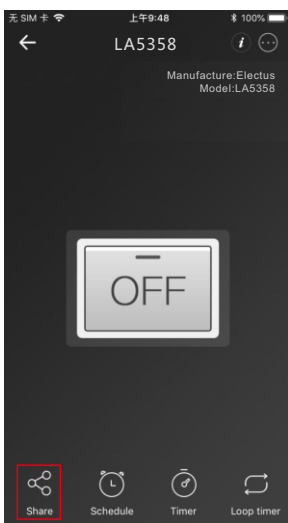

2. Enter into the sharing interface

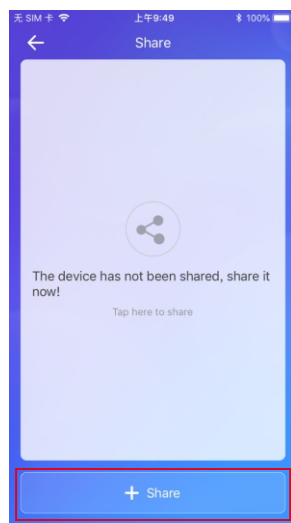

3. Input your sharing information

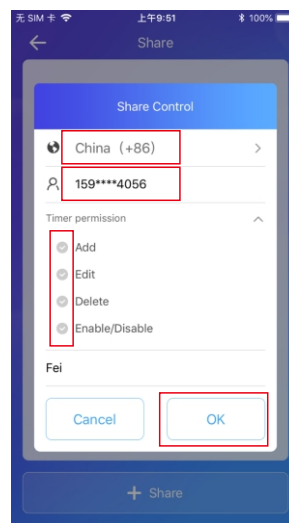

4. Wait for response information

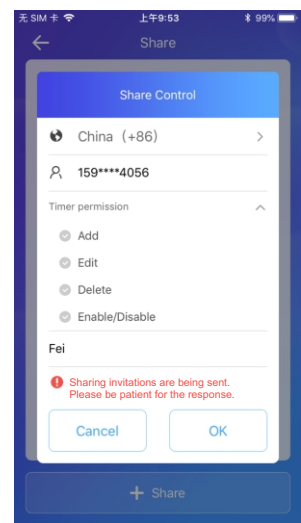

5. Sharing successful

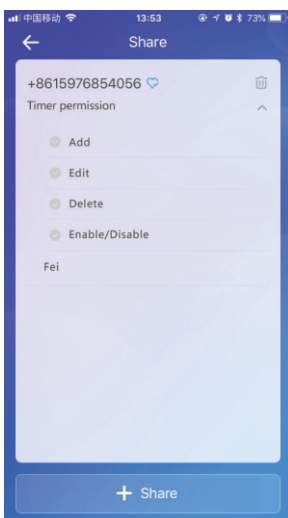

6. Delete the sharing device

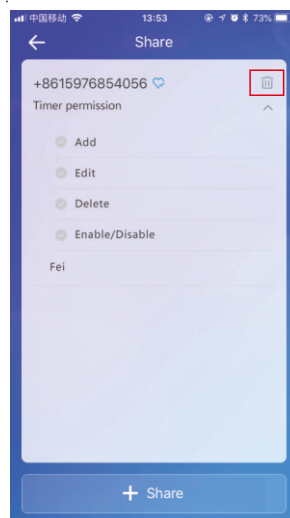

6. Naming , deleting and viewing the operation records

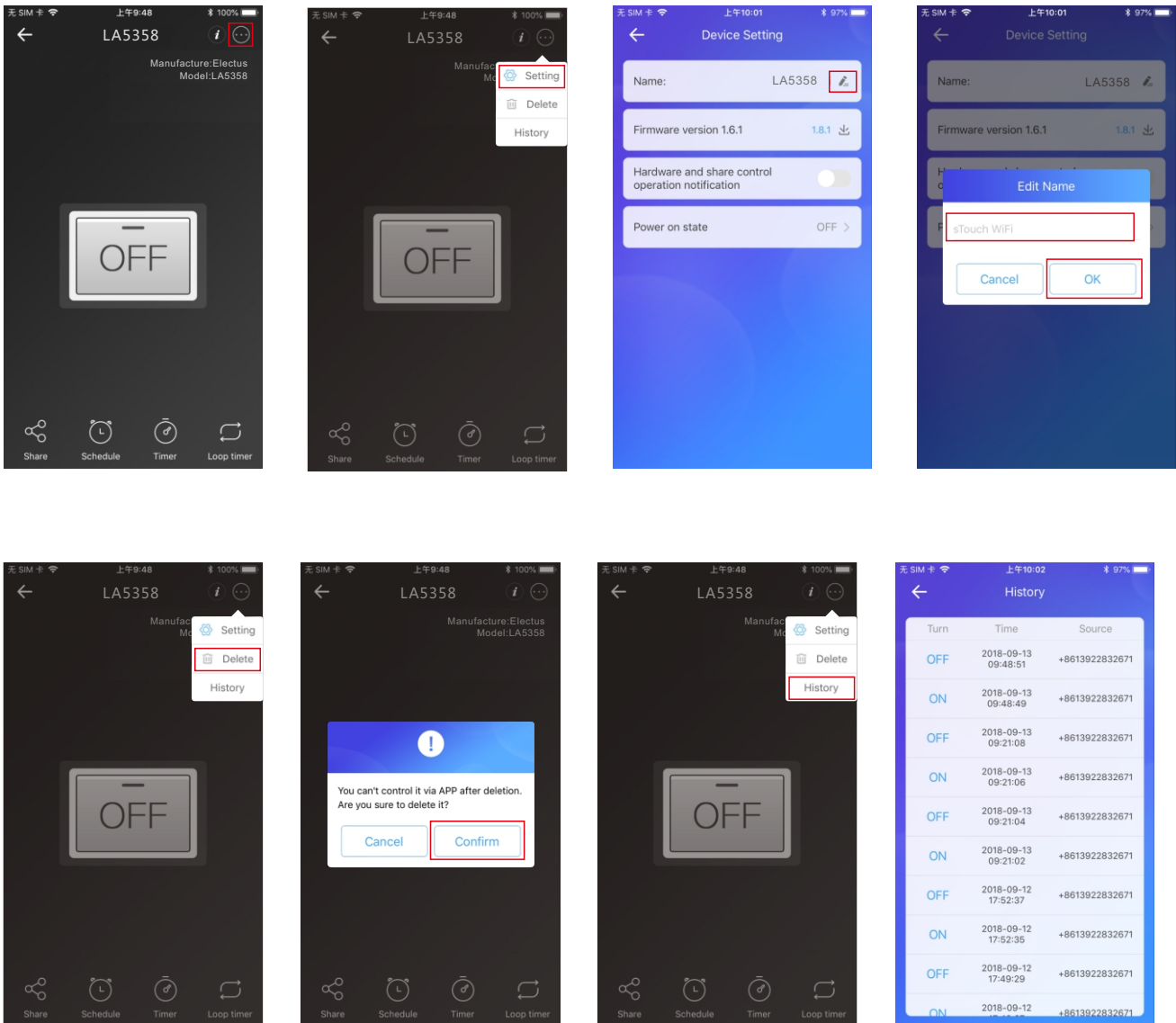

7. Open and close at scheduled time

it can set up to 8 groups of opening and closing time on the APP, to achieve opening and closing the door at scheduled time every day. such as opens at 9:00 a.m. and closes at 17:00 p.m. from every Monday to Friday, let' s set two timing times, The steps are as follows:

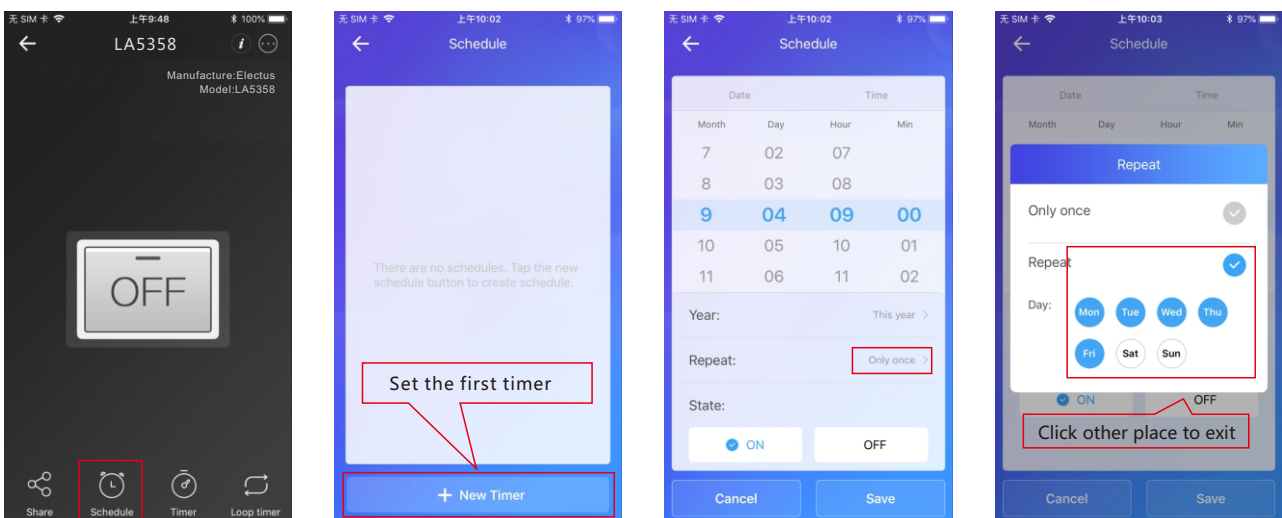

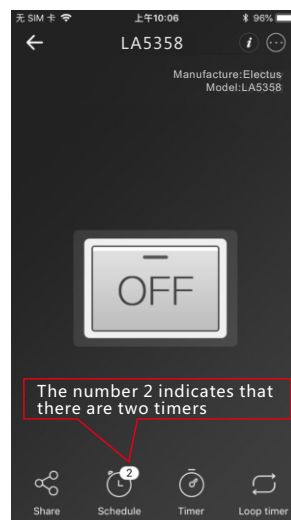
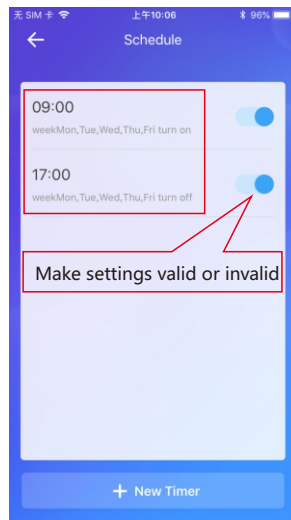
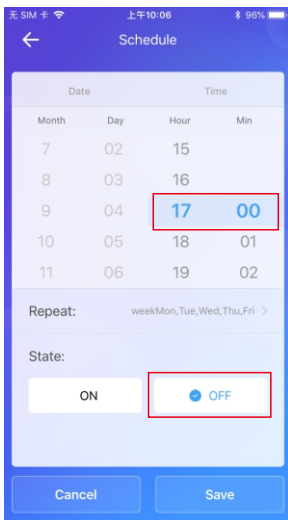
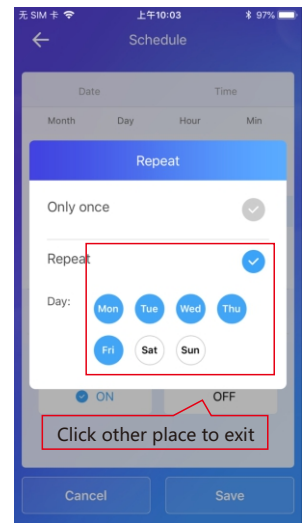
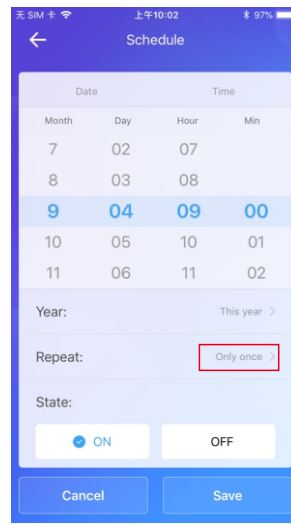
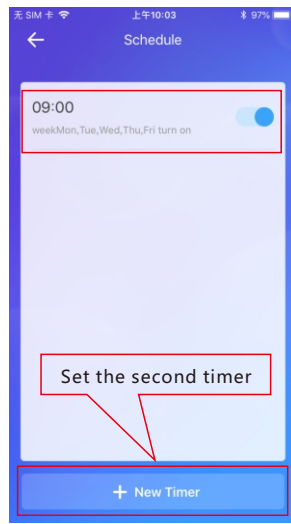
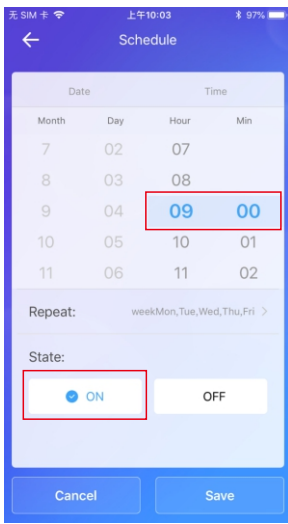

8. Language select, password change, vibration switch setting

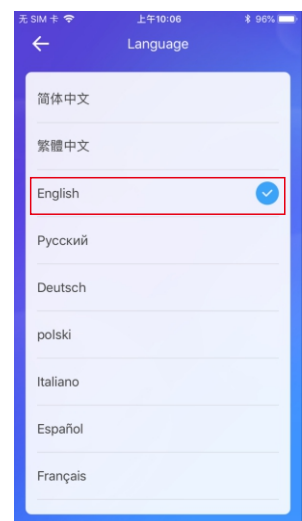
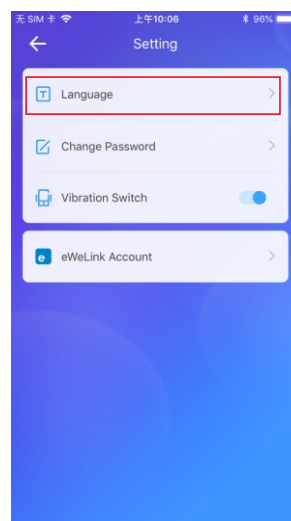
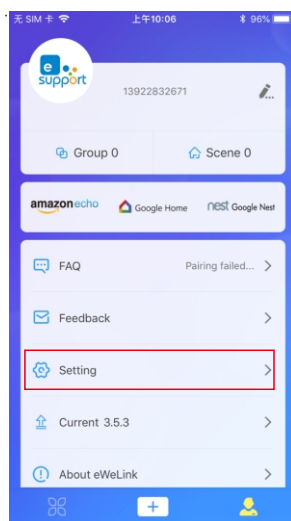
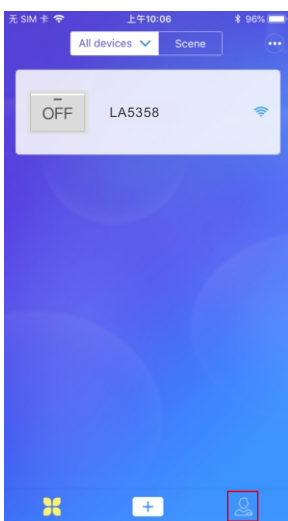

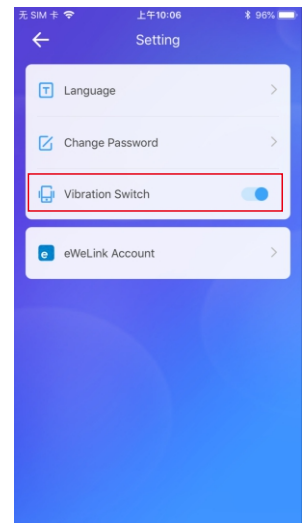
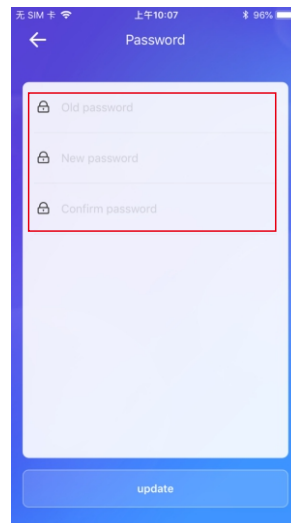
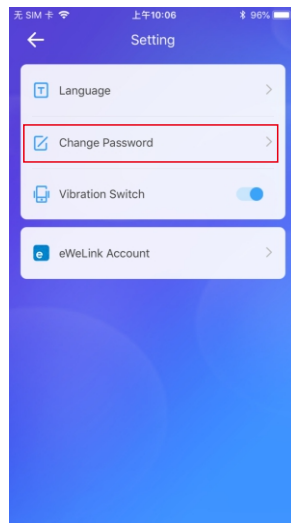

9. FAQ & Solutions

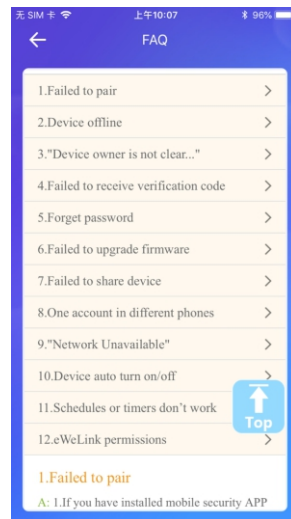
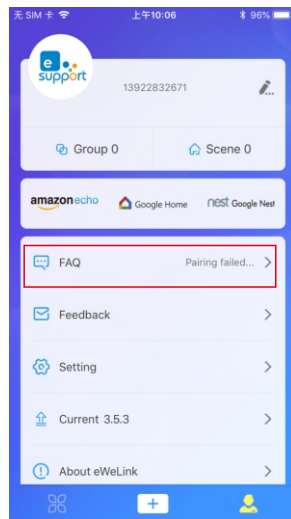
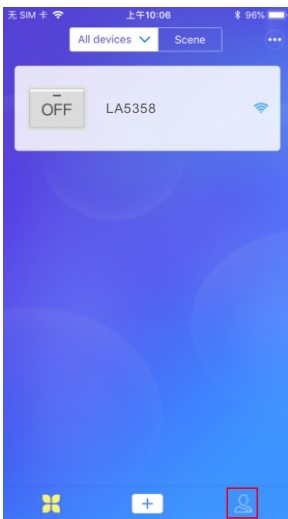

10. Delete the device

Every controller only can have one admin phone with one device; the admin device can share the device to other devices. If the user wants to set other phone as admin device, the existing admin device must delete from the first paired phone.

11. Voice control

This product supports third-party voice control such as ALEXA to open the door. For details, please refer to the description of eWeLink official website.