

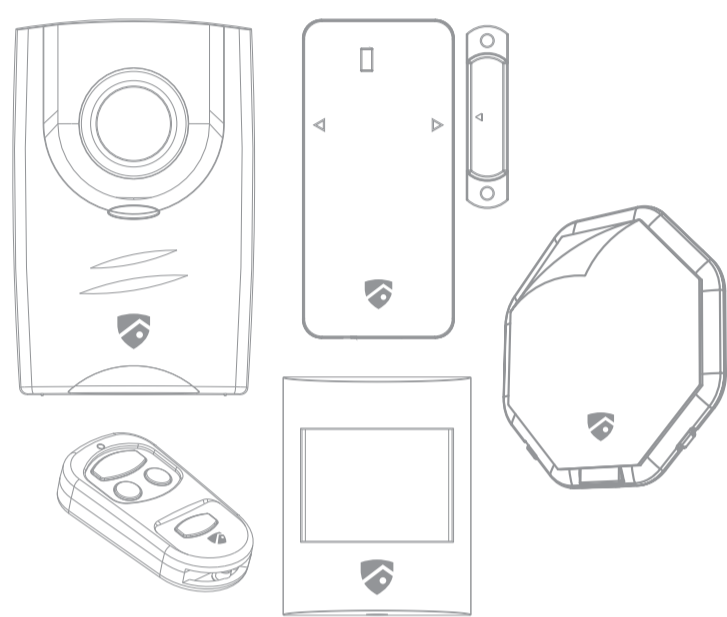

WS-950X USER MANUAL



Please read this user manual carefully before using the Red Shield products.

Please kindly keep this user manual for your reference when necessary.

Visit us at www.redshieldsecurity.com

Section 1 - Getting Started

1.1 Introduction to the system

The Genie Wireless Security System is a high quality home alarm system that allows users to tailor a customized security arrangement. Sensors are all pre-set and connected to the main siren. Once the sensor detects an unauthorized entry, the main siren will activate an extremely loud 120db siren and flashing the red light. The user can control the system by using the remote control to arm or disarm the system.

1.2 Package List

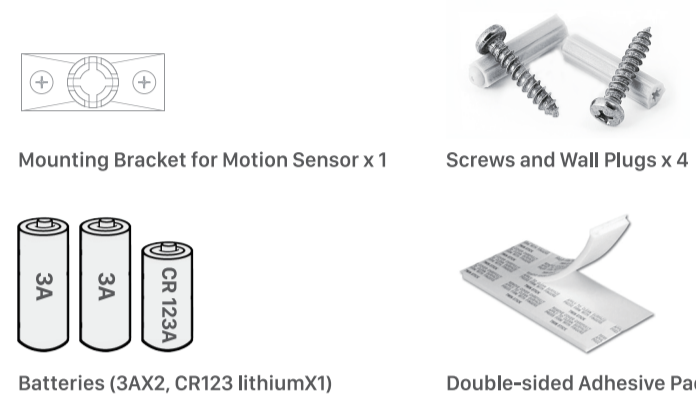
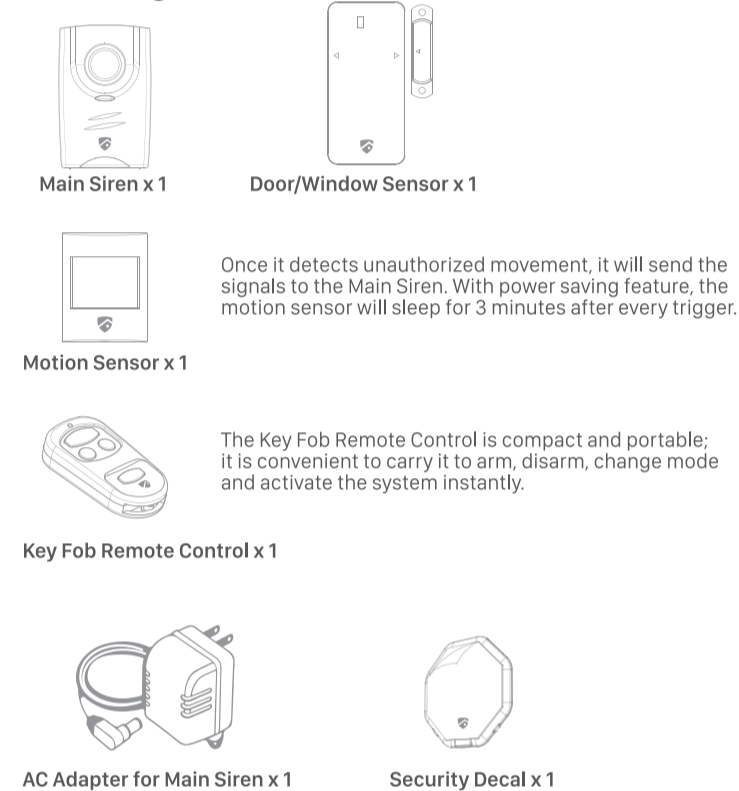

1.3 Main Siren Layout

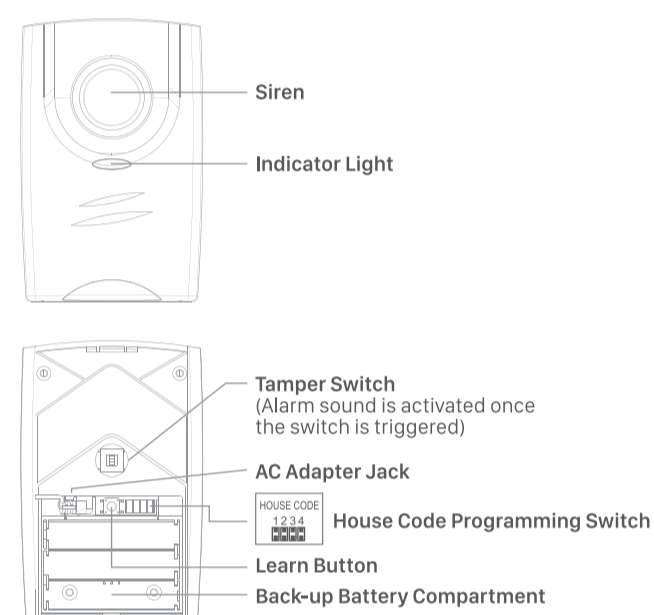

1.4 Introduction to the Main Siren Sound Alert and Light Indication

Operation Mode	Situation	Sound alert and light indication
ARM MODE	Sensor triggered	Exit delay: 15s Entry delay: 10s Alarm duration: 3 minutes Indicator light flashes red Note: The alarm siren will sound for 3 minutes once sensors be triggered again until the system is disarmed.
HOME MODE	Sensor triggered	Exit delay: 15s Entry delay: 0s Alarm duration: 3 minutes Indicator light flashes red Note: The alarm siren will sound for 3 minutes once sensors be triggered again until the system is disarmed.
STANDBY MODE	Sensor triggered	Silent and no indicator light

Section 2 - Installation of the Main Siren

2.1 Installing the Main Siren

WARNING: The Main Siren has a built-in tamperproof switch to prevent the system being disabled by an intruder. When fixing the Main Siren to a wall, first ensure that it is in Standby mode to avoid the alarm sounding.

2.1.1 Locating the Main Siren and Tamperproof Switch

Determine the location of the Main Siren, which should be placed:
- Indoor and accessible to the electronic socket
- away from doors or windows that could be easily accessed by intruders
- away from extreme temperature sources (radiators, ovens, stoves etc.)
- and large metal objects that could interfere with wireless performance

2.1.2 Wall mounting the Main Siren and Tamperproof Switch

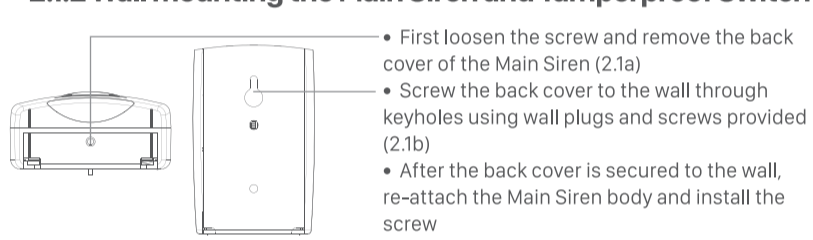

Note: Once the Main Siren has been installed, the system can be powered up. The tamperproof function is enabled once the system is switched to ARM or HOME mode.

2.2 Powering up the Main Siren

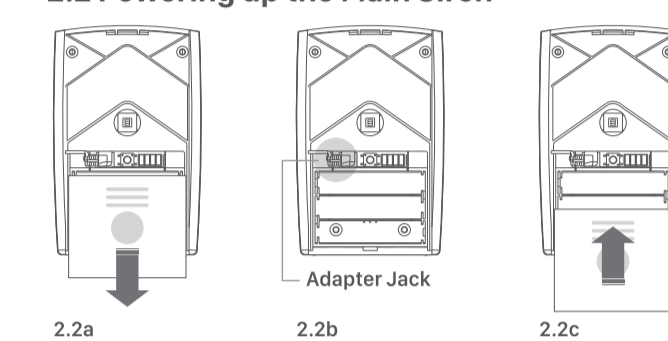

- Slide off the battery compartment cover as shown (2.2a)
- Plug the mains AC adapter plug into the jack within the battery compartment (2.2b)
- Insert three AAA back-up batteries (not included), taking care to follow the polarity diagram inside the battery compartment
- Put the adapter wire out via the groove and replace the battery compartment cover (2.2c). Then connect the AC adapter to a wall socket.

Note: Before replacing the battery compartment cover, it is recommended to enroll the remote control first. (Refer to Part 2.3)

2.3 Enrolling the Remote Control

You will need to enroll the remote control to the main siren first, so that you can control the system.
• First remove the battery insulation tape of the remote control
• Press the LEARN button on the main siren to enter to the enrollment mode, you will hear a Beep
• Press any button on the remote control
• The main siren will beep once to confirm that the remote control is enrolled successfully
• Press LEARN button again to exit enroll mode. You are now able to manage your alarm system via the enrolled remote control. If you would like to enroll more remote controls, repeat the steps above.

Note: Once you enter enroll mode, if there is no operation within 20s, it will exit to this mode automatically.

2.4 Power for the Main Siren

The adapter must be attached to the Main Siren for the operation. The batteries will be acted as back up and cannot be last long. When the batteries in the Main Siren are running out, the indicator light in front of the Main Siren will flash slowly.

Note: Please insert the adapter plug to the AC Jack first before installing the batteries.

Section 3 - Sensors and the Remote Control

3.1 Door/Window Sensor

3.1.1 Introduction of Door/Window Sensor

The Door/Window Sensor consists of two parts, a transmitter and a magnet. Install the transmitter to the frame and the magnet to the door or window. When the door/window is opened, sensor will be triggered and transmit a message to the Main Siren.

3.1.2 Powering up the Door/Window Sensor

- Loosen the screw at the bottom and remove the front cover
- Insert 2 AAA batteries provided, noting the correct polarity
- Replace and secure the front cover with screw
- Check the door/window sensor's house code whether it matches the main siren. The default house code is 1-ON 2-ON 3-ON 4-ON.
- Low battery indication: If the batteries need to be replaced, the RED LED on the transmitter will flash slowly. Please change the batteries immediately to ensure the device has enough power to operate.

3.1.3 Mounting the Door/Window Sensor

- First determine the location of the Door/Window Sensor, which should be placed:
- in the most vulnerable rooms or near key entry points
- away from extreme temperature sources (radiators, ovens, stoves etc.) and large metal objects that could interfere with the wireless performance
- Mount the transmitter on a fixed surface such as a door or window frame with double-sided adhesive pad provided
- Peel back the protective film on one side and attach the double-sided adhesive pad to the transmitter
- Peel back the remaining protective film of the double-sided adhesive pad and press the transmitter firmly in place against the mounting surface until firmly attached
- Mount the magnet on a movable surface such as a door or a window
- Repeat the method of mounting the transmitter.

Note: Ensure the triangle marks on the magnet match up to the lines on the left/right side of the transmitter as shown. The transmitter and the magnet must not have a gap of more than 5mm (0.2 inches) apart when installed on the door/window otherwise the sensor will remain in a triggered state.

3.2 Motion Sensor

3.2.1 Introduction of Motion Sensor

The Motion Sensor consists of two parts, including a sensor unit and a mounting bracket. It is designed to trigger the Main Siren when it senses movement in a given area.
Important: The Motion Sensor is designed with a built-in sleep timer to save battery power. In operation mode, the Motion Sensor will sleep for 3 minutes after every trigger. Any movement detected in the sleep period will not be reported.

3.2.2 Powering up the Motion Sensor

- Loosen the screw at the bottom and remove the front cover
- Insert a 3V (CR123A) lithium battery provided, noting the correct polarity
- Replace and secure the front cover with screw
- Check the motion sensor's house code whether it matches the main siren. The default house code is 1-ON 2-ON 3-ON 4-ON.
- You can change the house code by removing the jumper and it will become OFF.
- Low battery indication: If the batteries need to be replaced, the RED LED will flash (not including entry) exit delay flashing).

3.2.3 Mounting the Motion Sensor

- First determine the location of the Motion Sensor, which should be placed:
- In the most vulnerable rooms or near key entry points
- On a solid surface between 1.8m to 2.4m (6ft to 8ft) from the floor
 - Away from extreme temperature sources (radiators, ovens, stoves etc.) and large metal objects that could interfere with the wireless performance
 - Away from direct sunlight
 - Indoors only and not behind partitions
 - Mount the Motion Sensor with screws provided
 - Hold the enclosed mounting template against the wall at the selected location and mark the points for drilling
 - Drill the holes and insert wall plugs
 - Attach the bracket to the mounting surface with the screws provided
 - Attach the Motion Sensor to the mounting bracket
- Note: The distance at which the sensor is able to detect motion can be adjusted by altering the angle of the sensor. Simply move the sensor downward or upward to reduce or expand the range.

3.2.4 Sensor sensitivity

The sensitivity of the Motion Sensor is adjustable and can be changed by setting the connector found in the battery compartment, either "High", "Middle" or "Low". You can perform a "walk test" after each change in sensitivity setting to see if the sensor is triggered correctly.
When the sensitivity is set to "Low", more movement is required to trigger the sensor. It is recommended to set the sensitivity to "Low" and perform a "Walk Test". According to the result of walk test, adjust the sensitivity as required. It is suggested that walk test be conducted after each change in sensitivity setting.

After it has been mounted at the desired location and powered up, the motion sensor will go into a TEST Mode which will last for 10 minutes. This allows you to check whether the sensor is detecting the correct area. You should walk in the area where the motion sensor is expected to monitor. When movement is detected, the red light inside the unit will appear. If the sensor doesn't detect movement within desired area, adjust the mounting angle accordingly and test again. Repeat this procedure until motion is detected. After 10 minutes, TEST Mode will end.

Tips: Also perform the walk test in areas which the sensor is not intended to cover, to ensure movement cannot be detected.

3.3 Key Fob Remote Control

The remote can be used to arm, disarm, and activate the siren instantly. It allows user to operate the system remotely, from inside or outside the property.

- ARM: Press to enter ARM mode (under ARM mode, there will be 15s for exit delay and 10s for entry delay)
- HOME: Press to activate HOME mode (under HOME mode, there will be 15s for exit delay and 0s for entry delay)
- ALERT: Press to enter ALERT mode. Under the Alert mode, the main siren have the Ding-Dong sound when the paired sensors are triggered.
- DISARM: Press to disarm the system instantly and the system will return to Standby mode
- PANIC: If (P) and (D) buttons are pressed simultaneously, the main siren will be activated immediately

Note: When you change system mode using the remote control, for example from ARM mode to Home mode or reverse, the Main Siren will BEEP twice to indicate successful change.

3.3.2 Deleting a Key Fob Remote Control

If a Remote Control device is damaged or lost, it can be deleted from the system as follow:
• Loosen the screw and remove the back cover of the Main Siren. And then open the battery compartment cover.
• First, press and hold the LEARN button of the Main Siren. There is a BEEP sound.
• Continue to hold this button for about 5 seconds, you will hear another BEEP sound. Please hold it for 4 more seconds, you will hear one more BEEP sound. It takes 9 seconds to complete this process and you have deleted all the enrolled keyfob remotes successfully.

Note: If you need to add a new remote control, please refer to Part 2.3

Section 4 - Using the Genie Wireless Security System 4.1 Operating Different Modes

After installation, the system is ready for use. There are three modes of the system including ARM mode, HOME mode and Standby mode as well as a panic function. Simply use the key fob remote control to toggle between three modes and activate the alarm.

- ARM mode: under ARM mode, there will be 15s for exit delay and 10s for entry delay
- HOME mode: under HOME mode, there will be 15s for exit delay and 0s for entry delay
- STANDBY mode (DISARM): the system will be in standby mode and ready to switch mode
- Panic function: manually activate the alarm immediately

Note: The Exit/Entry Delay gives you some time before the alarm goes off whenever you leave or return to the house before opening or closing the doors which will trigger the alarm. It depends on the selected mode.

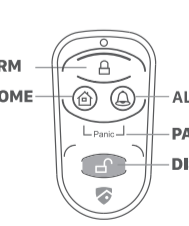
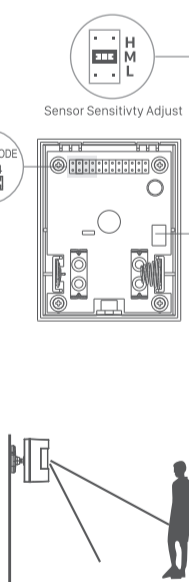

4.2 House Security Code Settings

In most cases the factory settings of the House Security Code will NOT need to be changed. However, if the Main Siren and Sensors activate intermittently or do not work at all, this may be due to interference with other systems, which can be avoided by changing the House Security Code. To change the house security code, take the following steps with each system module:

- There are 4 Jumpers/Dip-switches on each device. To locate these, remove the battery compartment cover.
- Then set the Jumpers as shown below (ON=Push in / OFF=Pull out) to change the House Security code setting. Make sure the Jumpers on the Main Siren and Sensors exactly match each other AND the Dip-switch setting on the Key Fob Remote Control.

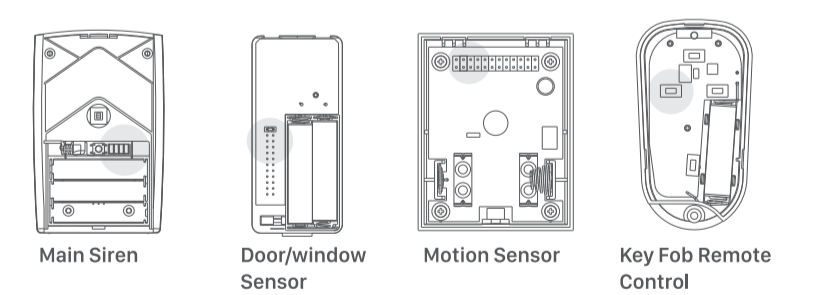

Jumpers for House Security Code	HOUSE CODE	Main Siren
	4 3 2 1	Each sensor
	4 3 2 1	Default House Security Code:
	1: ON, 2: ON, 3: ON, 4: ON	1: ON, 2: ON, 3: ON, 4: ON
	1: ON, 2: ON, 3: ON, 4: ON	* Jumper: ON = Pushed In, OFF = Pulled out
Dip-Switches for House Security Code		Key Fob Remote Control
	4 3 2 1	Default House Security Code:
	1: ON, 2: ON, 3: ON, 4: ON	1: ON, 2: ON, 3: ON, 4: ON

Section 5 - General Information

5.1 Maintenance

The product may be cleaned with a soft damp cloth and then wiped dry. Do not use abrasive, solvent based or aerosol cleaners as this may damage and/or discolor the product. Do not allow water to enter or attempt to clean the inside of the unit.

Regular maintenance and inspection is recommended. In order to ensure that all components are at optimal performance please test all components on a regular basis and replace batteries at suitable intervals.

Tips: When you try to remove the Main Siren for maintenance, it is important to disable the tamper protection. Ensure the system is in Standby mode to avoid the Main Siren sounding an alarm.

5.2 Batteries

- Do not allow the battery to corrode or leak as this may cause permanent damage to the product.
- Take care to insert the battery with the correct polarity as shown inside the battery compartments. Do not use rechargeable battery.
- Dispose of used batteries according to local laws and regulations. DO NOT BURN.

5.3 Q & A

Q: How many sensors can the Genie Wireless Security System support?
A: 128 sensors can be enrolled with the Main Siren.

Q: What is the wireless range? What about walls and other signal obstructions?
A: In an open space the range is 100 meters. We suggest you test the system before fixing them so that the optimal location can be established.

Q: Do I need to program the Main Siren?
A: The default settings should be sufficient. The only reason you may need to change the house code settings is if you find there are some false trigger. You need to change to the same house code for sensors.

Q: Can the system be dismantled and redeployed?
A: Red Shield Alarm systems are designed to be easily installed, dismantled and relocated.

Q: What if I lose my remote control?
A: You can press and hold the "Learn" button on the Main Siren for five seconds. This will reset the Main Siren to the factory default and all the remote control will be deleted. You will have to enroll a new remote control again.

Q: Why is my motion sensor without any response after the trigger?
A: The motion sensor is designed to go inactive for 3 minutes after a single incidence of detection. After 3 minutes, the motion detector will be able to function normally.

Q: Why does my motion sensor generate false alarms?
A: Pets may trigger the sensor. The sensitivity of the Motion Sensor can be adjusted by placing a connector in the L, M or H positions within the battery compartment.

Q: Can the signal be jammed or disrupted?
A: Red Shield products use a specific radio frequency so it is unlikely that there will be any disruption to its operation.

• If you have a question not found in this FAQ, please contact us at customer@redshieldsecurity.com

5.4 Red Shield Accessories

The Genie Wireless Security System can easily be expanded by addition of extra sensor components, other types of sensors as well as relocation according to your needs. You can customize the System with additional Red Shield sensors & accessories which are available on our website www.redshieldsecurity.com

5.5 Disclaimer

- Even the most advanced alarm systems cannot guarantee 100% protection against burglary or environmental problems. All alarm systems are subject to possible compromise or failure-to-warn for a variety of reasons.
- Inadequate maintenance is the most common cause of alarm failure; therefore, test your system at least once per week to make sure the sensors and sirens are working properly.
- Although having an alarm system may make you eligible for reduced insurance premiums, the system is no substitute for insurance.

5.6 Contact Details

Red Shield Security Ltd.
21/F Fun Tower, 35 Hung To Road, Kwun Tong, Kowloon, Hong Kong
Email: customer@redshieldsecurity.com