

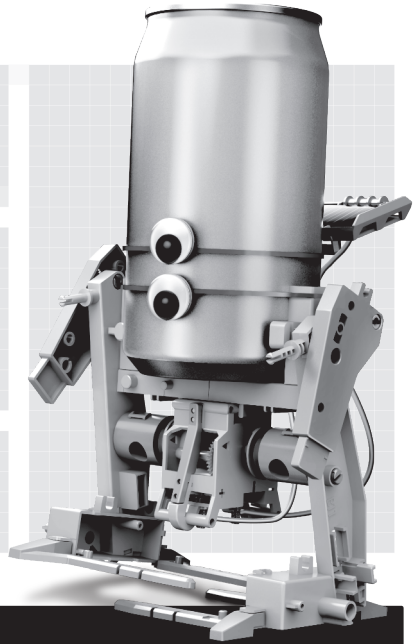

Green Energy

SUPER SOLAR RECYCLER

Assembly & Instruction Manual

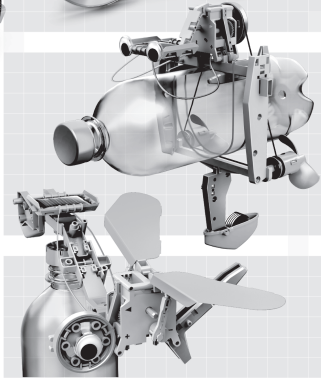
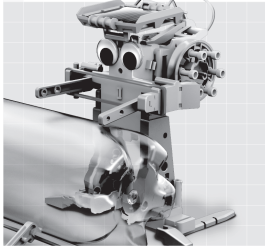
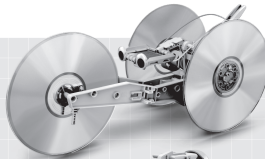
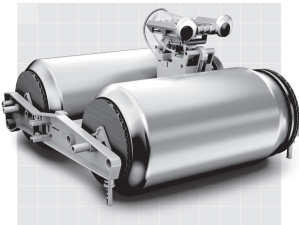

Product Introduction

Think twice before discarding that 1985 CD-ROM, don't throw away that aluminum can, and pick up that plastic bottle left under the couch. We can use them with our state-of-the-art, eco-friendly educational toy kit that will stretch your child's imagination while allowing them to take part in the joy of recycling. The Super Solar Recycler Kit is powered completely by natural light so you never have to worry about batteries!

In addition to your newly discovered treasures, all you need to get started is included in this kit (solar panel, motor and instruction). Your children can recycle a can of their favorite soft drink to create Street Roller and Walking Robot, create Bottle Yacht, Drummer Robot and Flying Bird using a plastic water bottle, and even turn your old scratched CD's into the super cool CD Racer.

Let's have our children play in an eco-friendly way, and learn to harness a new green solar energy source as well as implement the use of recycled materials. We invite you to participate in the creation of a sustainable future.

Tools You May Need

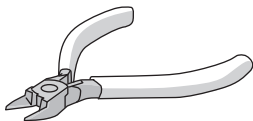

Diagonal Cutter



Scissors

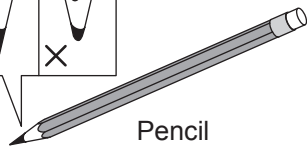
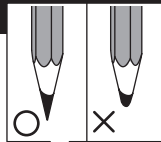

Pencil

Recycled Parts Required

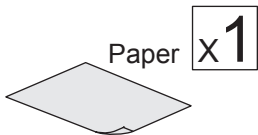

Paper X1

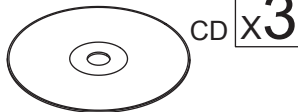

CD X3



Plastic Bottle
500~600 ml
(Tube Body) X1

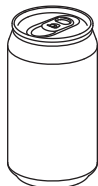

Soda Can
330~355ml
X3

! Same size is required

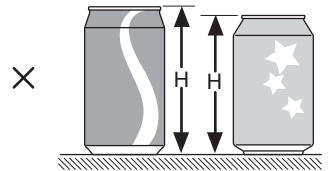
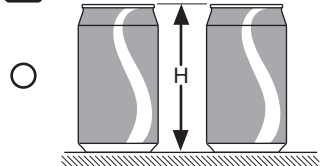

Mechanical Parts List

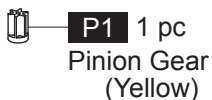

P1 1 pc
Pinion Gear
(Yellow)



P2 1 pc
Gear With Shaft
(Green)

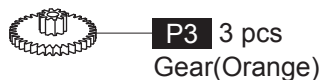

P3 3 pcs
Gear(Orange)



P4 2 pcs
Round Shaft

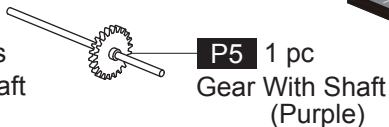

P5 1 pc
Gear With Shaft
(Purple)

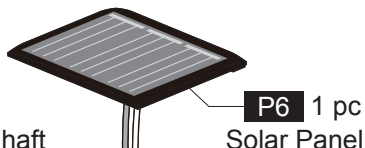

P6 1 pc
Solar Panel

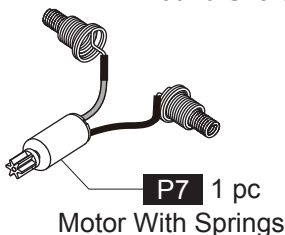

P7 1 pc
Motor With Springs

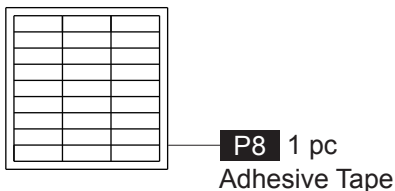

P8 1 pc
Adhesive Tape

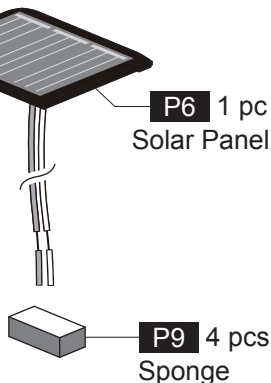

P9 4 pcs
Sponge



Don't connect the wires to the mains.
Product contains functional edges and sharp points.

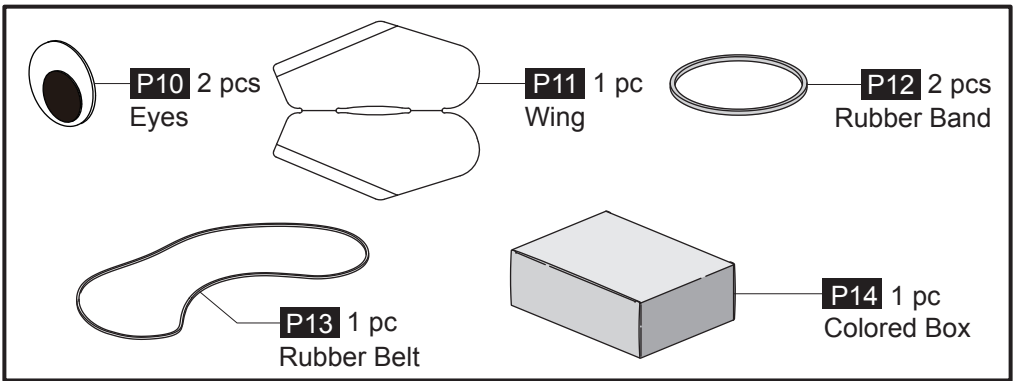

Plastic Parts

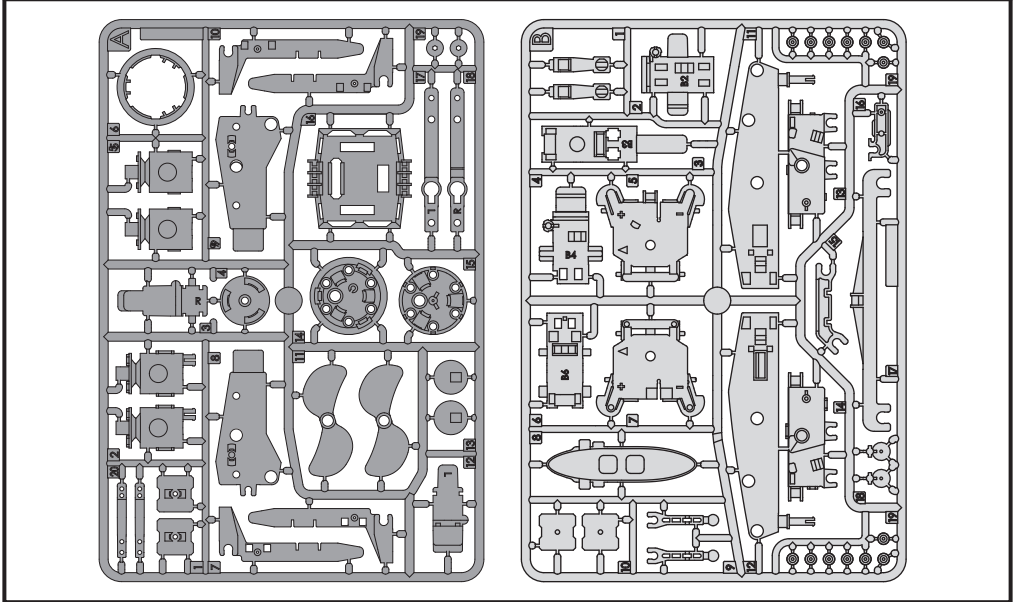

Hints

Cut off the burrs before assembly.

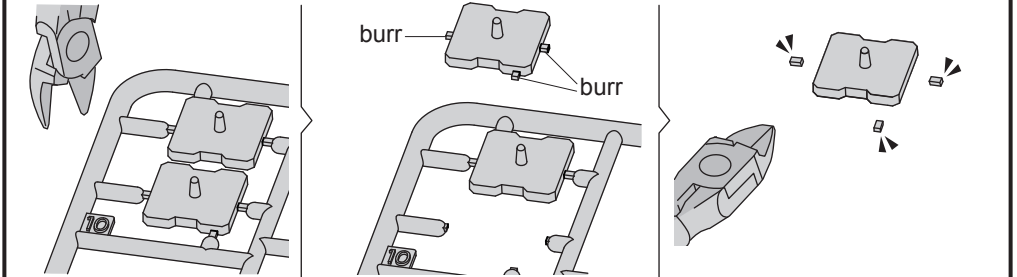

1

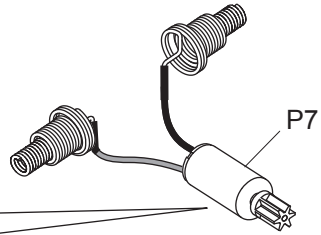
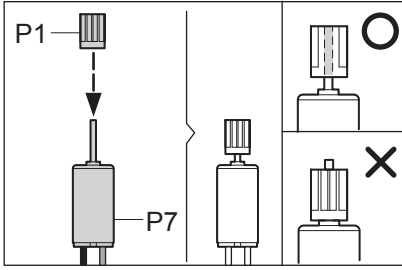

2

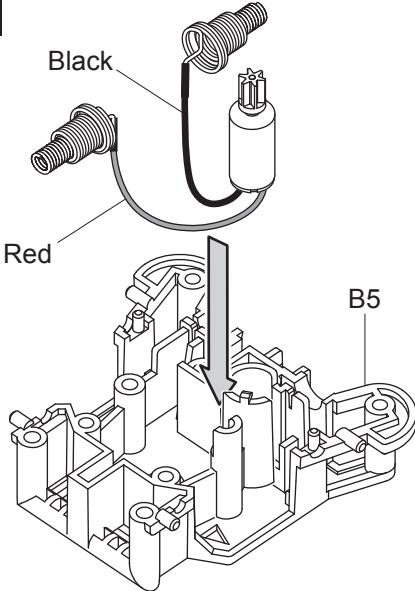

3

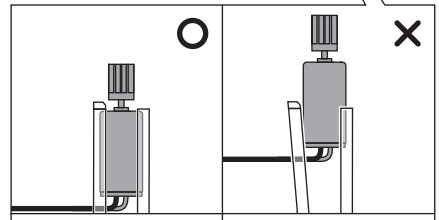
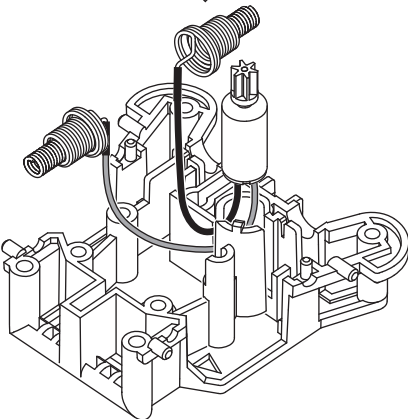
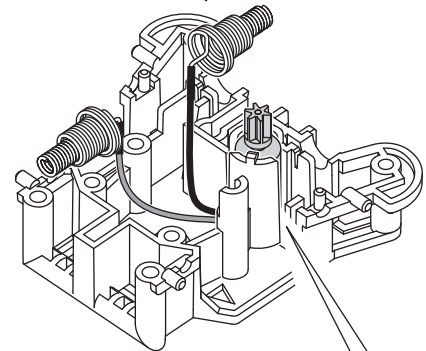
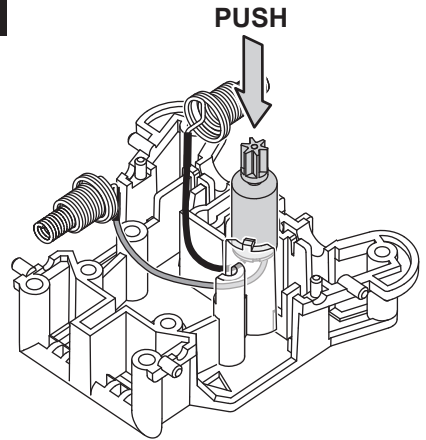

4



Black

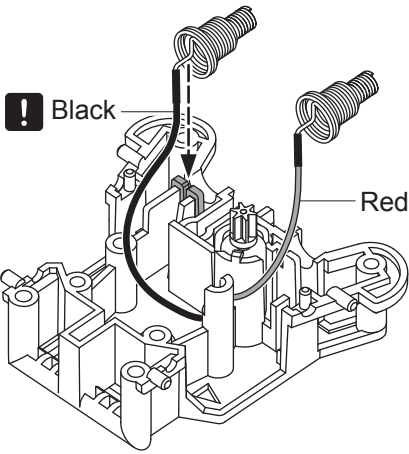

Red

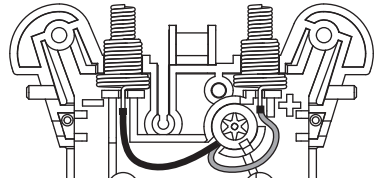
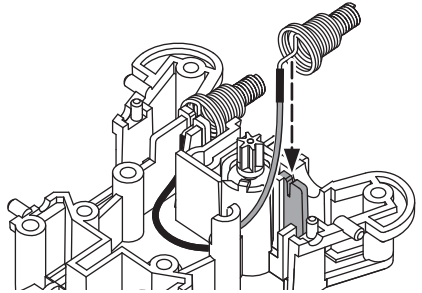

Top View

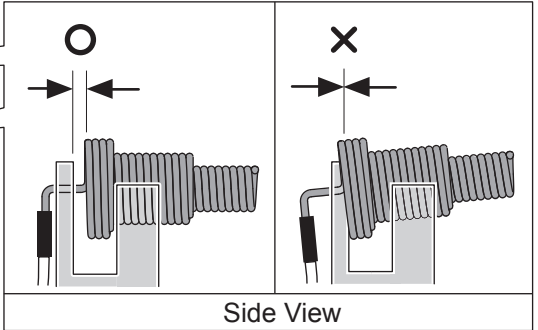
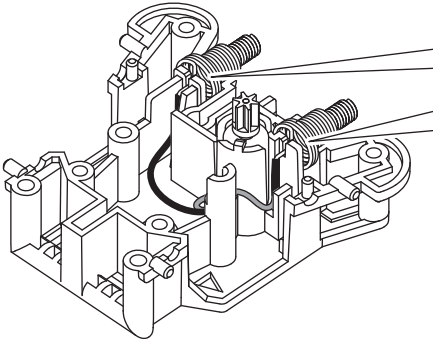

Side View

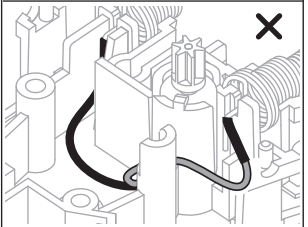
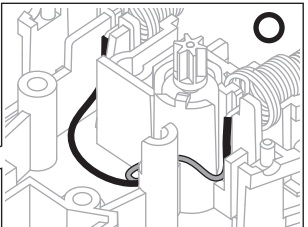
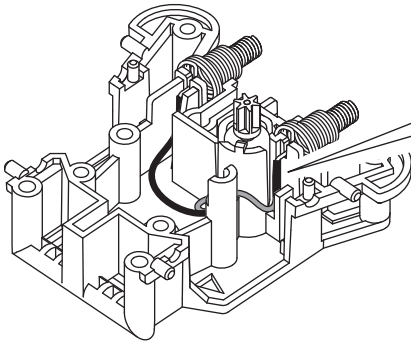

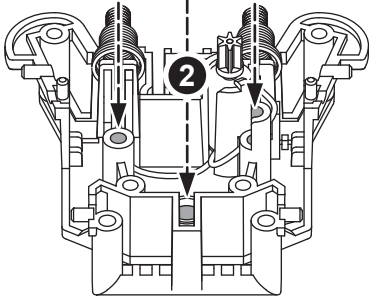
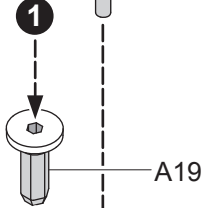
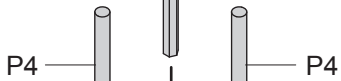
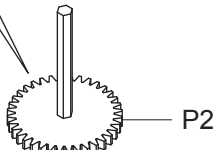
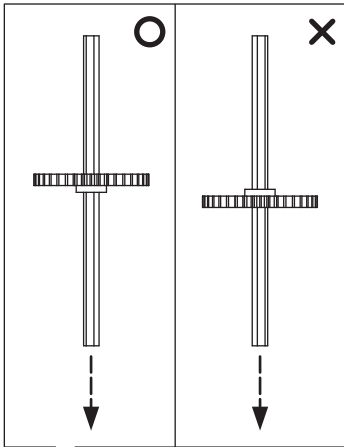
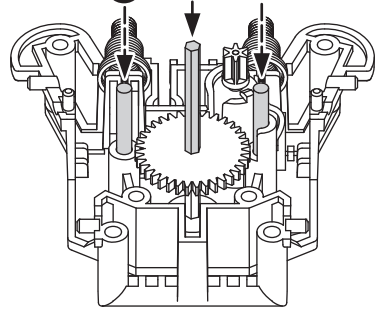
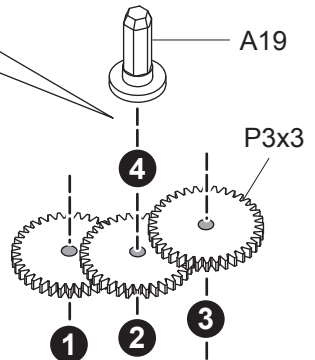
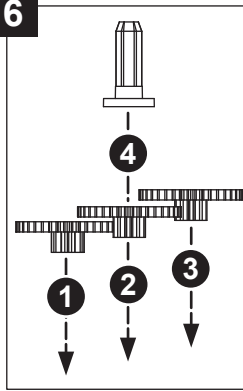
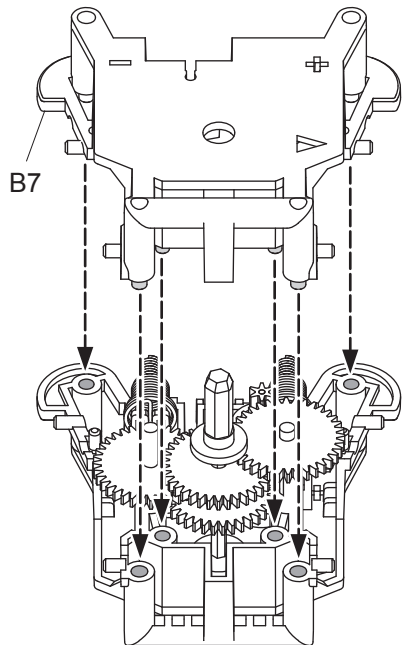
5**6****7**

8

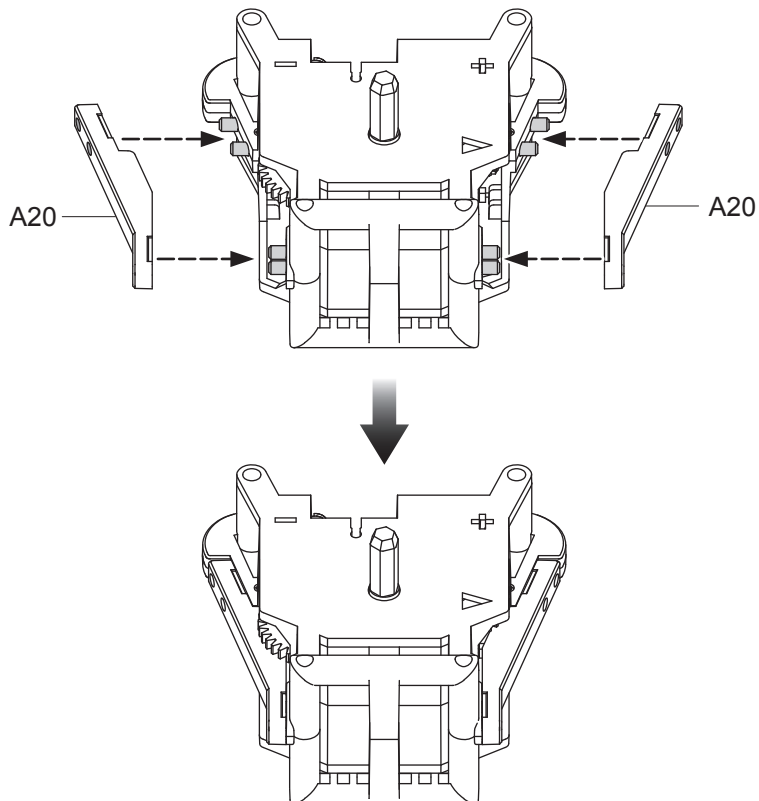

9 Completed

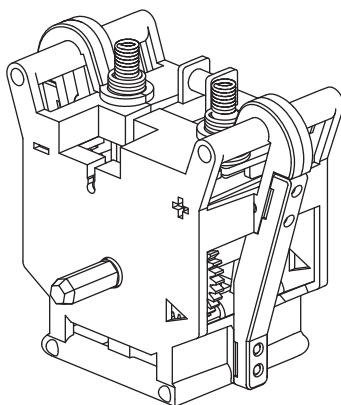

Solar Module

Assembly

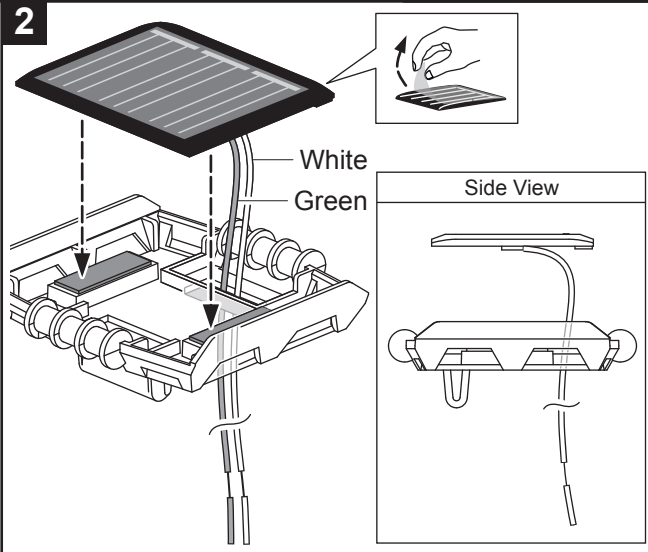
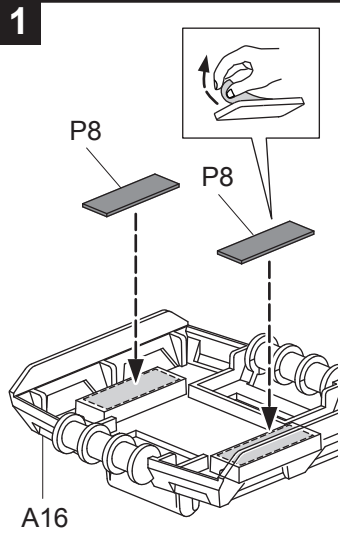

3 Completed

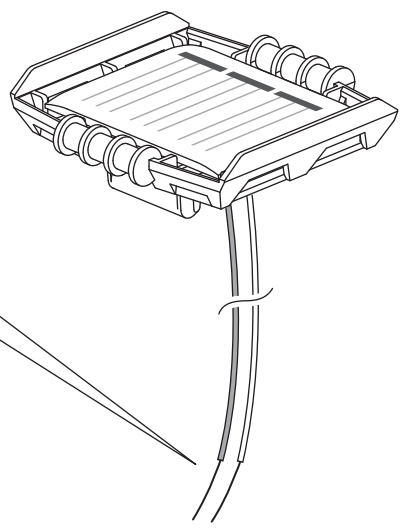
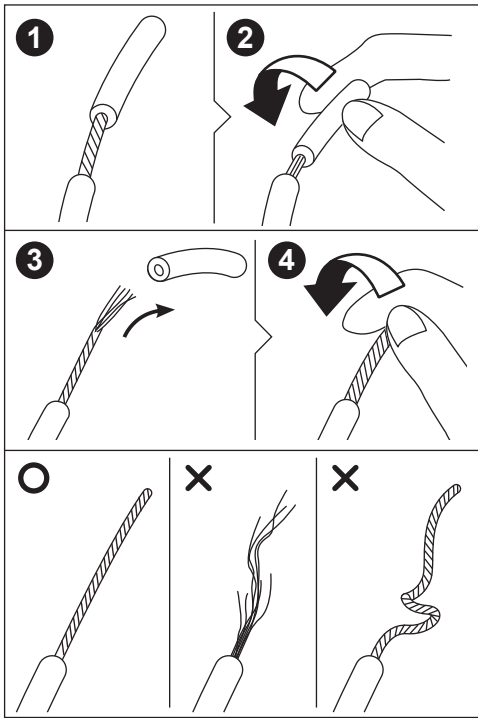

How To Work The Gear Box

1  Notice: Find and make sure correct direction of "◁" on gearbox first, it would help you to install the parts correctly.

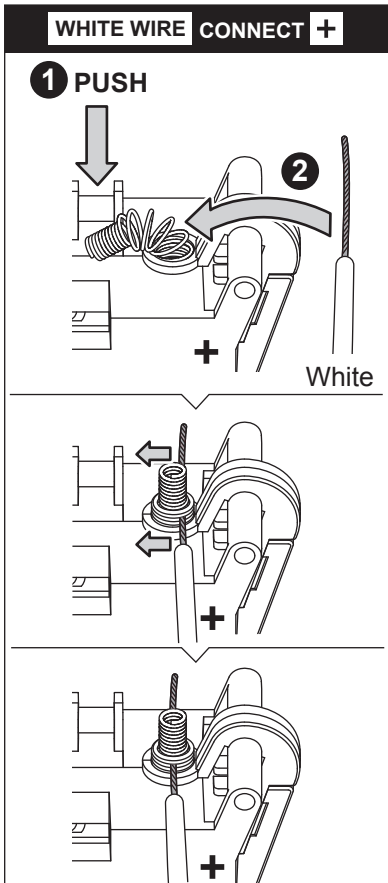
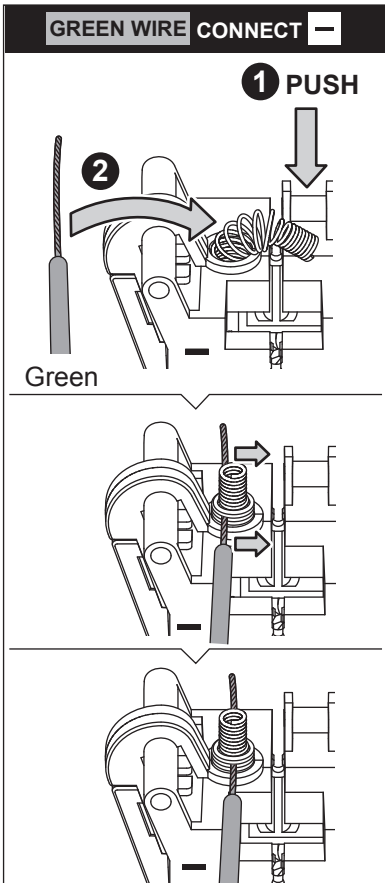
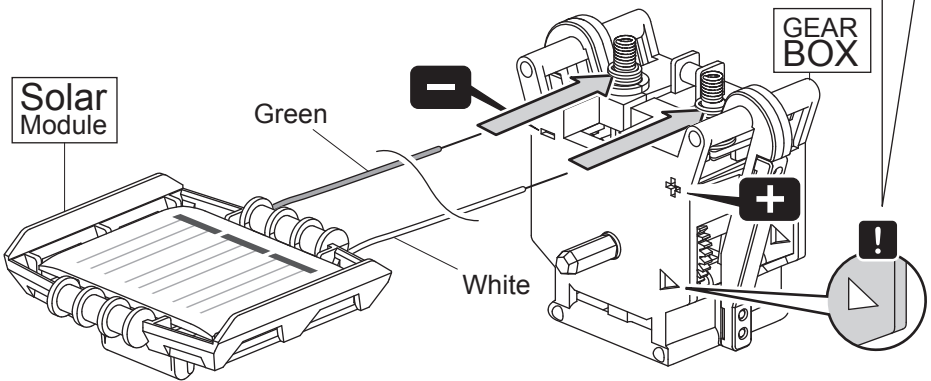

2 Completed

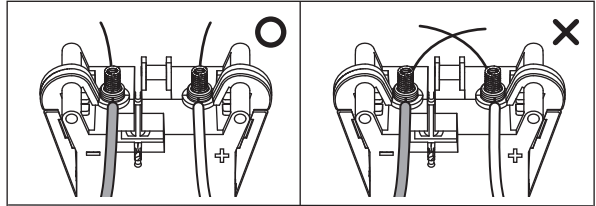
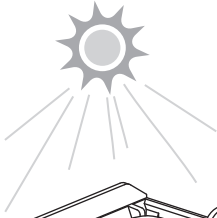

! Wires should not touch each other.

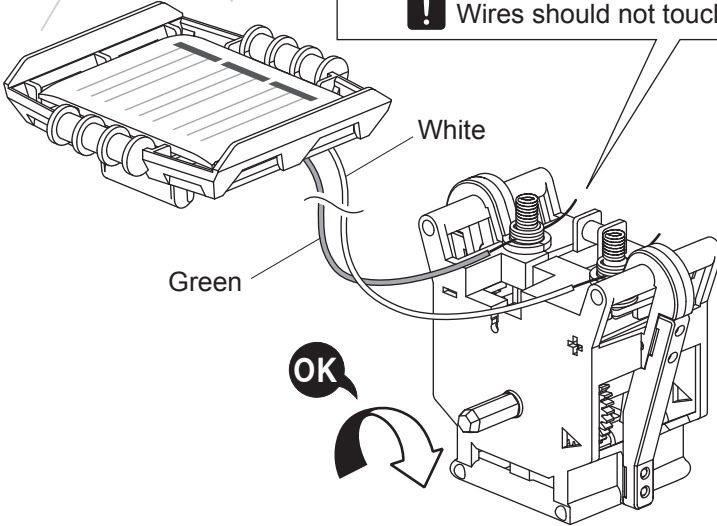

White

Green

OK

CD Racer

Assembly & Play

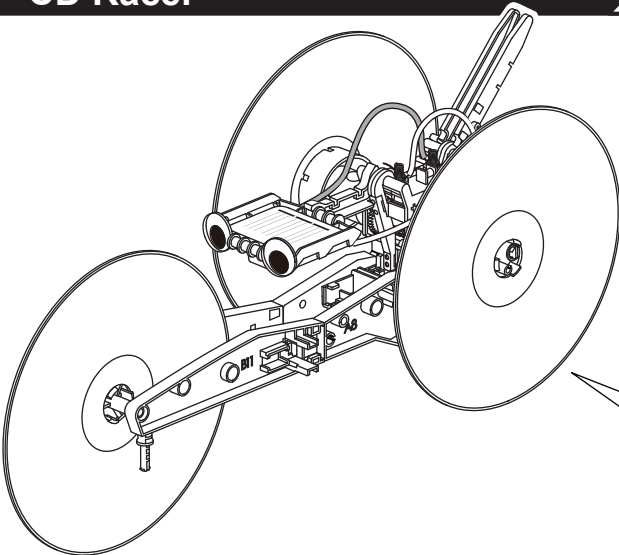

Recycled Parts Required

CD

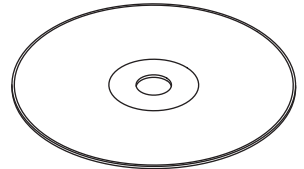

x3

1

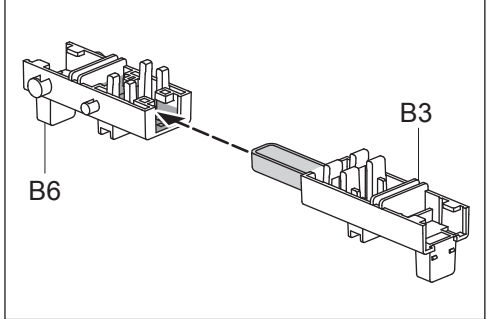
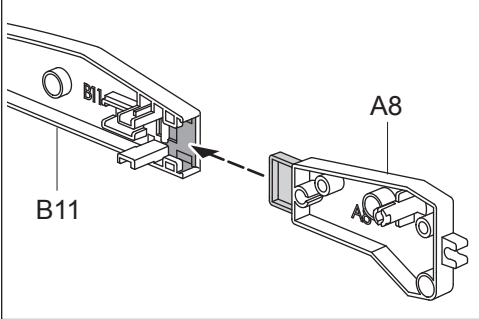
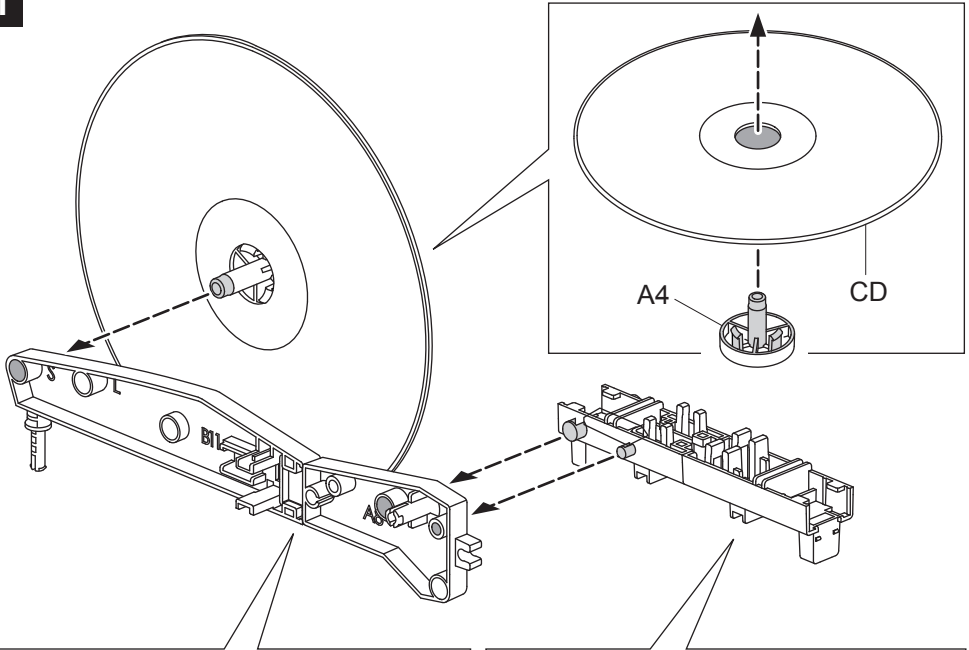

2

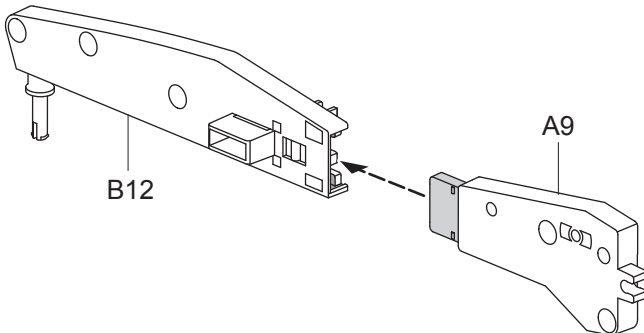

3

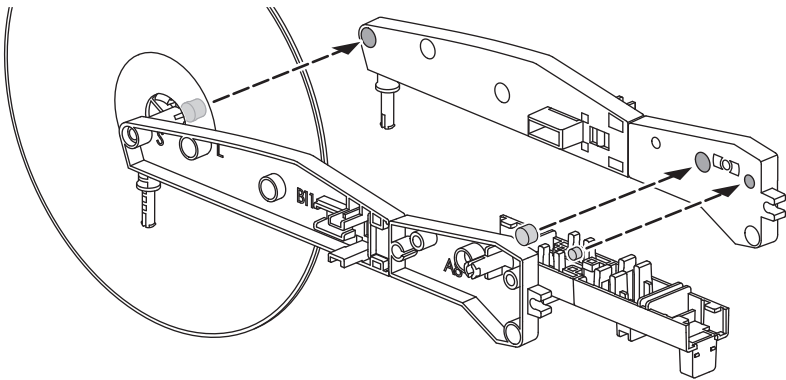

Part

1

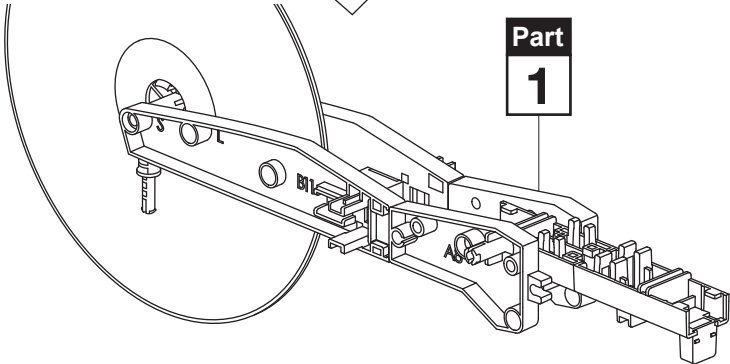

4

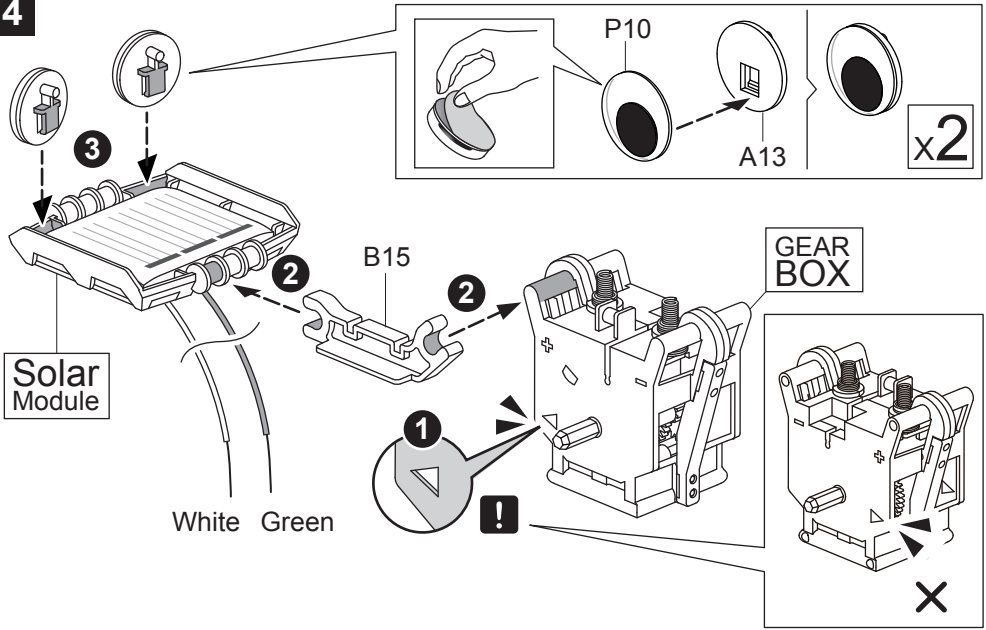

5

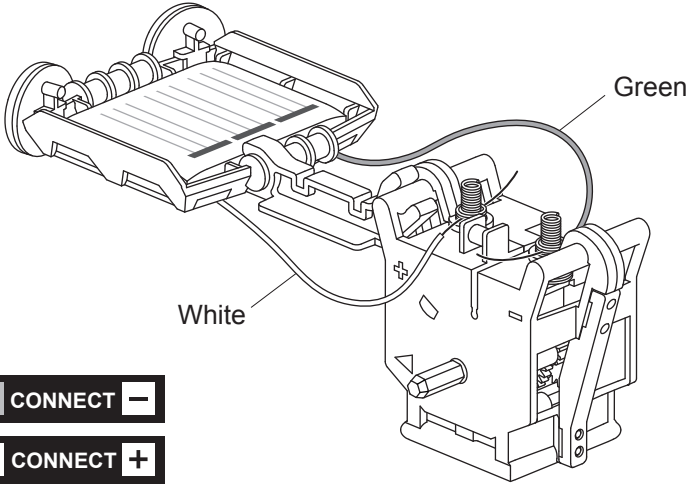

6

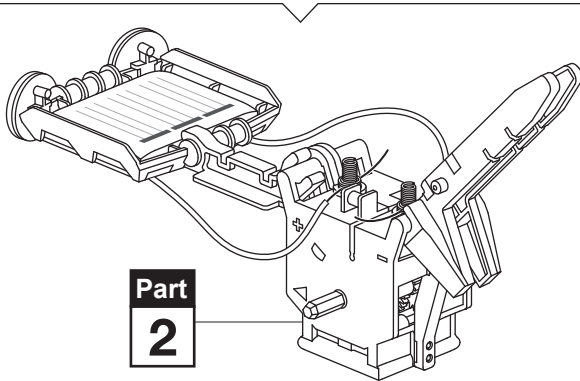
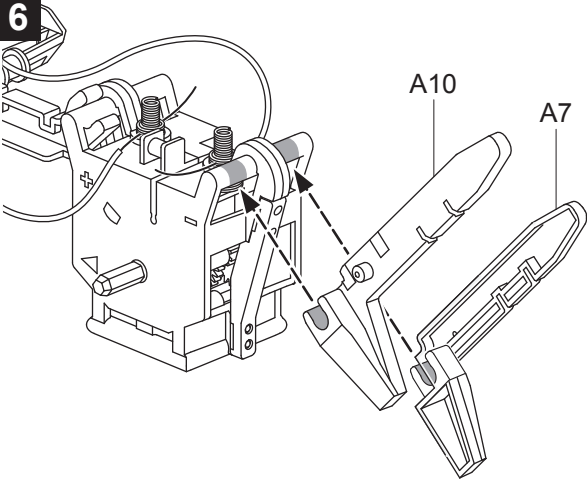

7

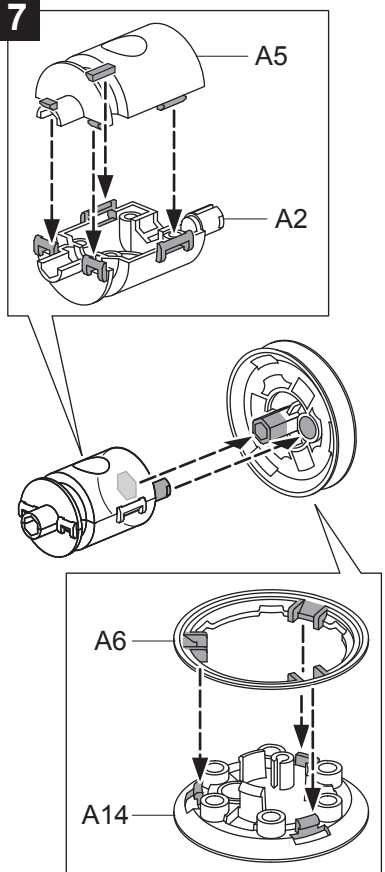

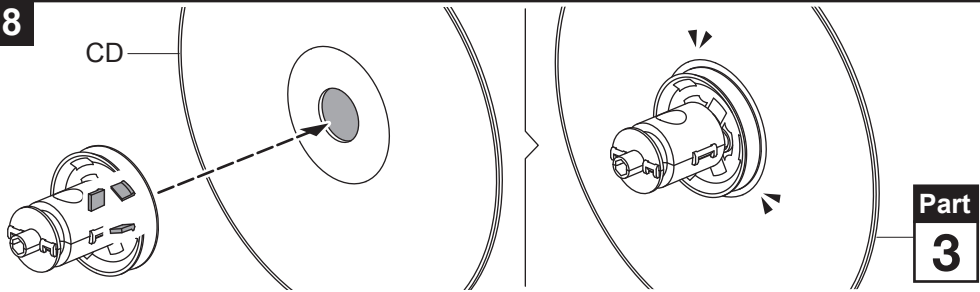
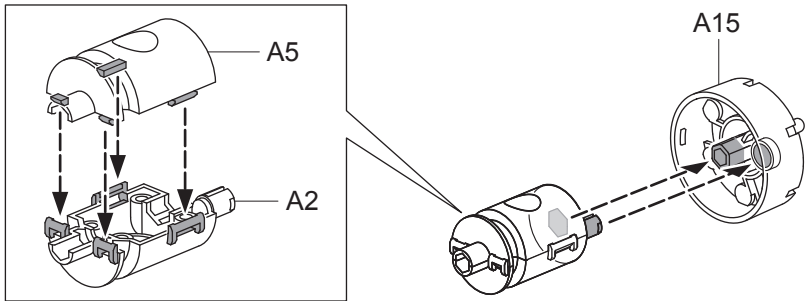
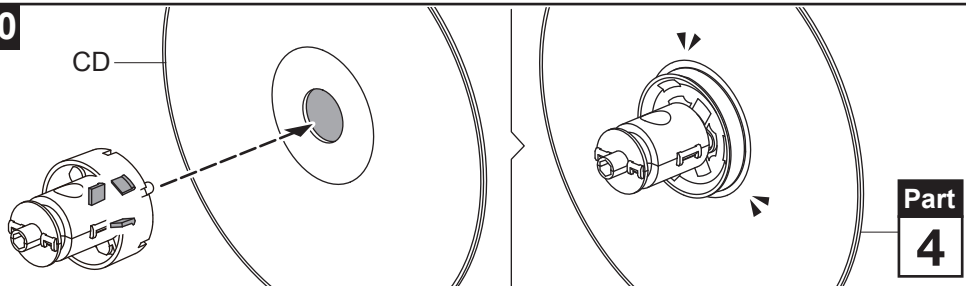
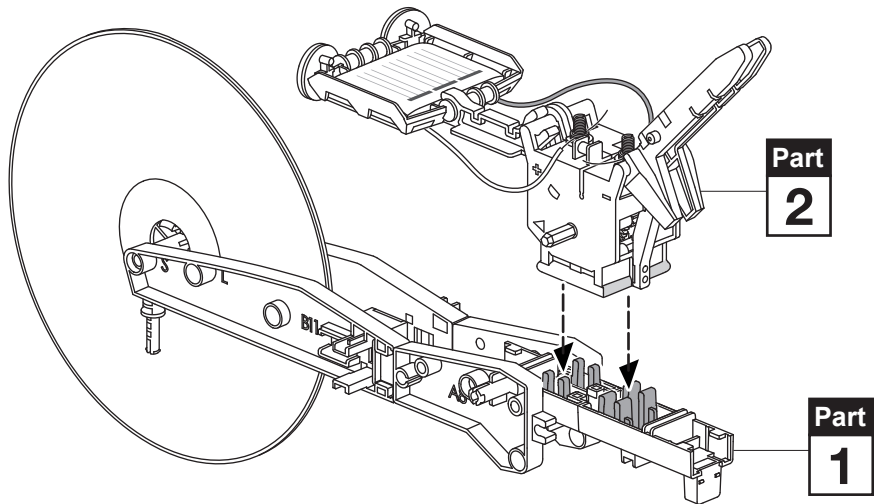
8**9****10****11**

12

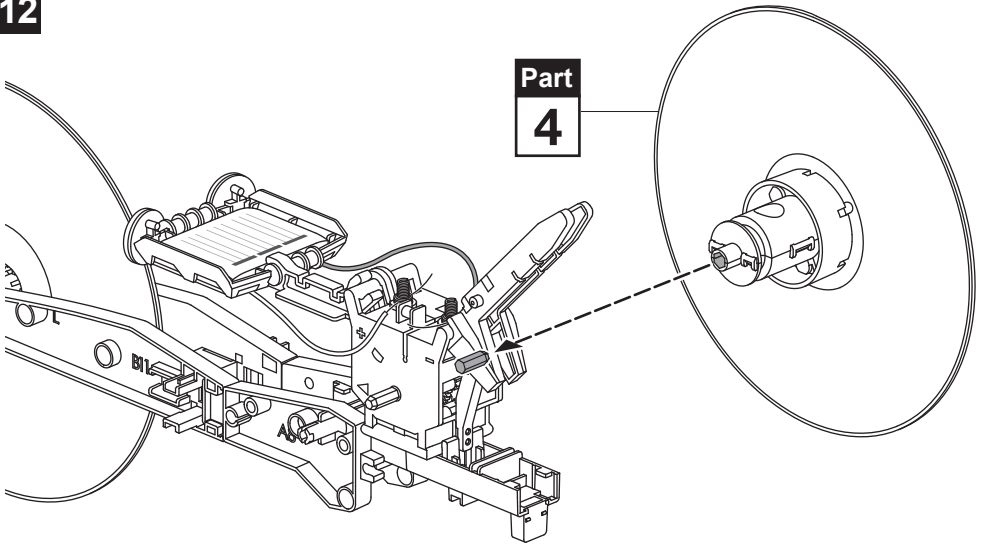

13

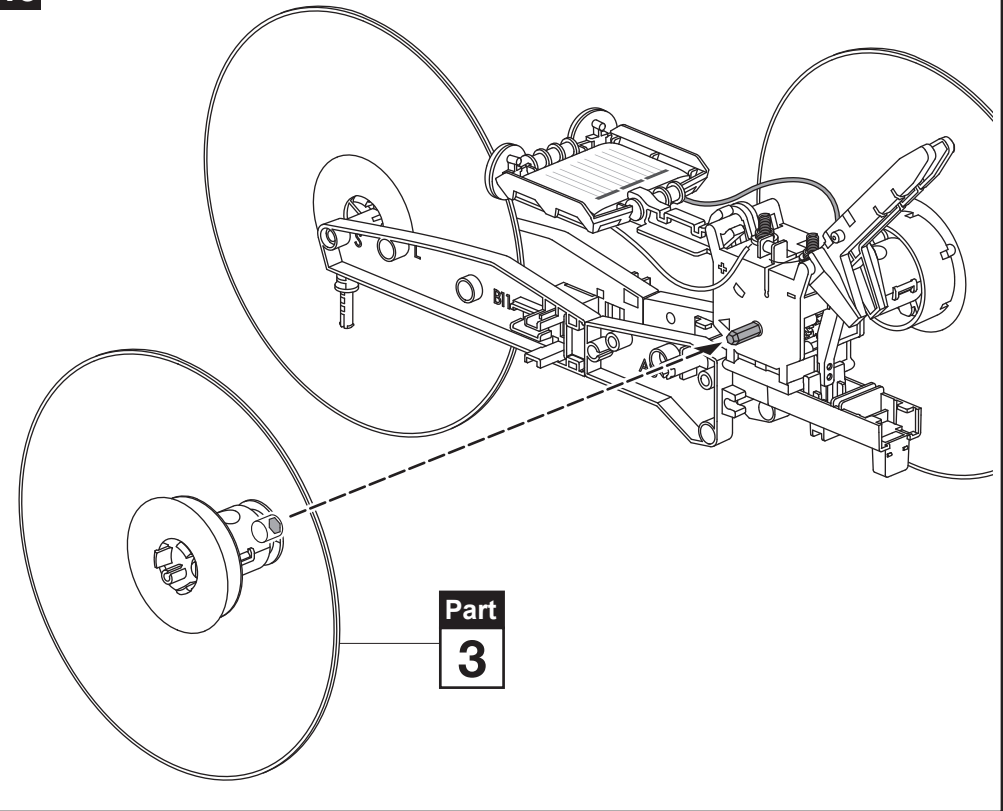

14 Running

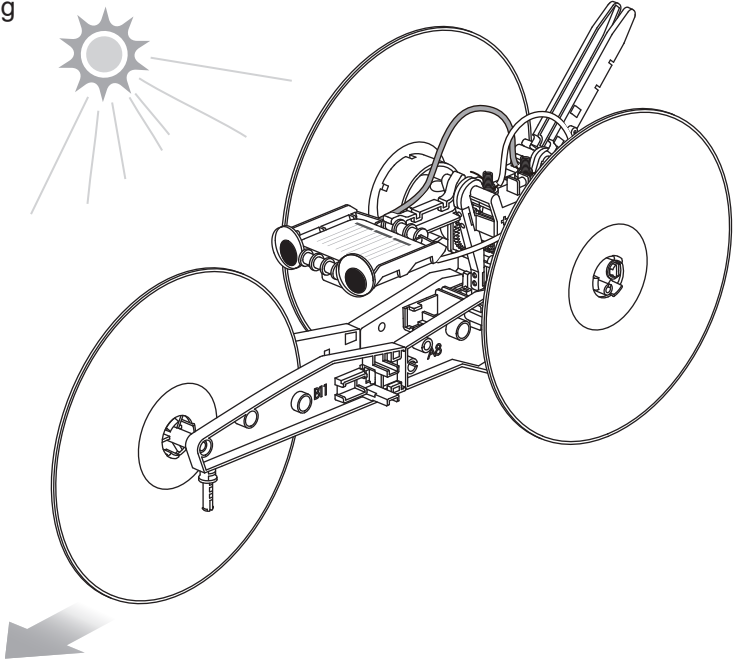

Disassemble

CD & Plastic Parts

“Disassemble” This portion is a little unclear to me because I have yet to put it to practice but can we change the text to, “Remove the plastic bushings from the CDs as illustrated below. Release A4 from the front wheel and remove A15 or A6 +A14 from rear wheels”

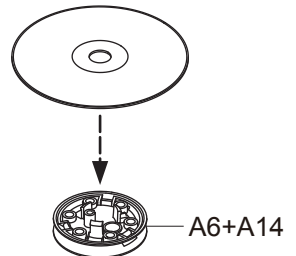
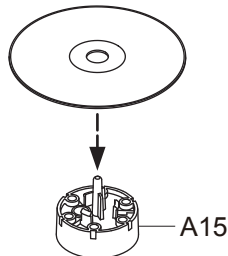
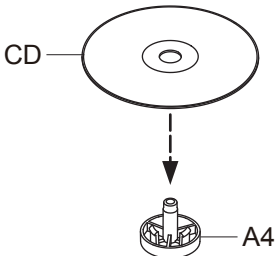
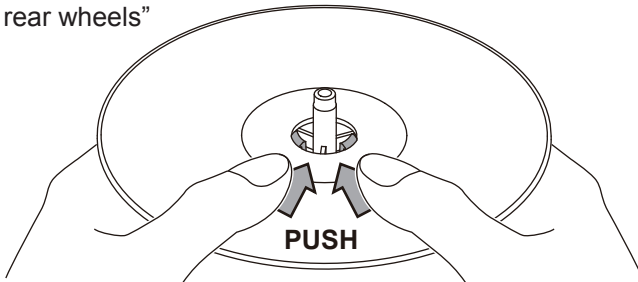

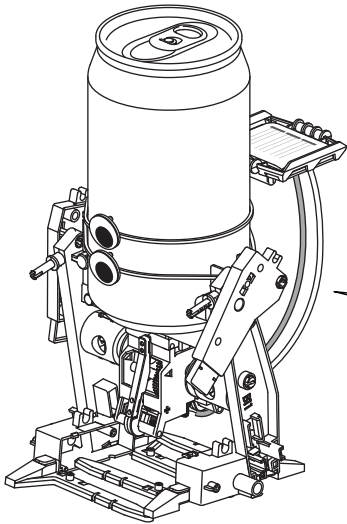

Recycled Parts Required

Soda Can
330~355ml

x1

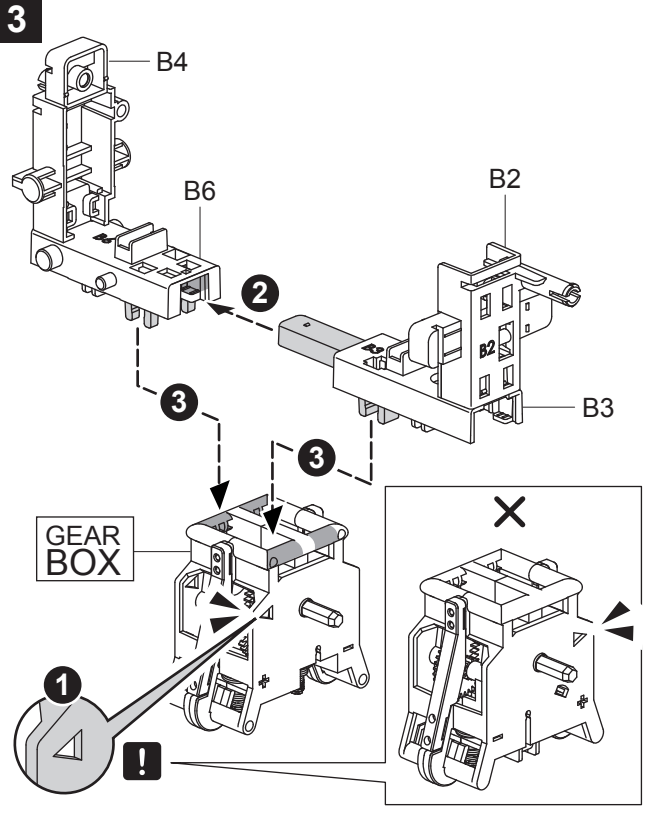
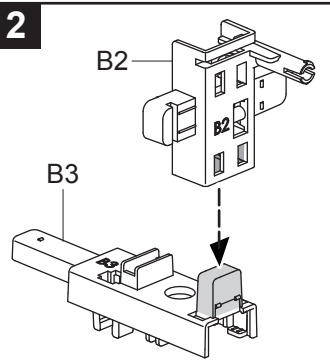
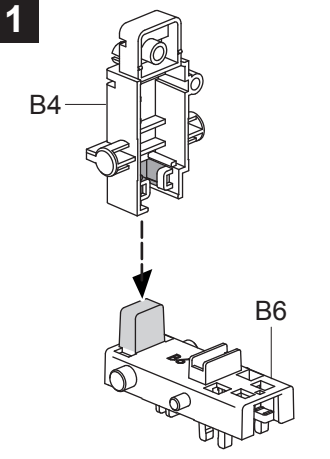

4

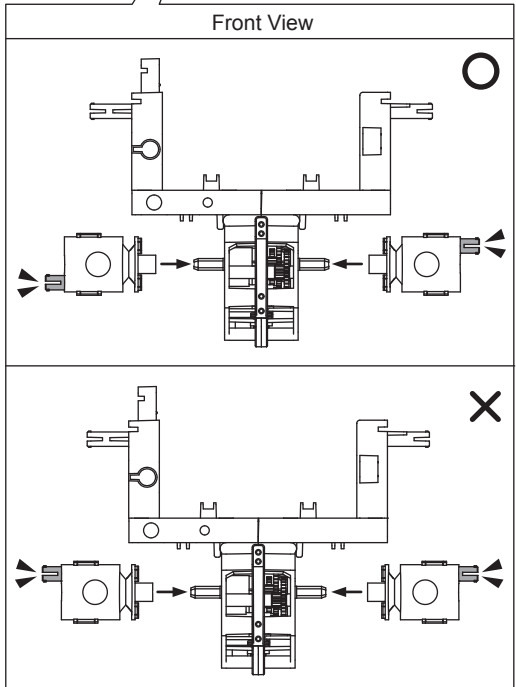
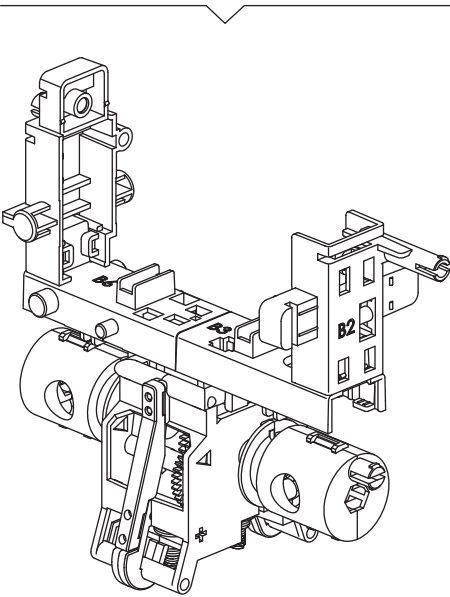
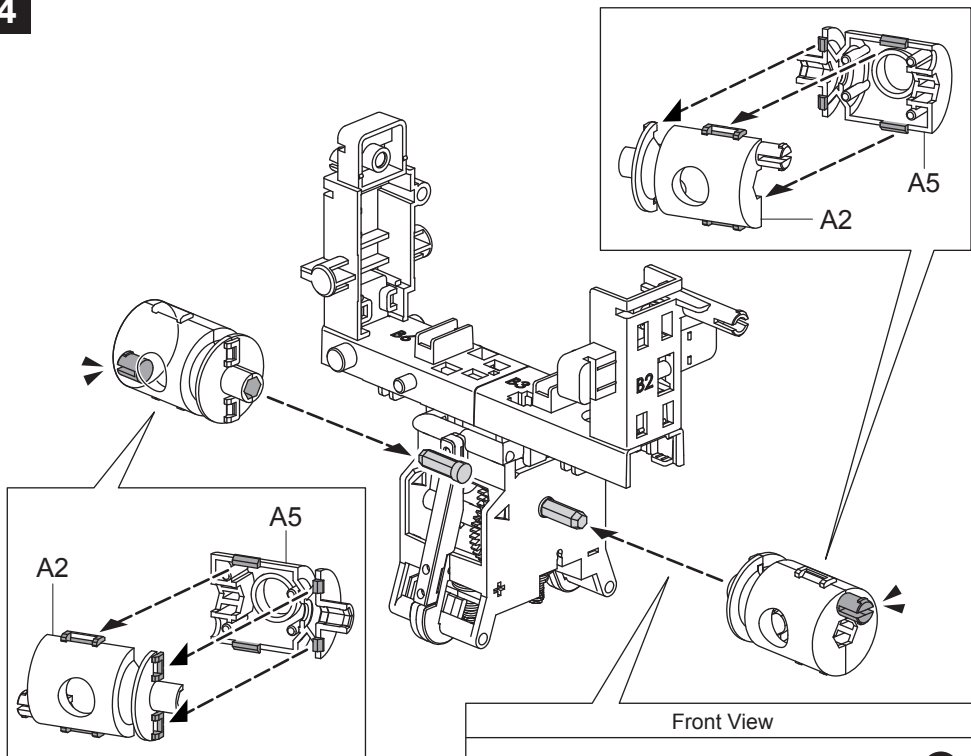

5

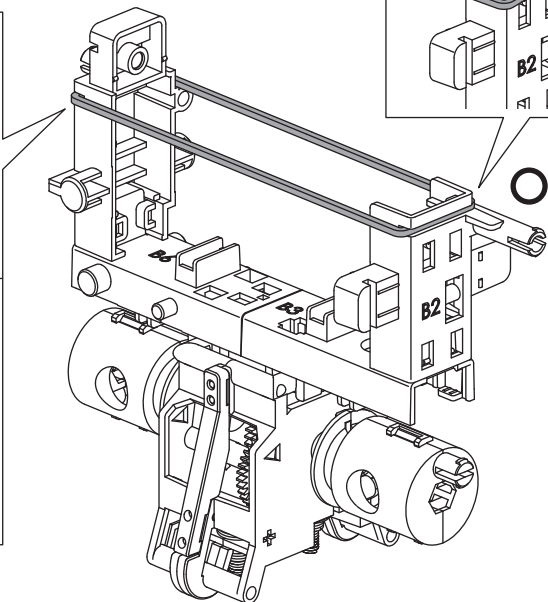
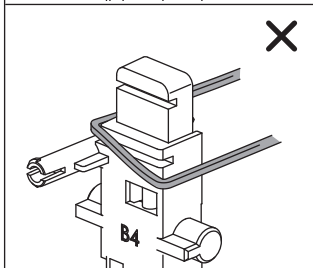
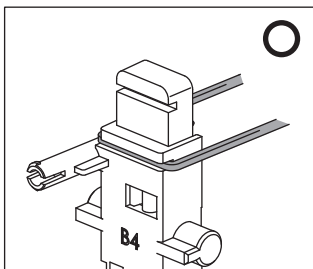
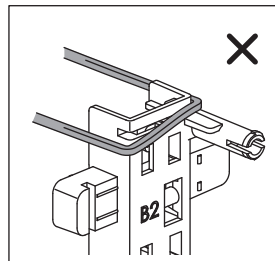
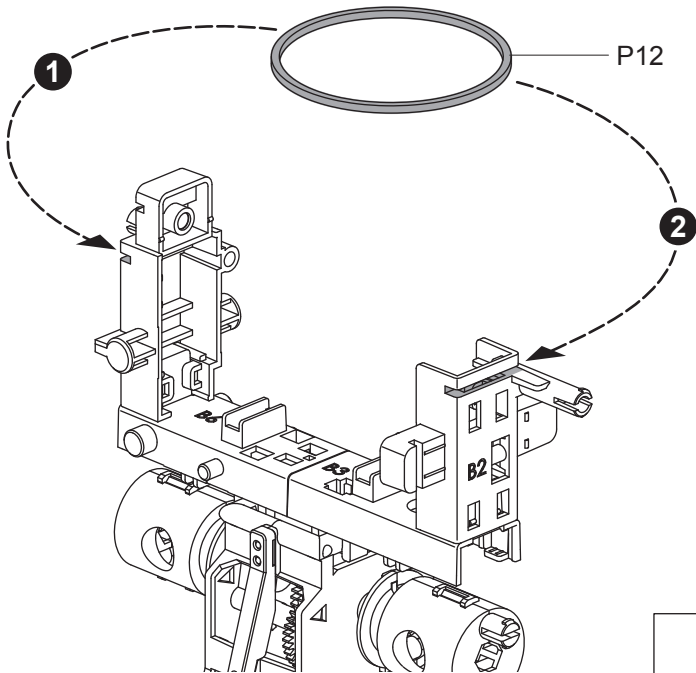

6

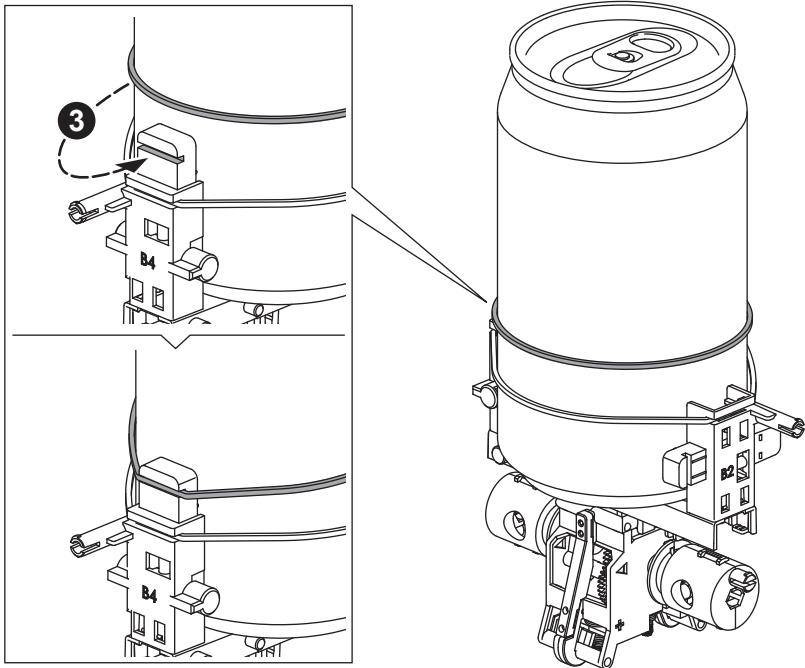
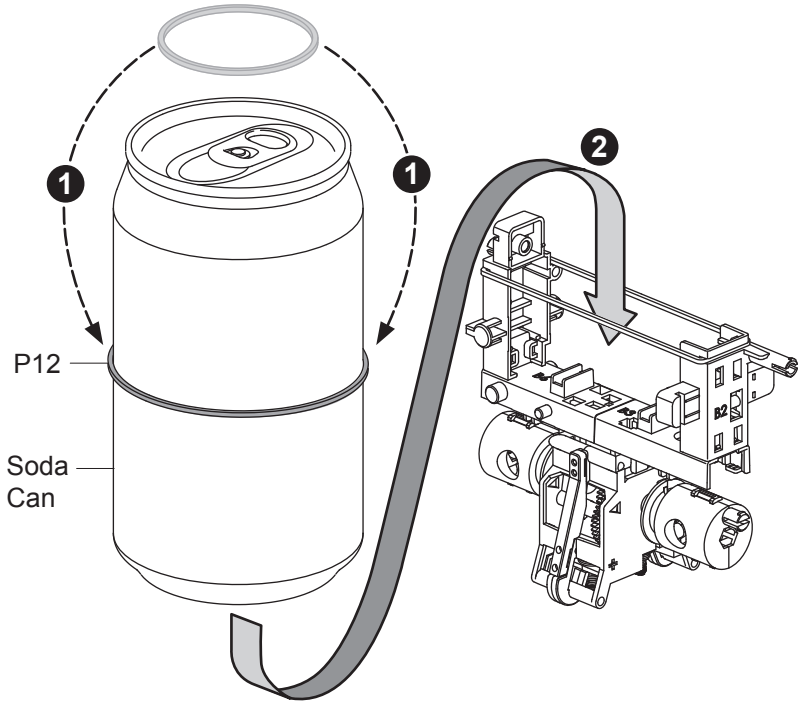

7

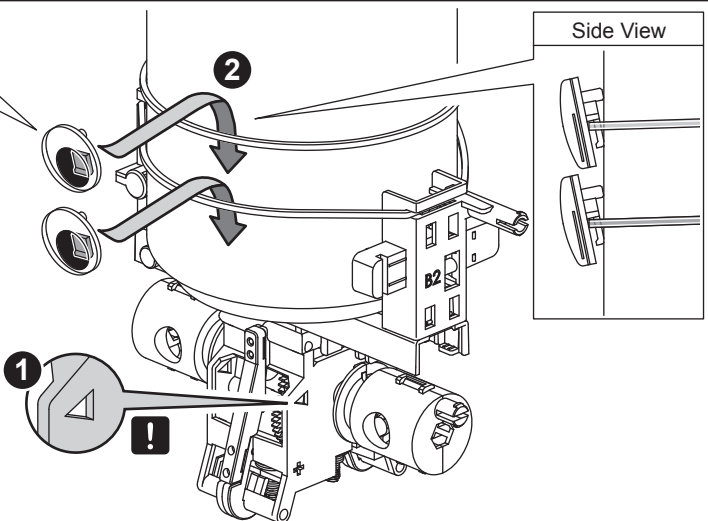
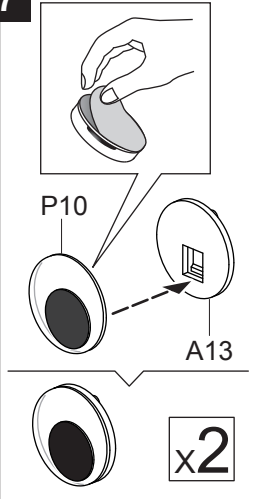

8

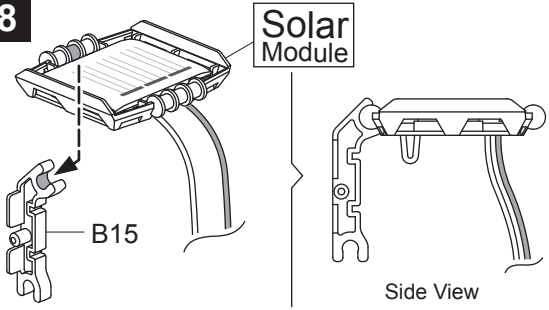

10

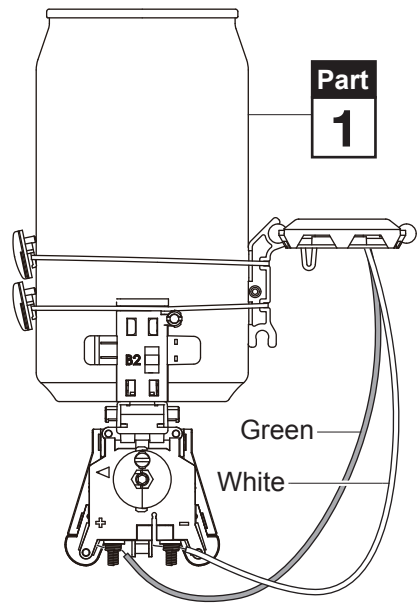

9

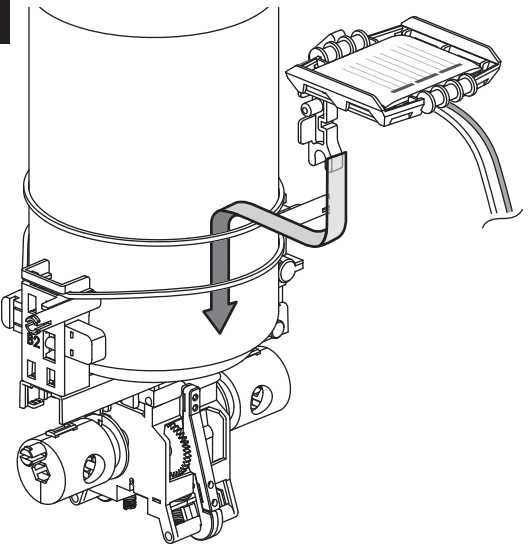

GREEN WIRE CONNECT +

WHITE WIRE CONNECT -

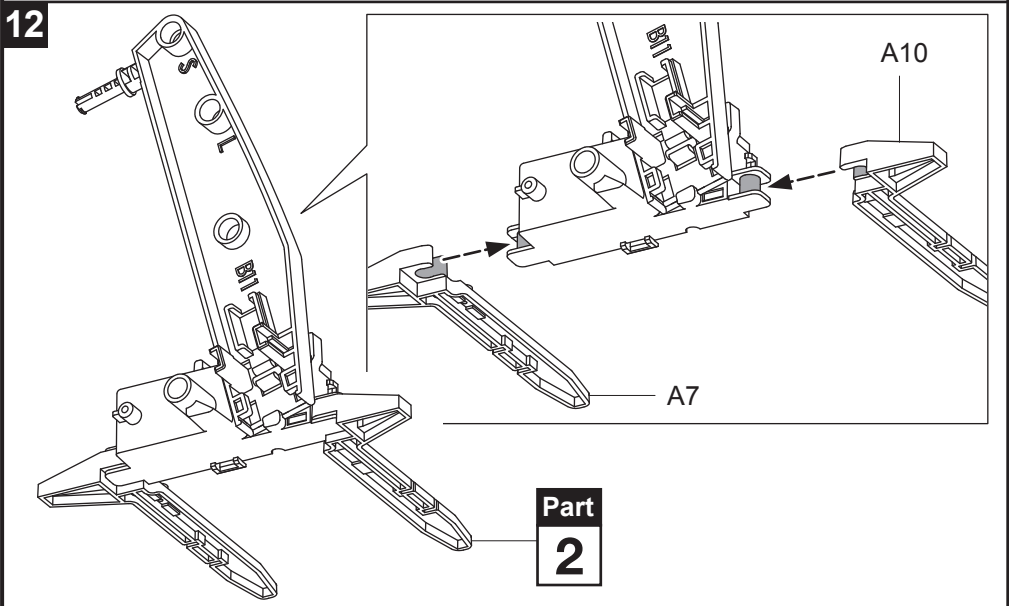
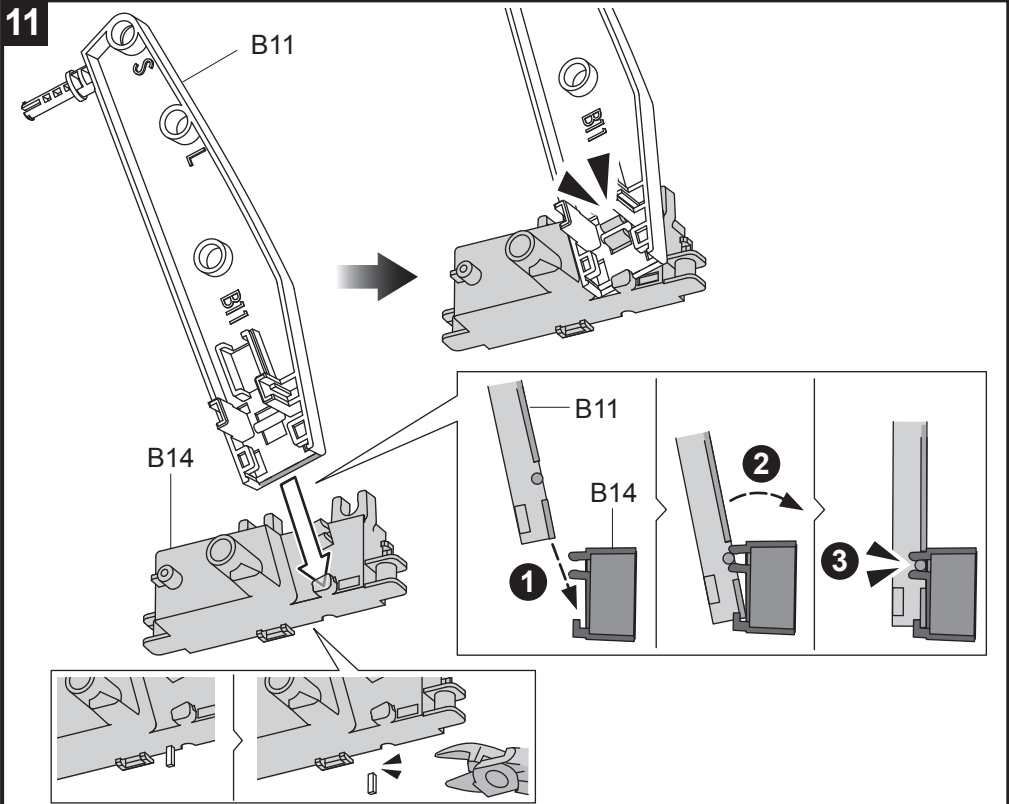

13

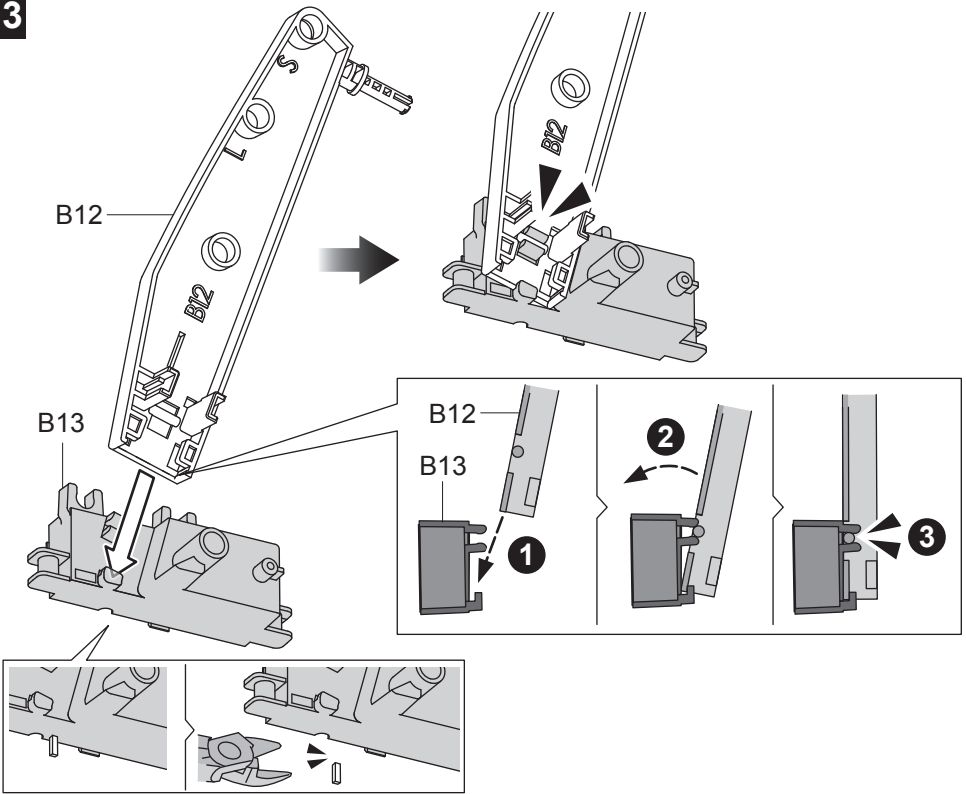

14

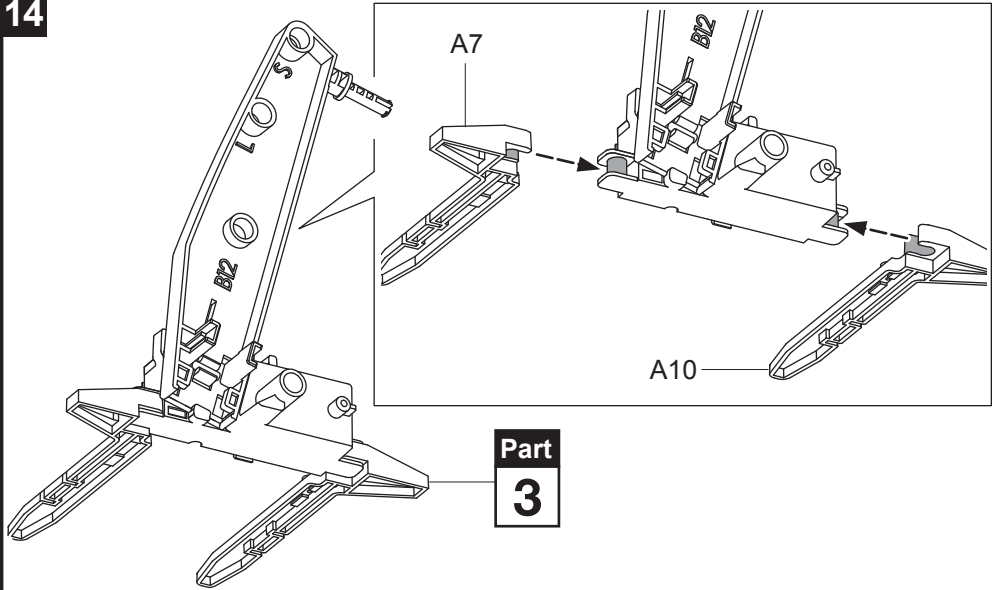

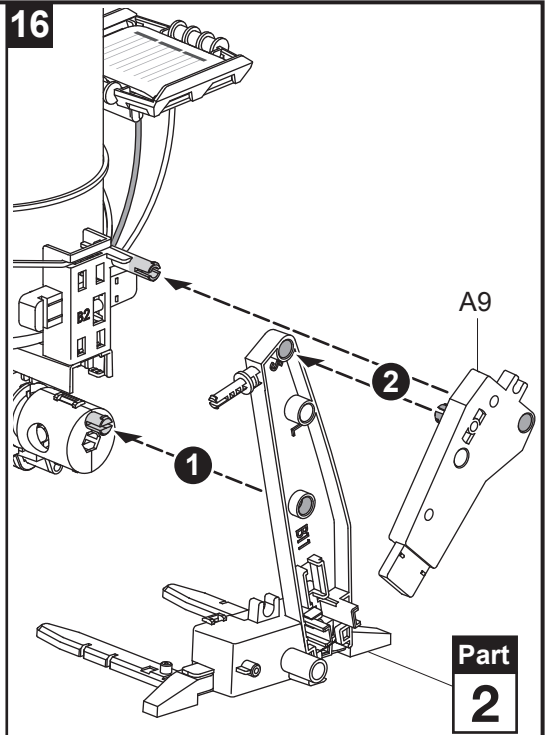
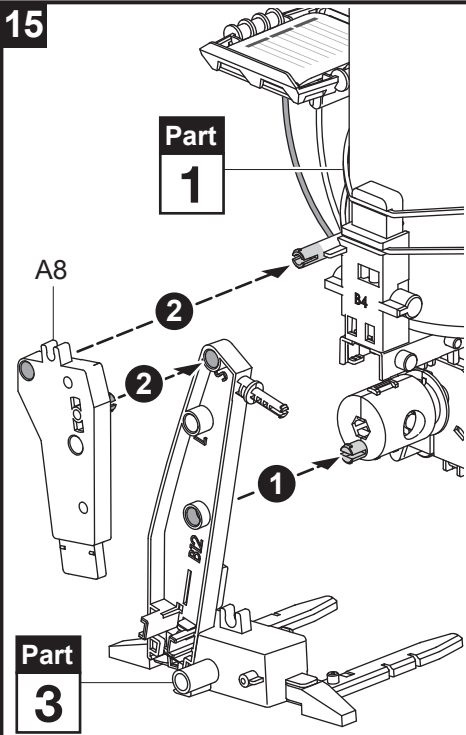

17 Running

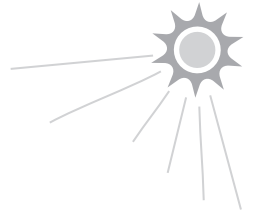
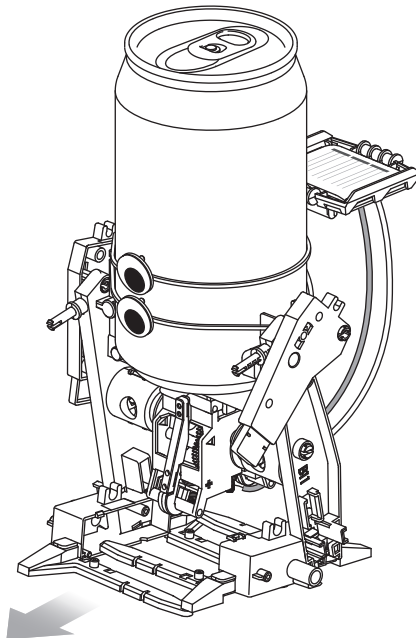

Disassemble

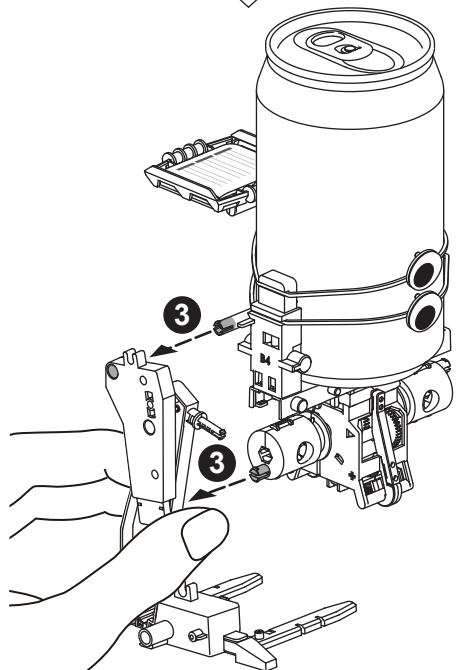
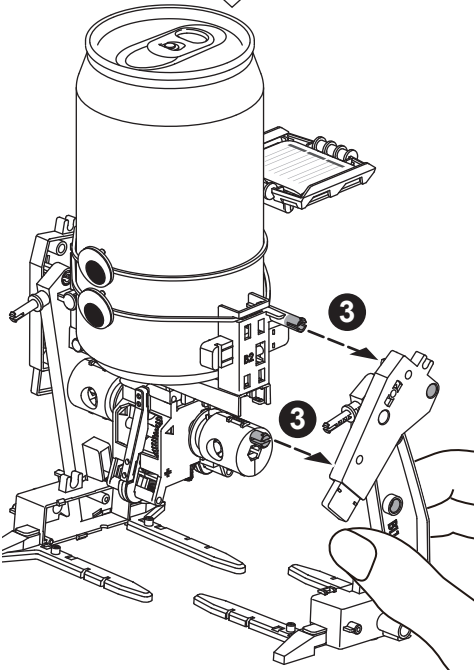
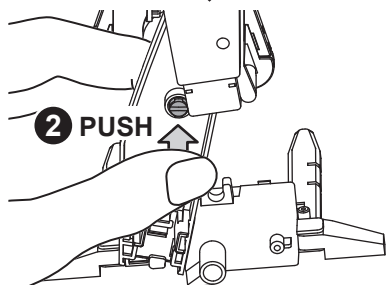
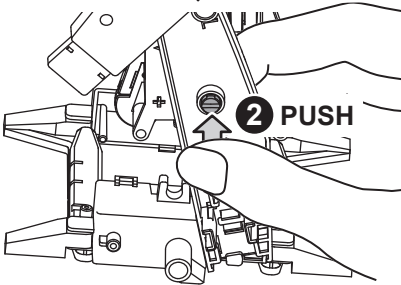
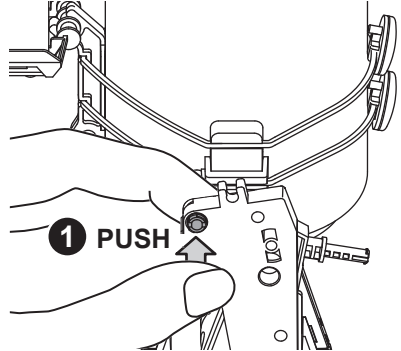
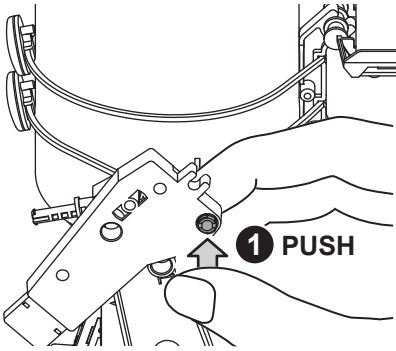

Recycled Parts Required

Plastic Bottle

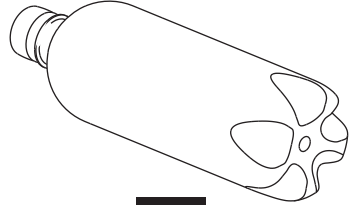

or

Soda Can

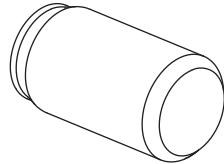

x1

1

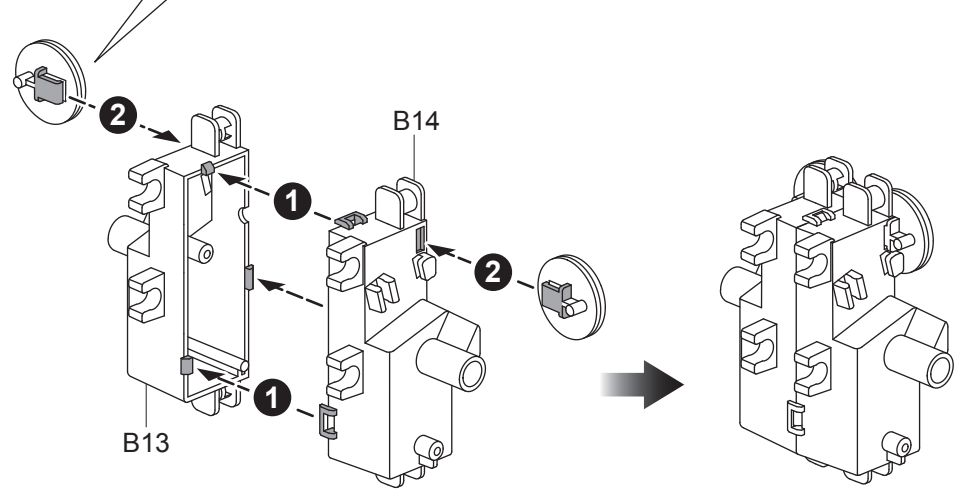
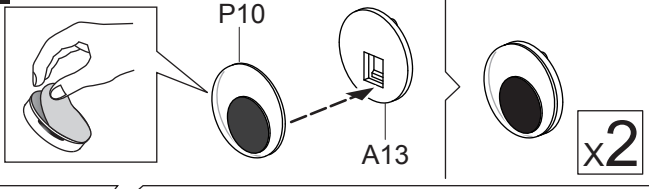

2

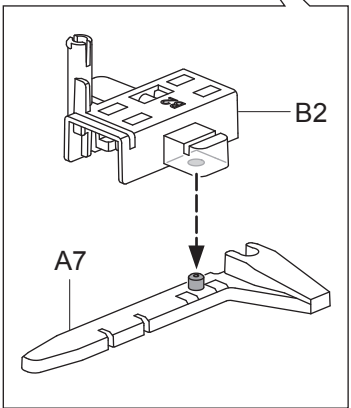
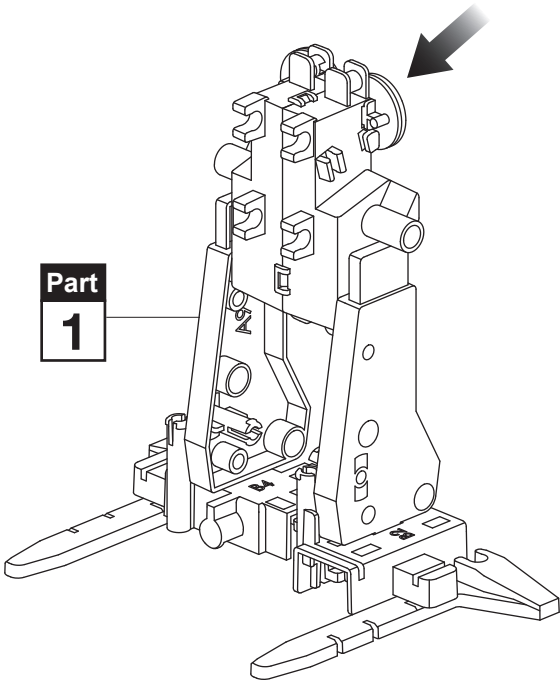
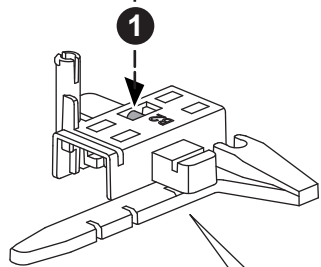
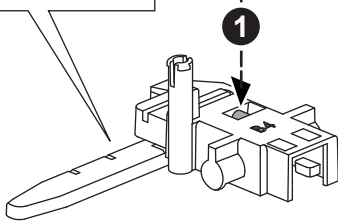
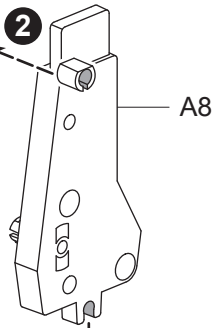
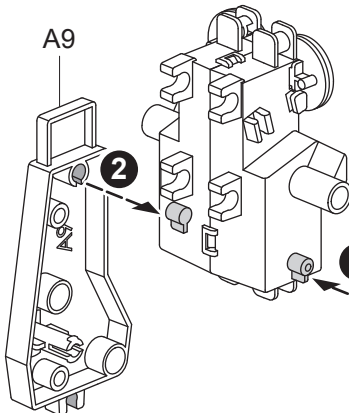
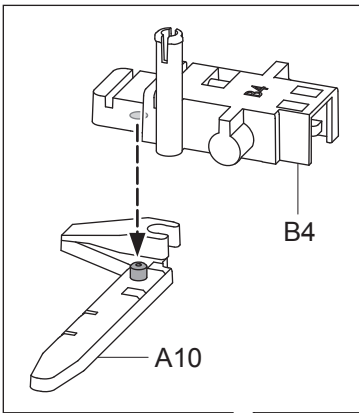

3

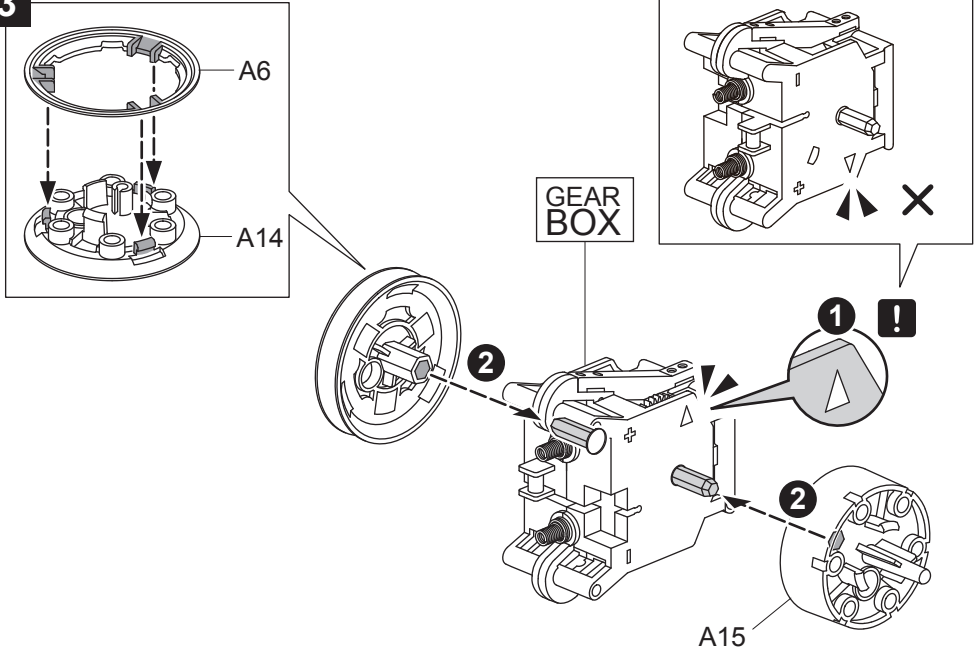

4

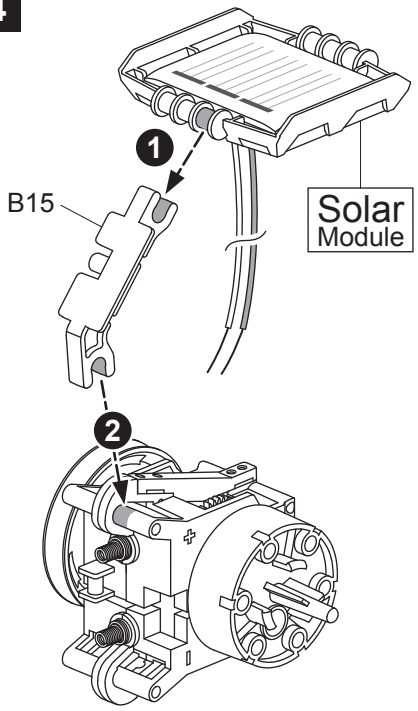

5

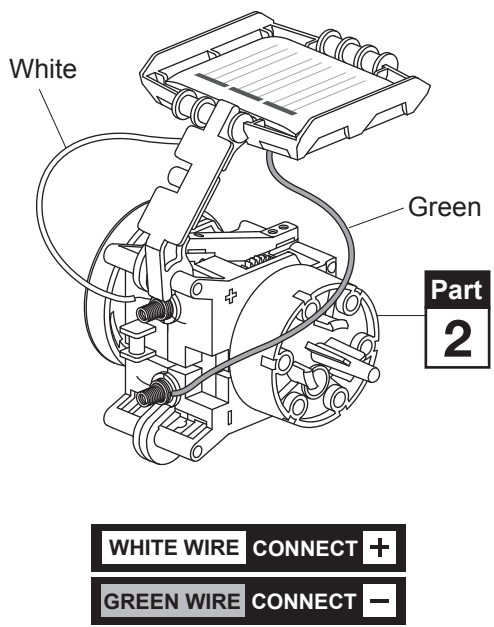

6

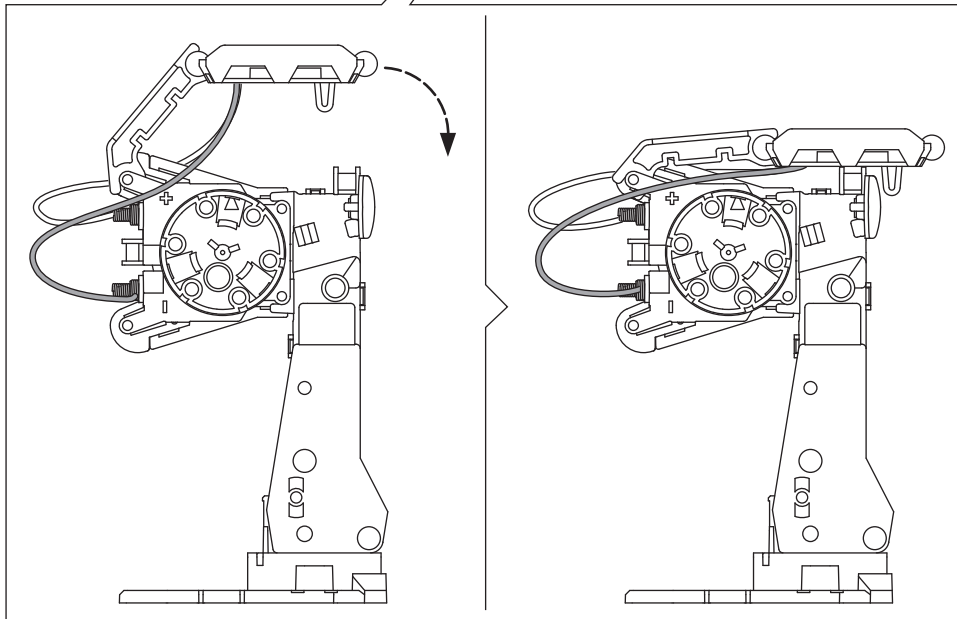
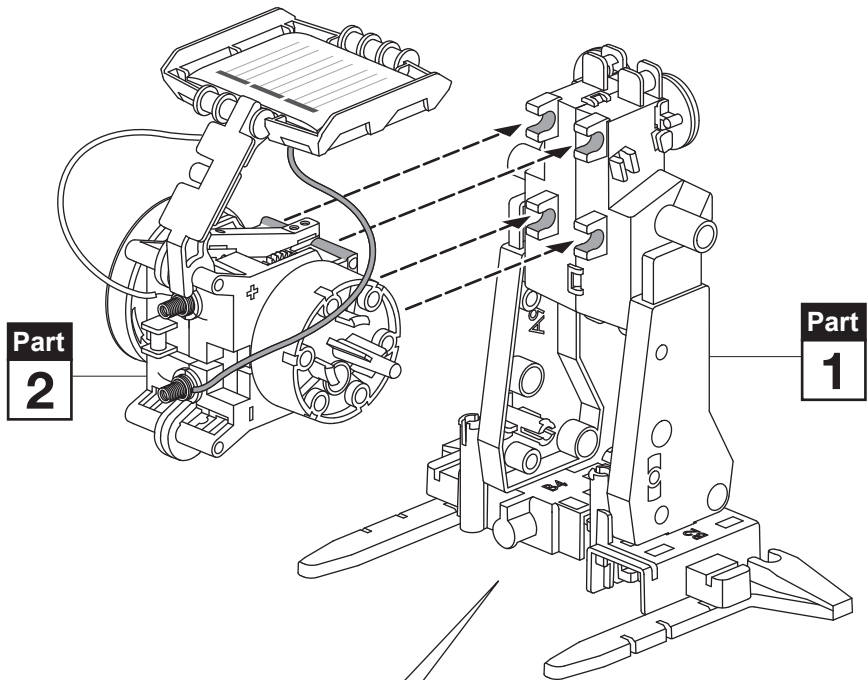

7

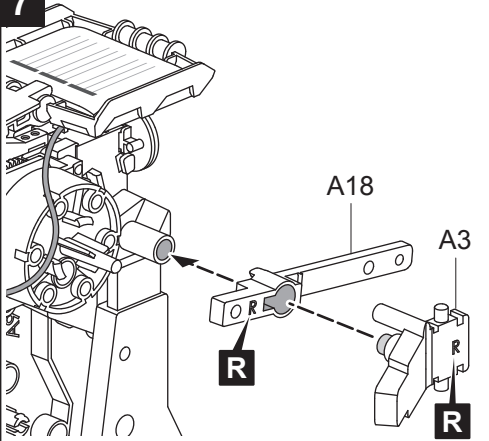

8

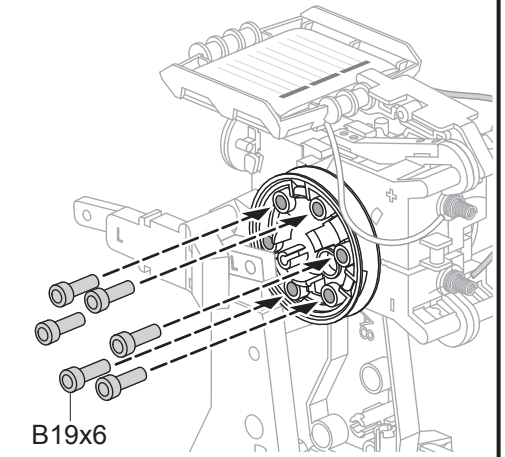
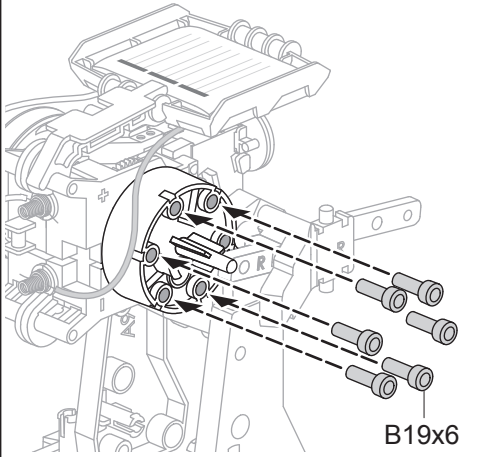
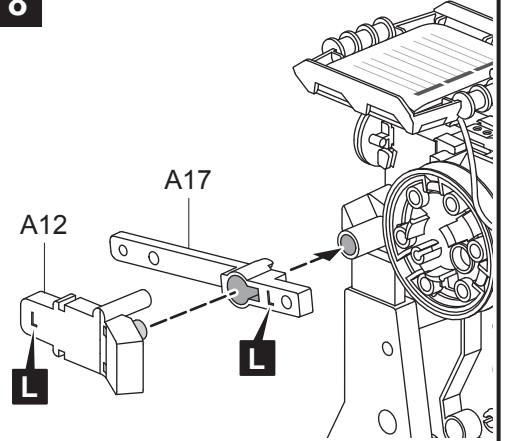

9

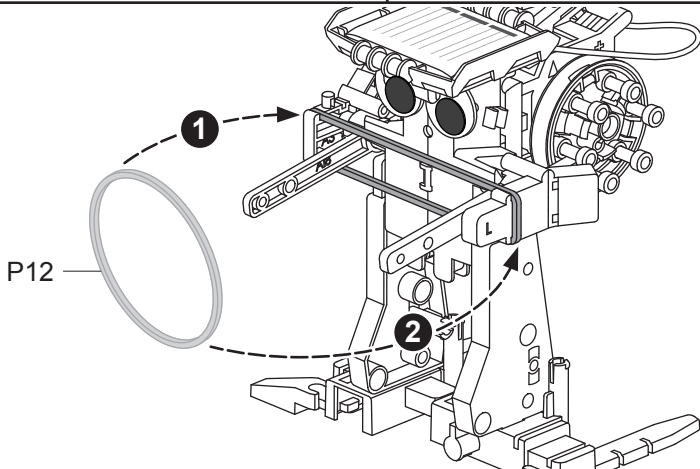

10 Running

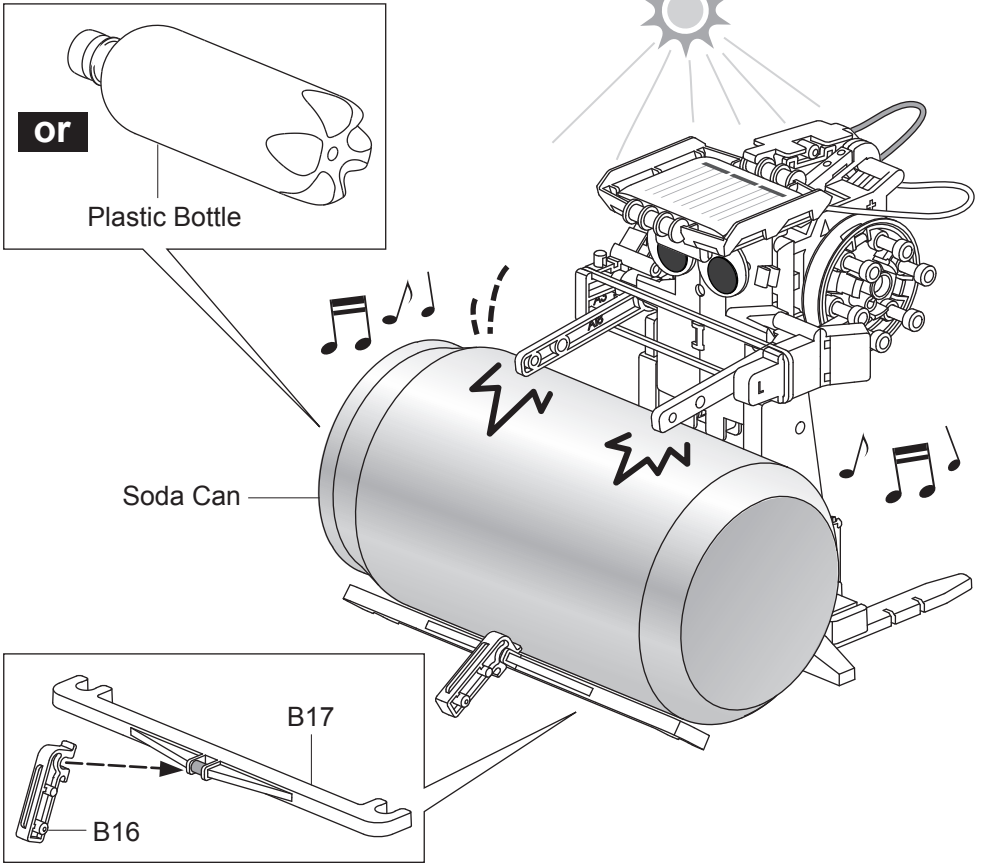

Adjust Robot's arm to have strong/or weak of drumbeat

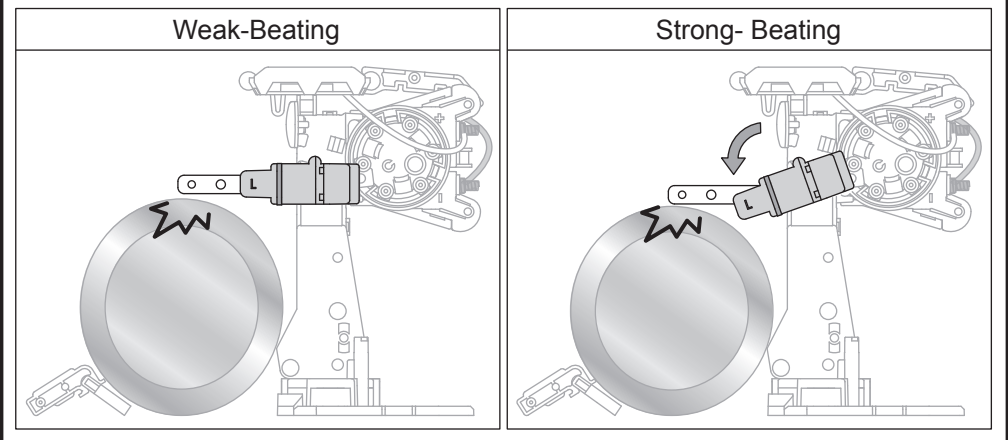

Make your own unique tempo

Install B19 with different quantity and position as below figure.

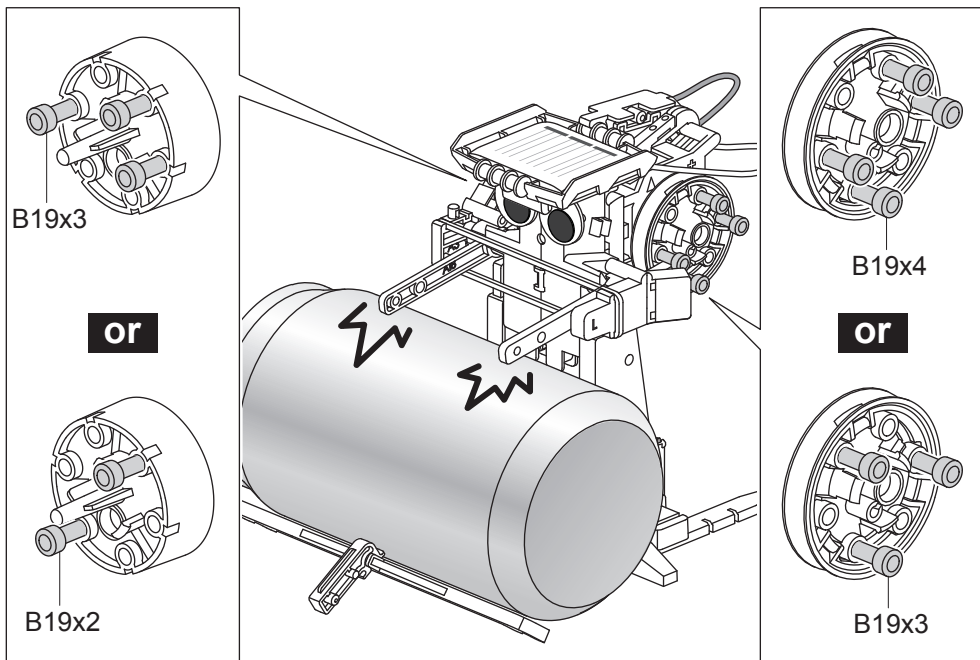

Disassemble

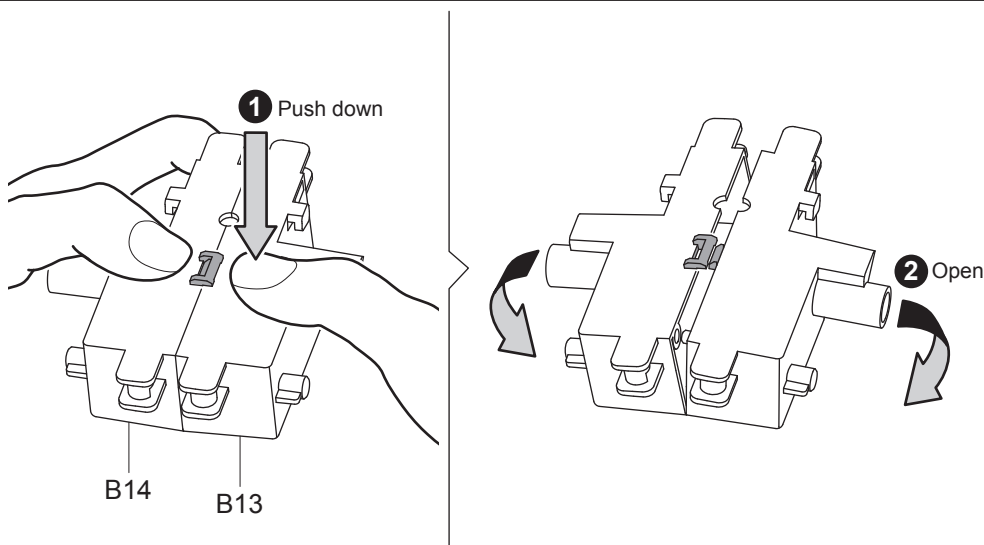

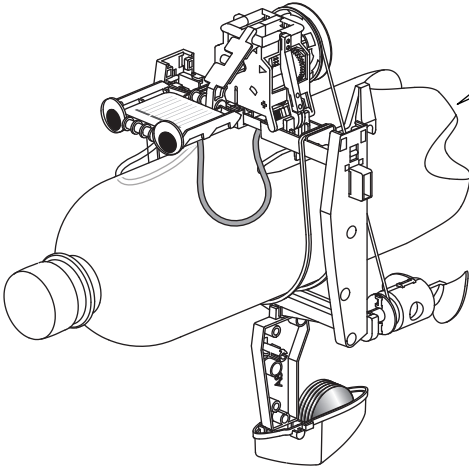

Recycled Parts Required

Plastic Bottle
500~600 ml

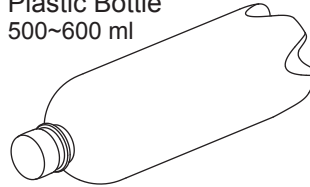

x1

Tube Body

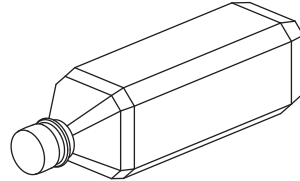

Square Body



1

P10

A13

x2

B15

GEAR BOX

1

2

3

Solar Module

WHITE WIRE CONNECT -

GREEN WIRE CONNECT +

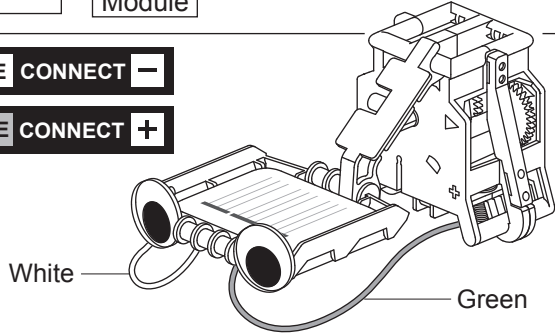

2

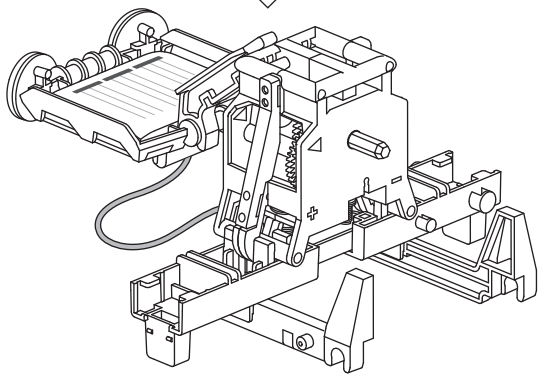
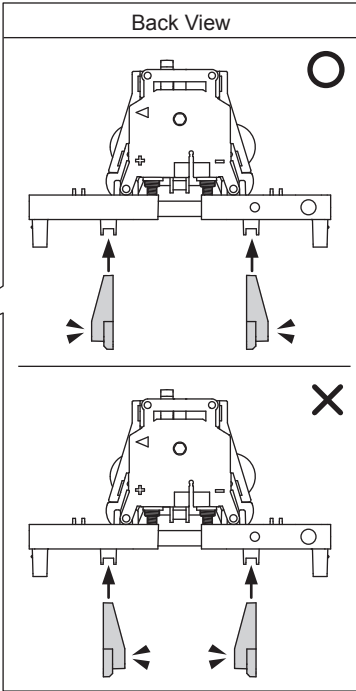
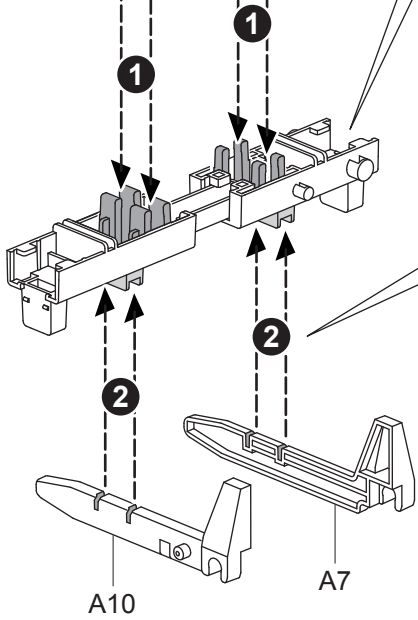
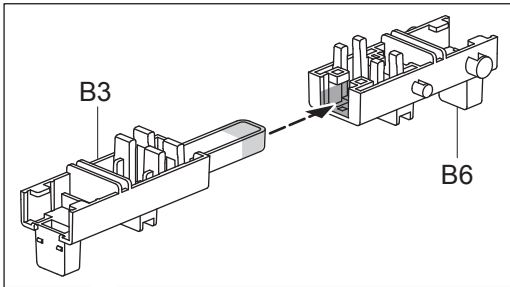
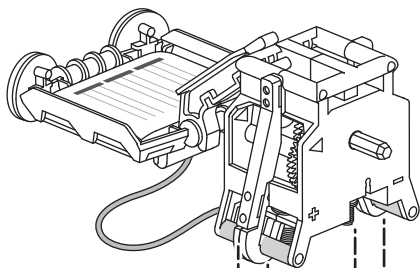

3

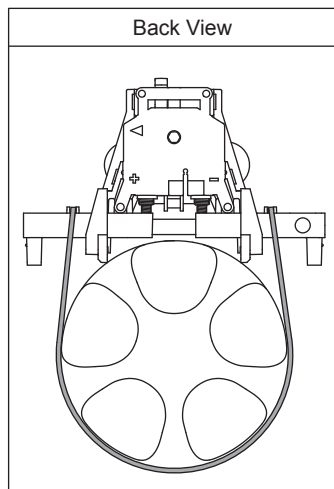
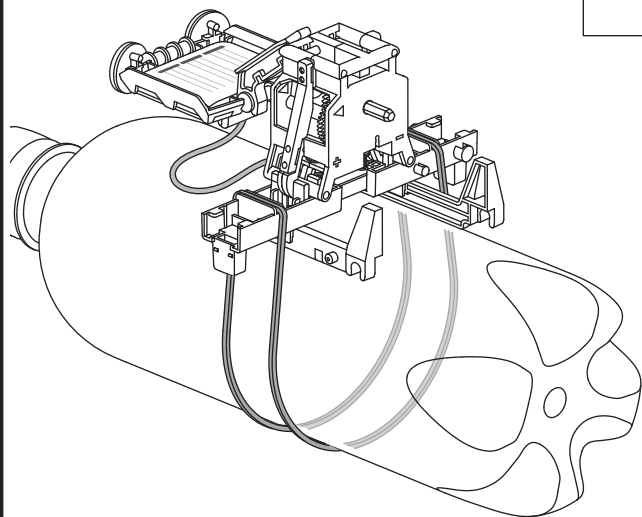
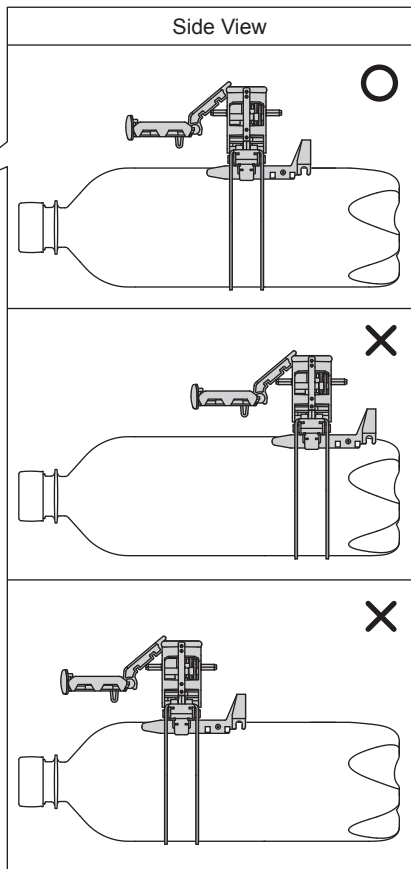
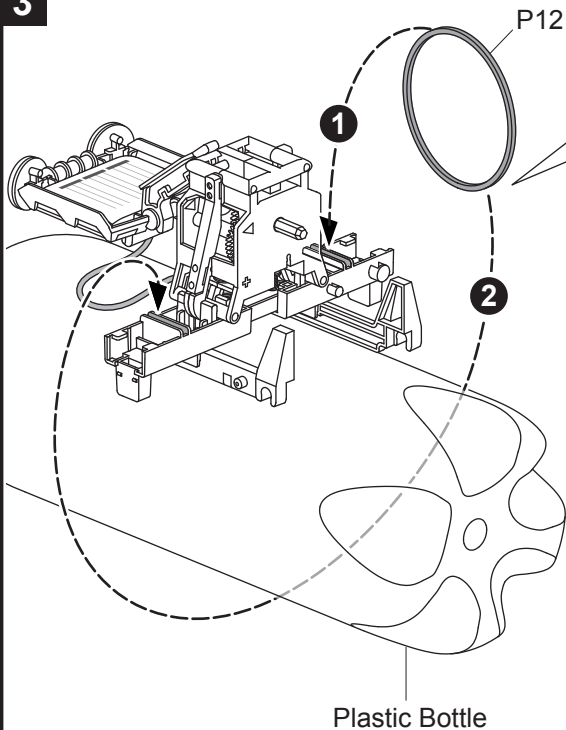

4

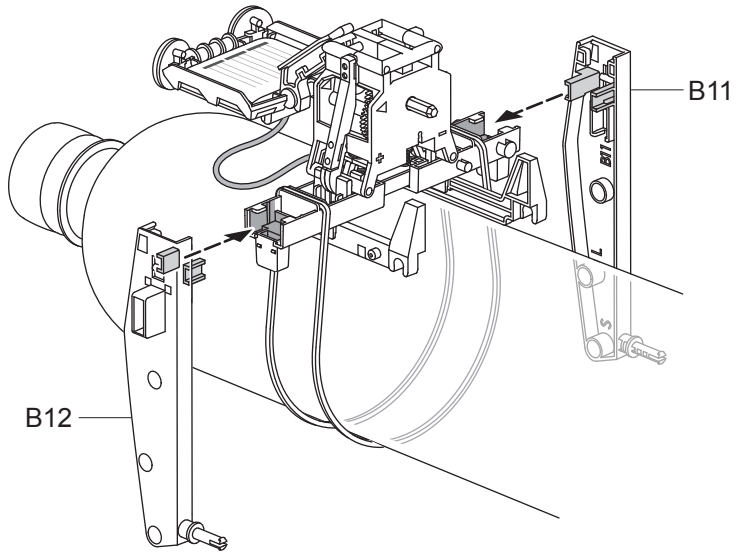

5

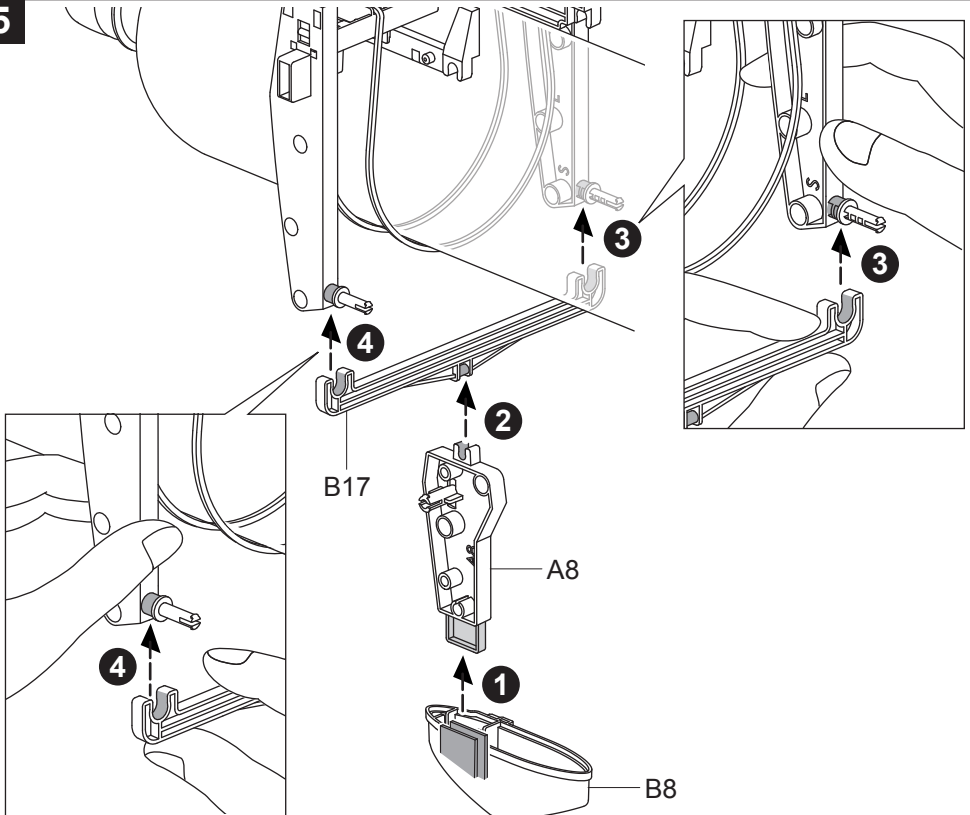

6

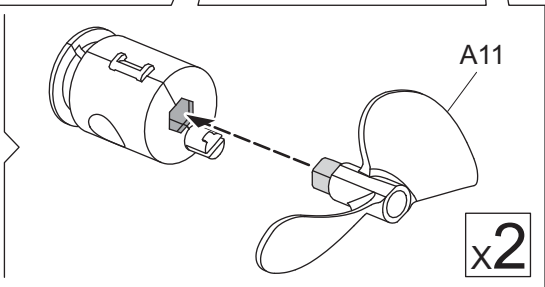
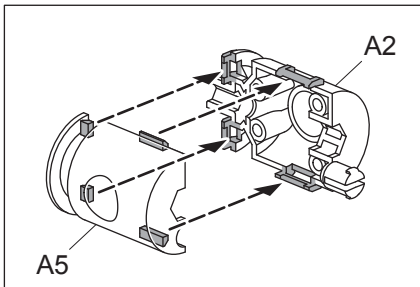
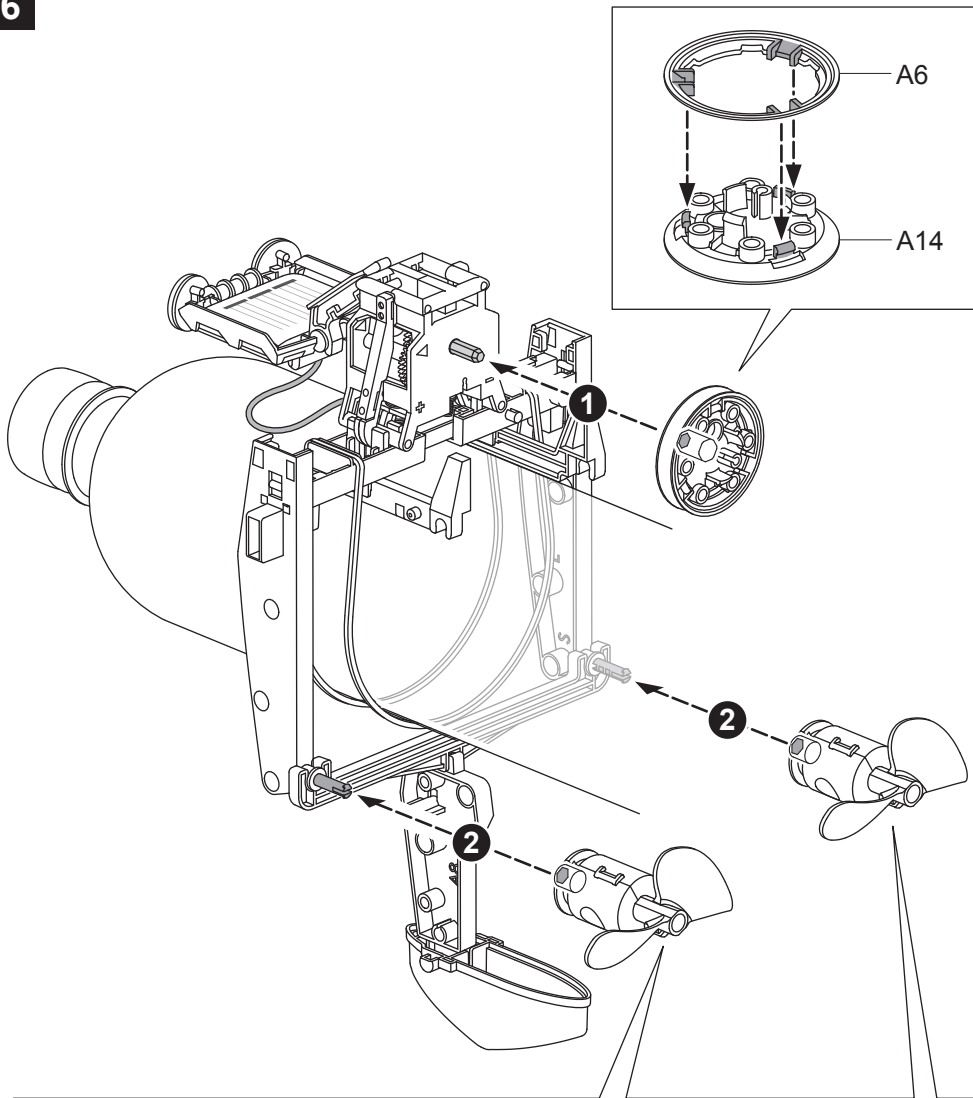

7

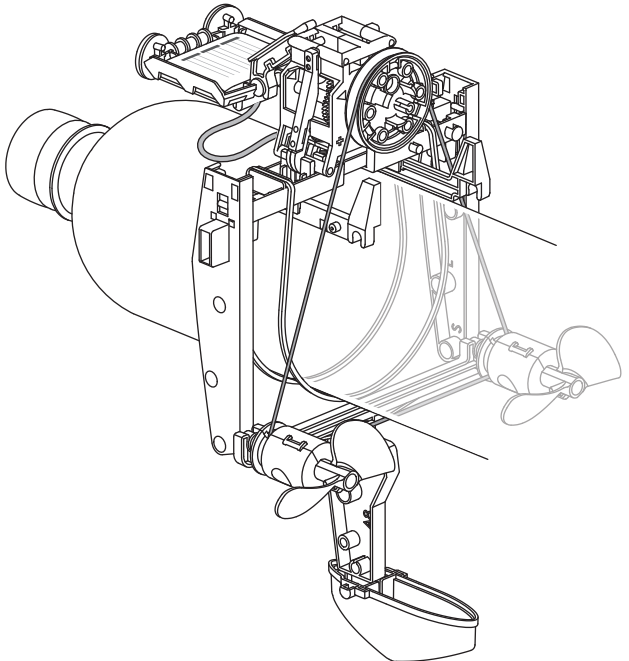
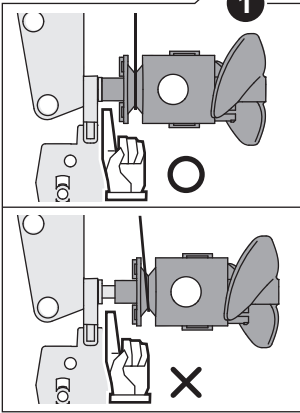
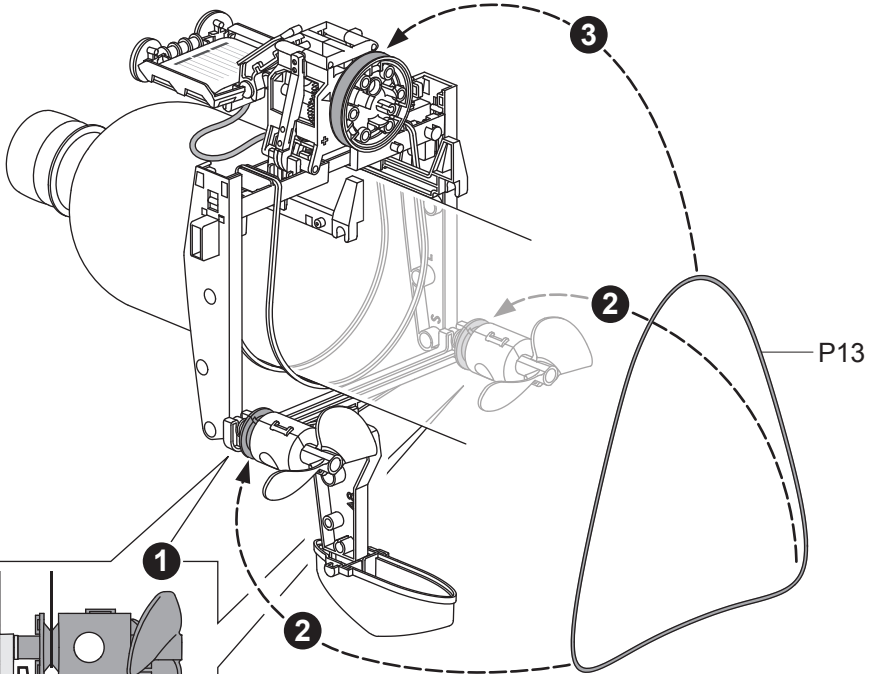

8

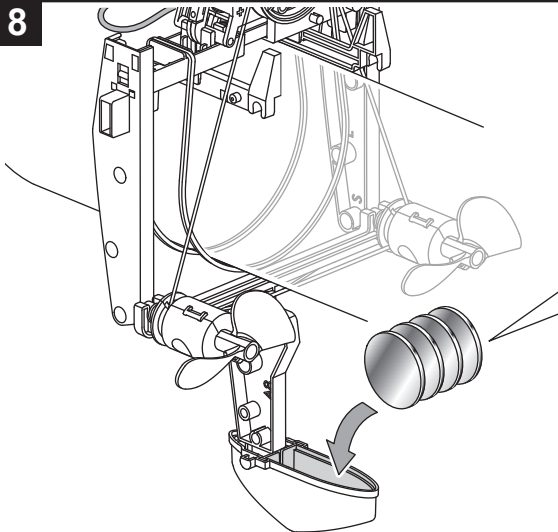

Top View : Insert coins

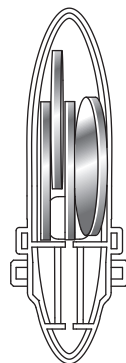
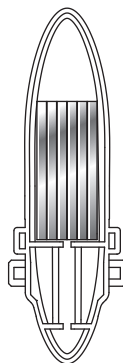

Fill up with coins completely !!
Loose space is not allowed, or it may
have coins spread out.

9

Running

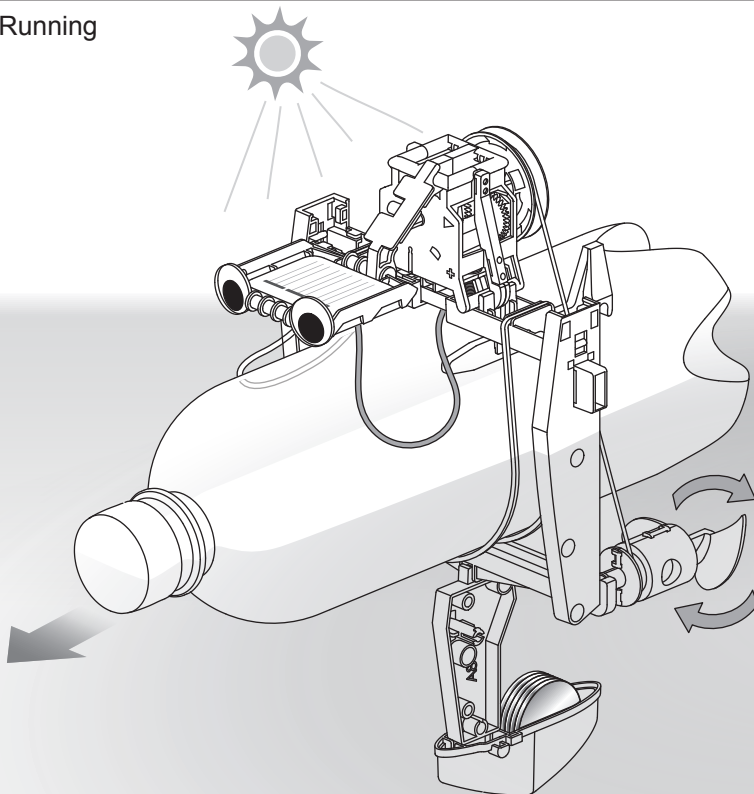

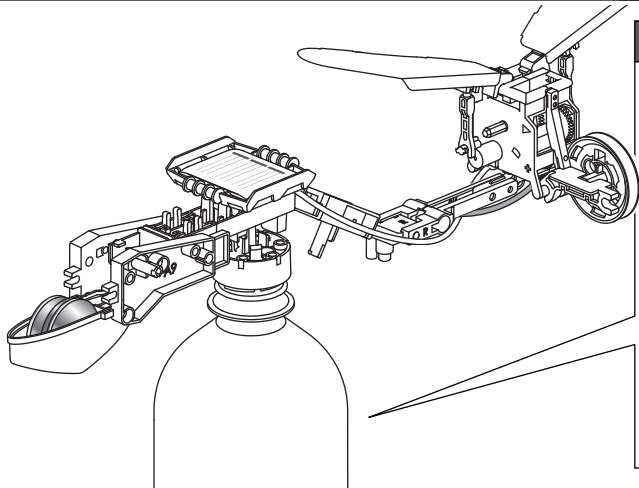

Recycled Parts Required

Plastic Bottle

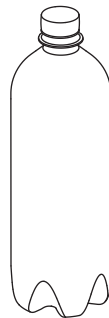

x1

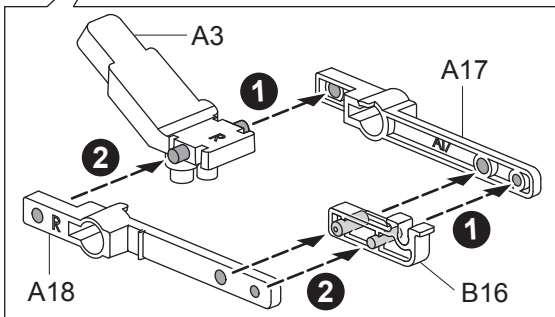
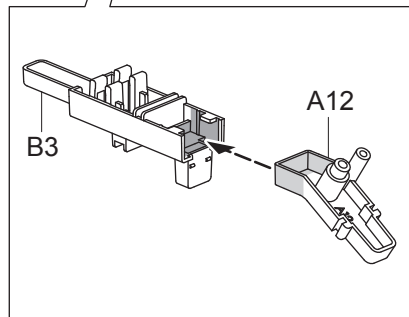
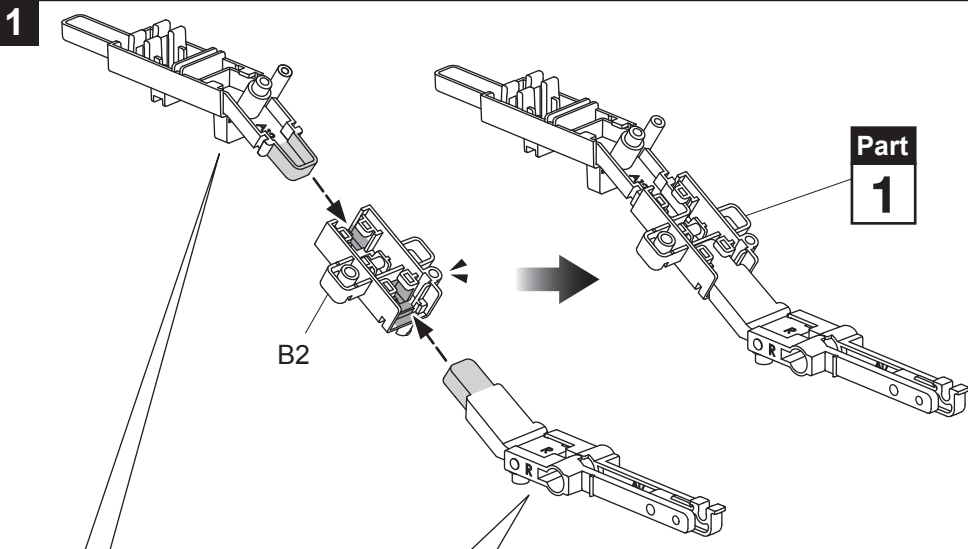

2

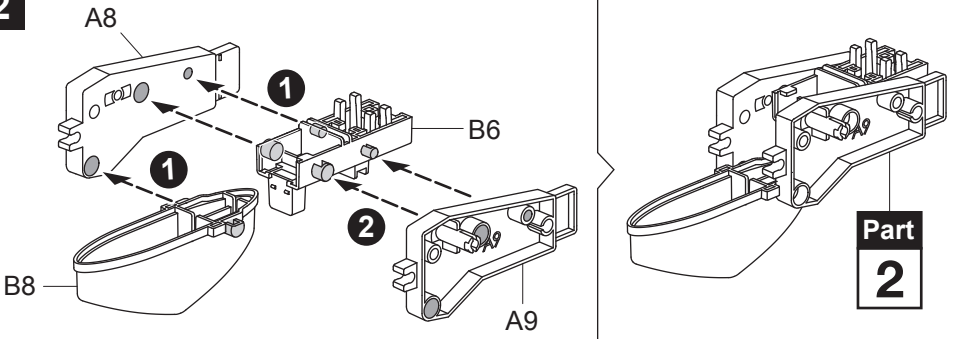

3

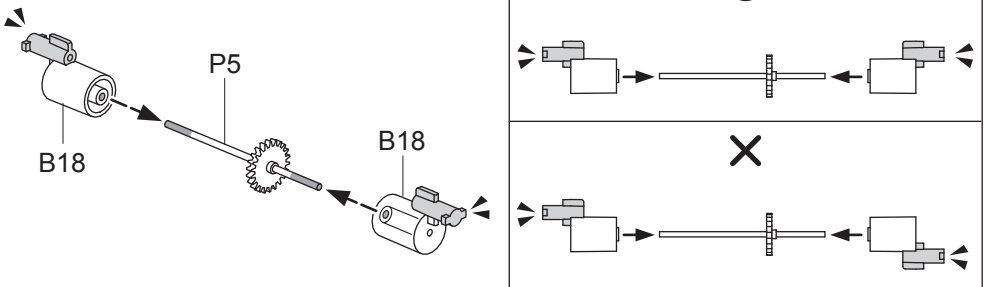

4

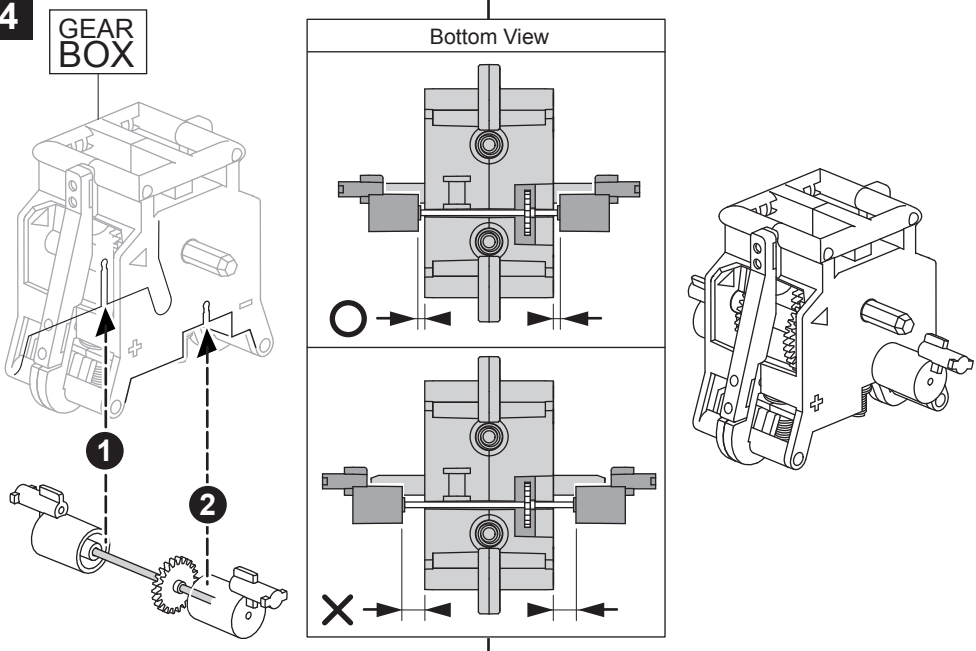

5

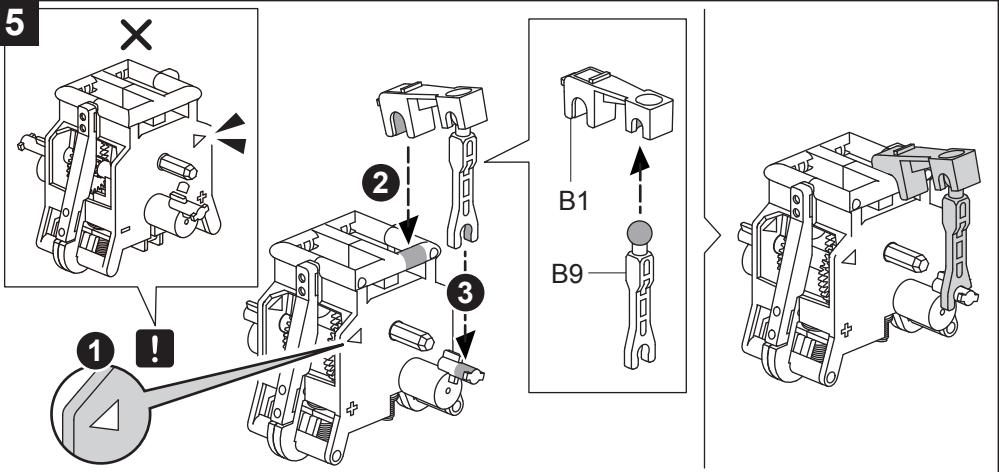

6

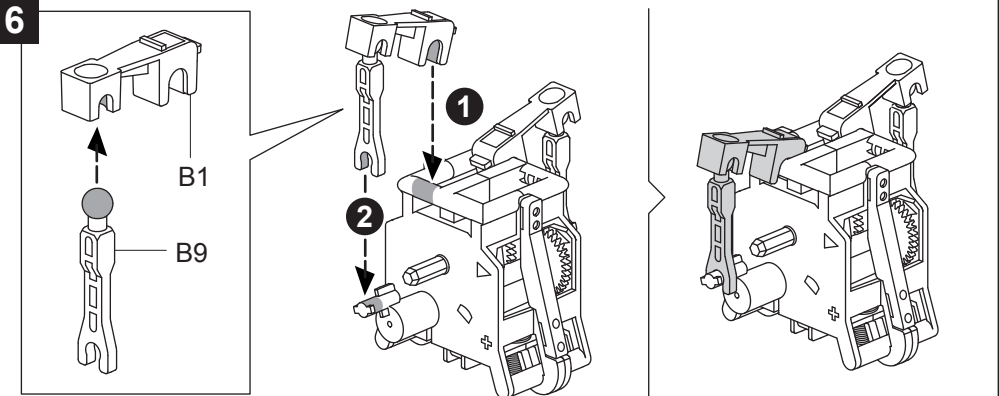

7

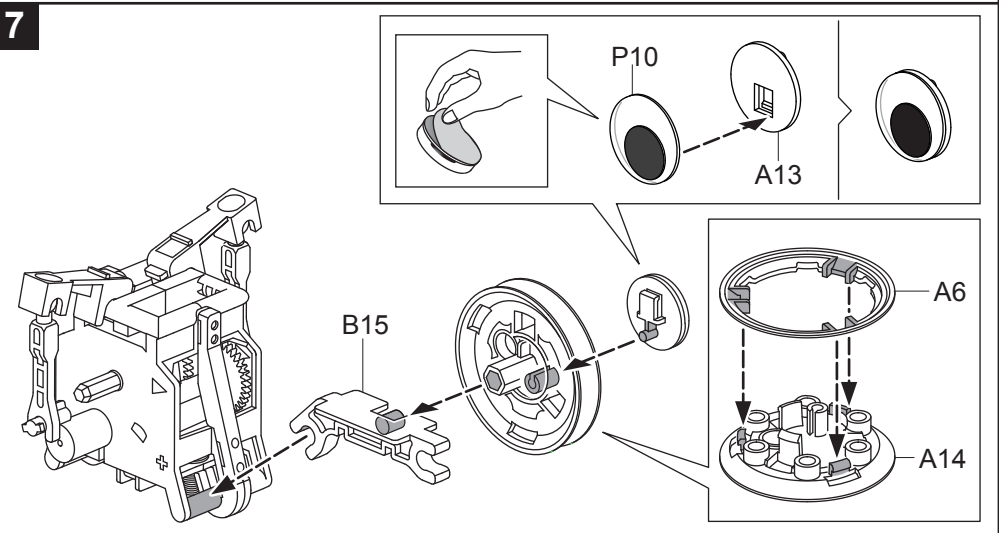

8

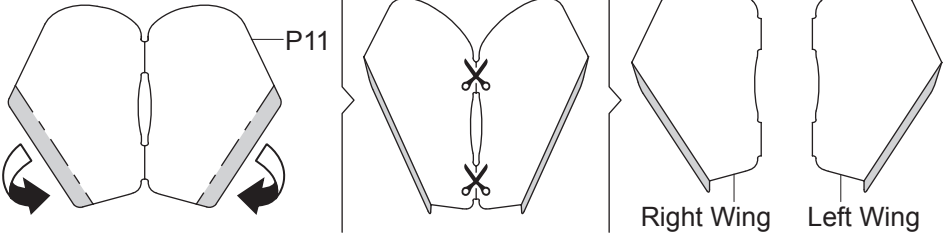

9

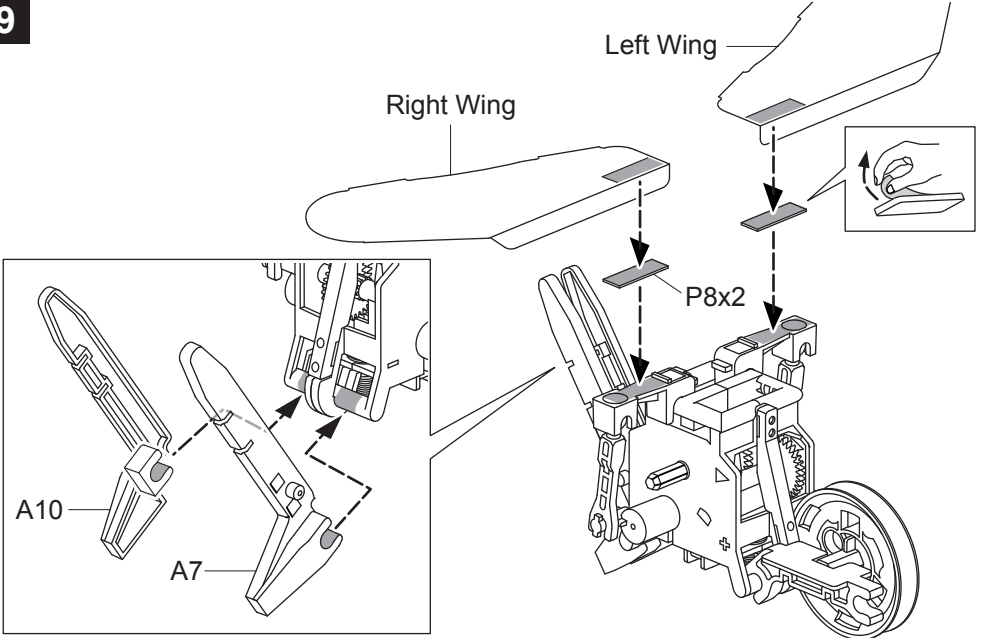

10

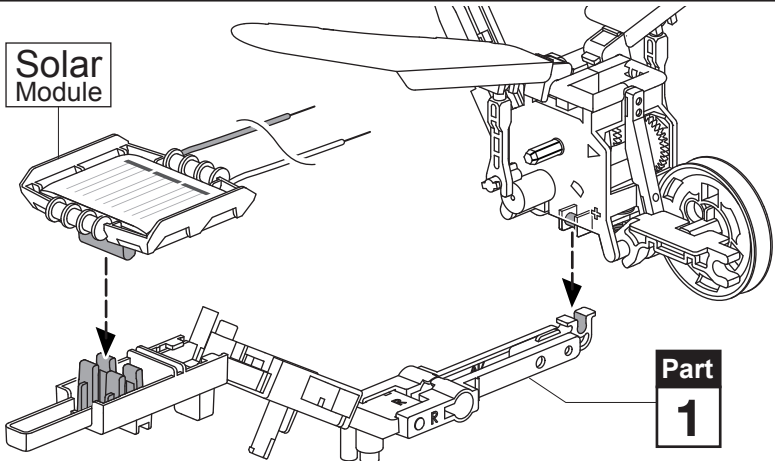

11

WHITE WIRE CONNECT -

GREEN WIRE CONNECT +

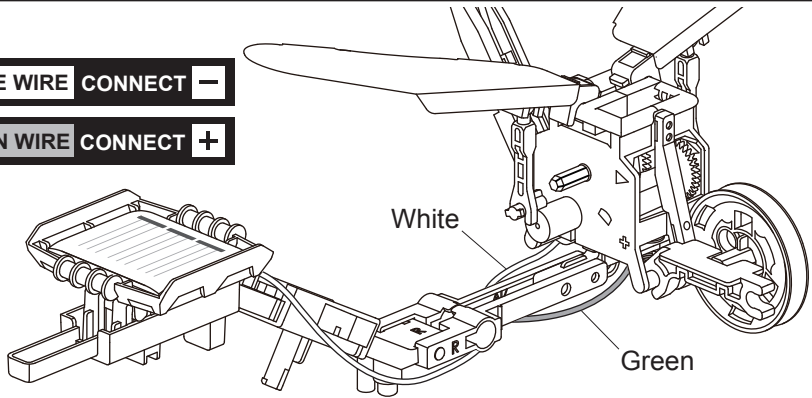

Bottom View

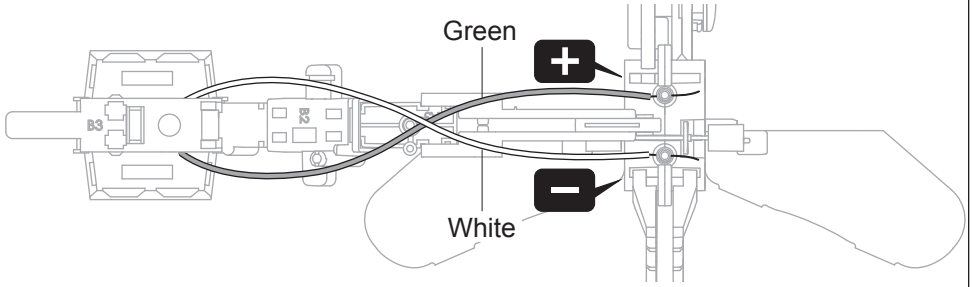

12

Part
2

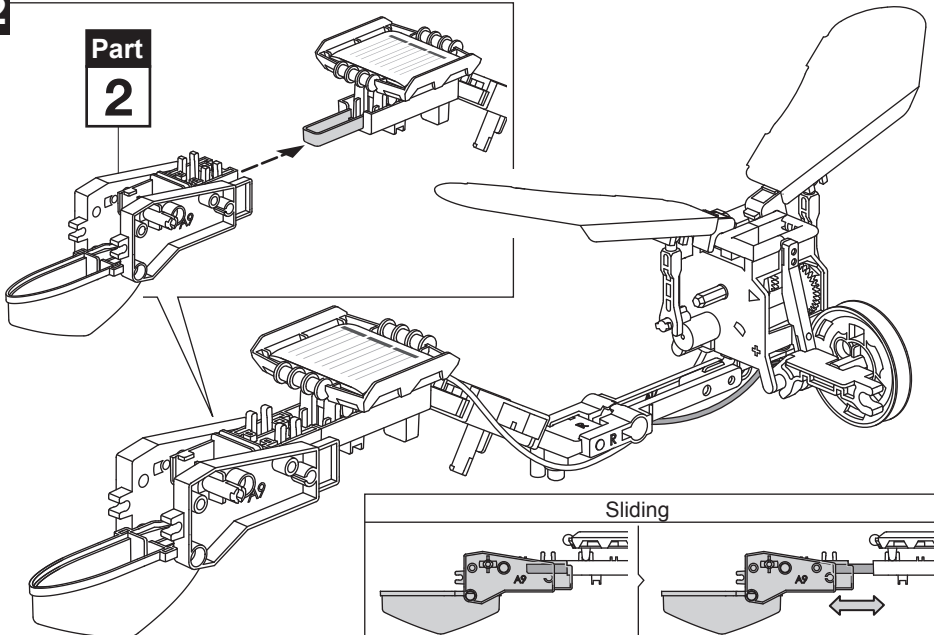

13

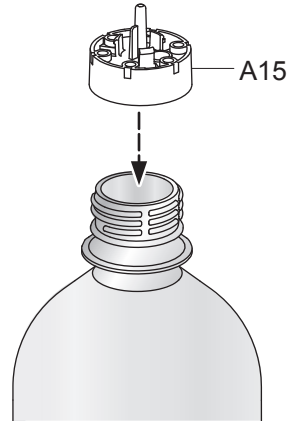
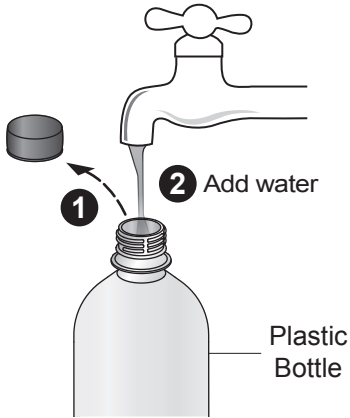

14

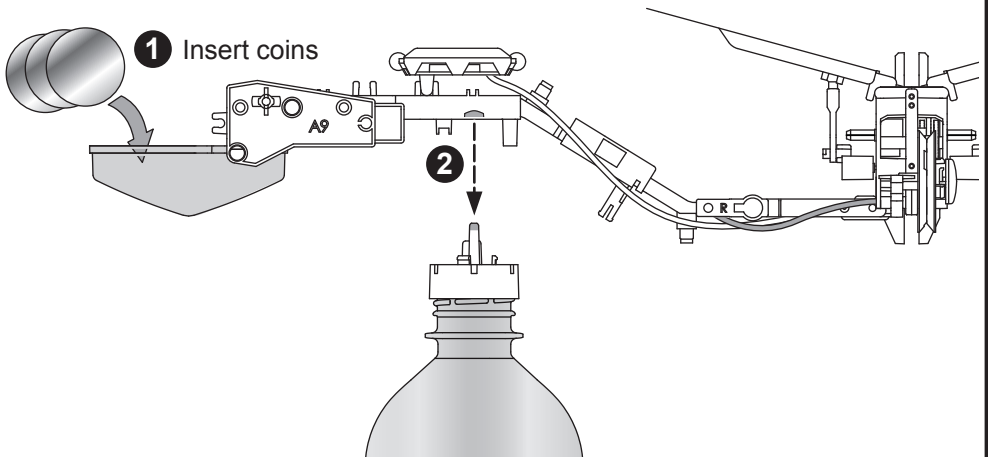

15 Adjust **Part 2** to balance the lever.

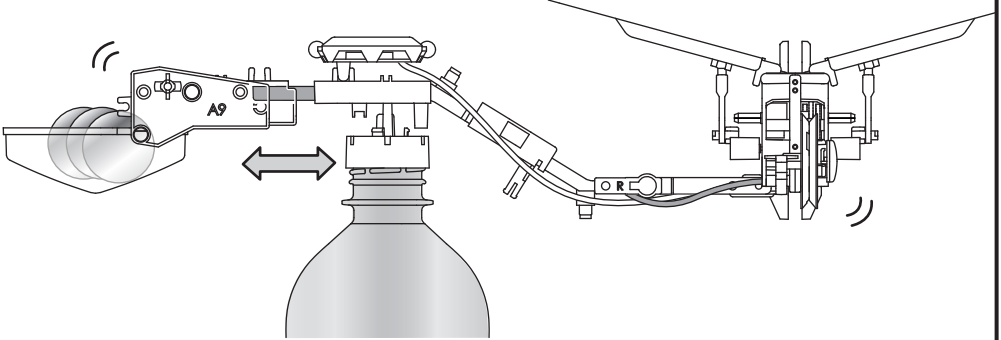

16 Running

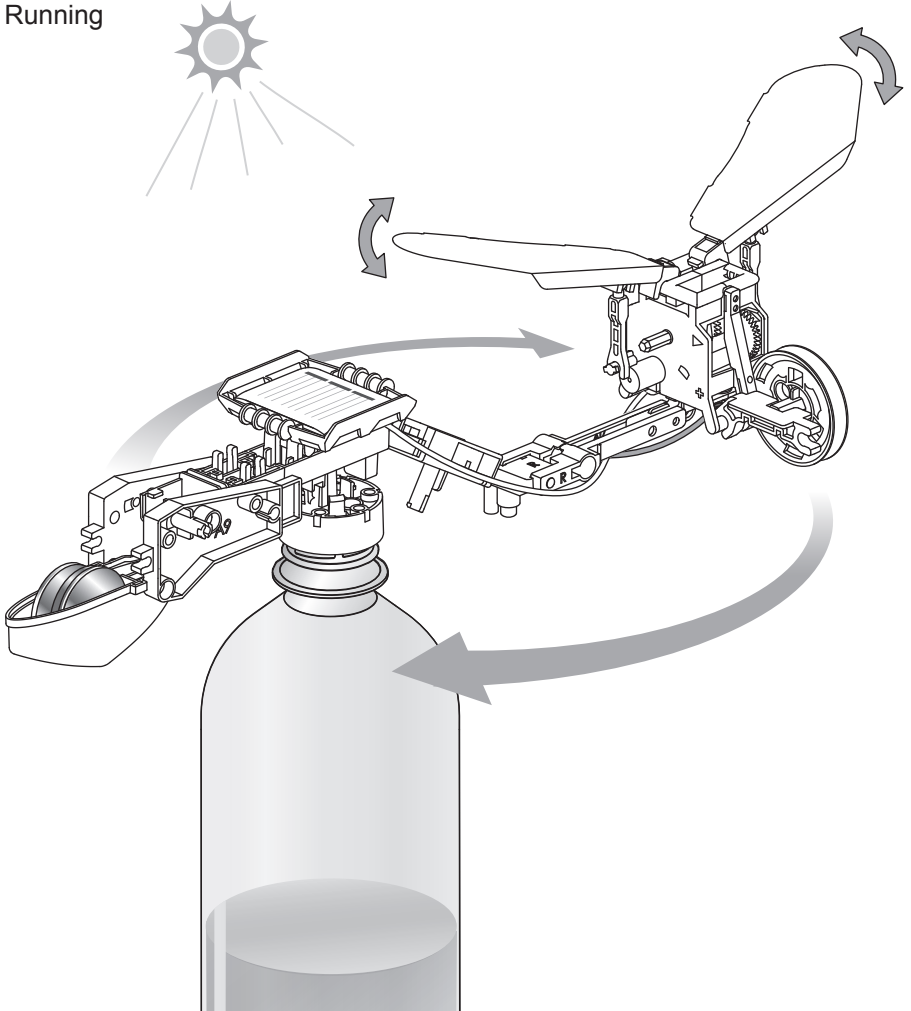

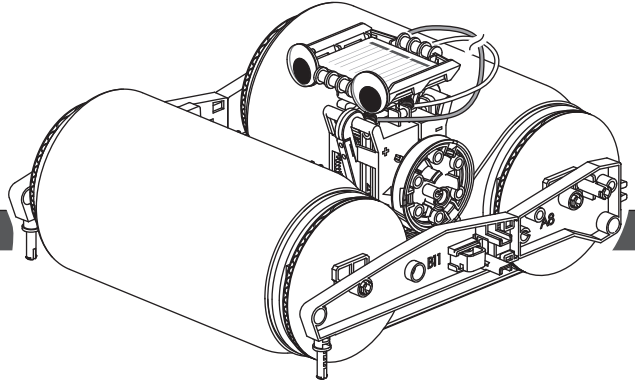

Recycled Parts Required

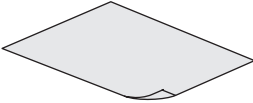

Paper



Soda Can
330ml~355ml

x2

! Same size is required

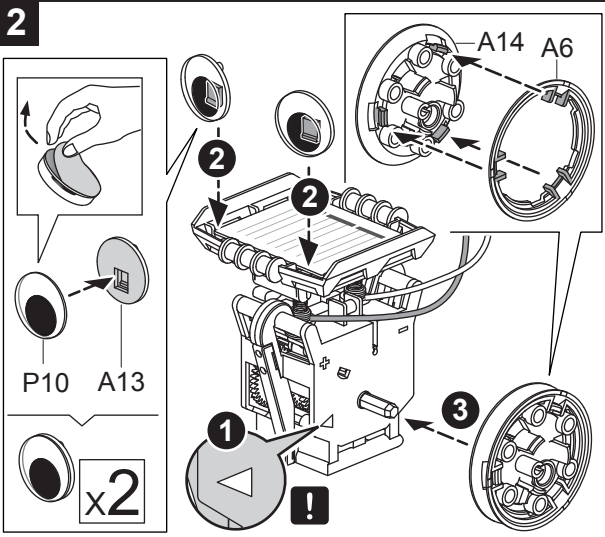
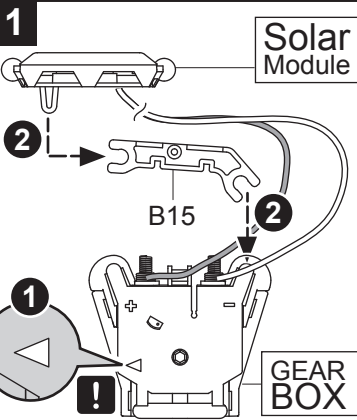
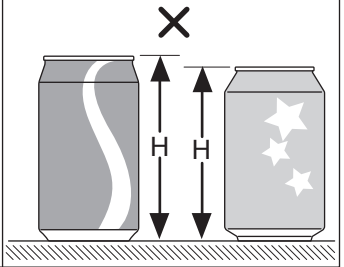
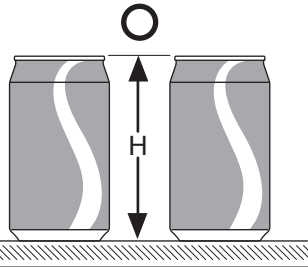

3 WHITE WIRE CONNECT -

3 GREEN WIRE CONNECT +

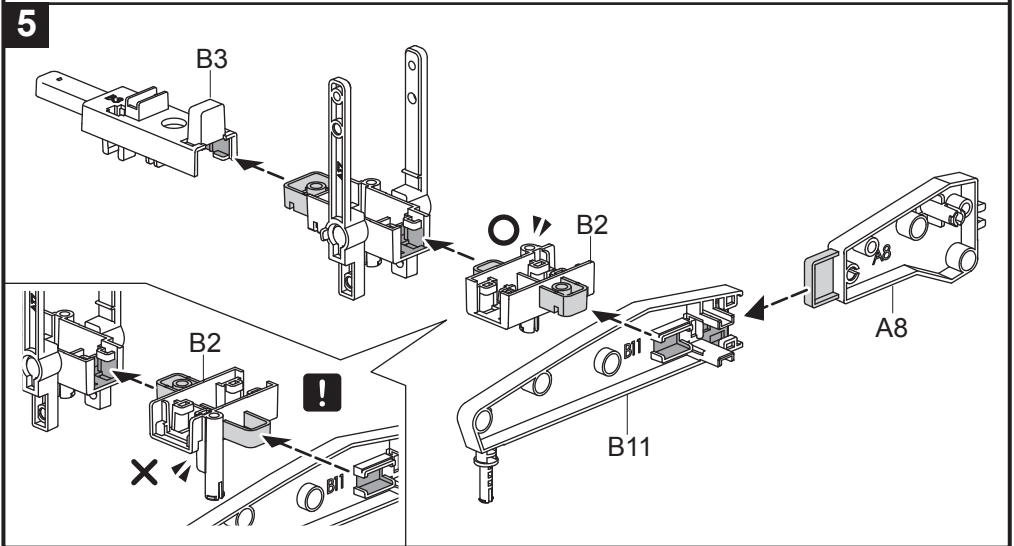
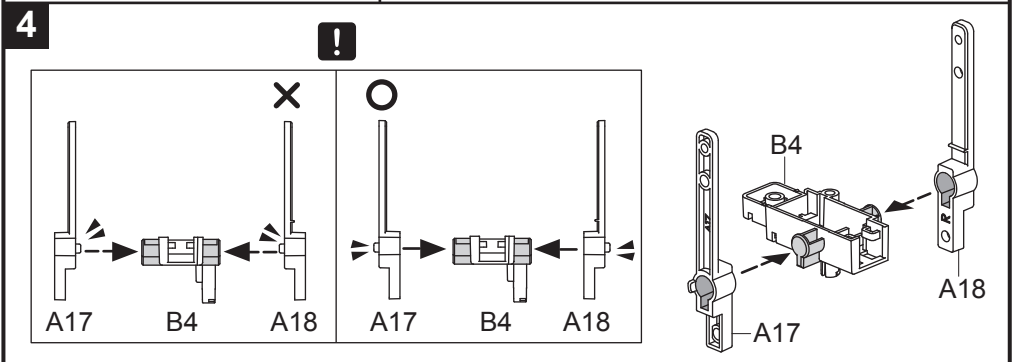
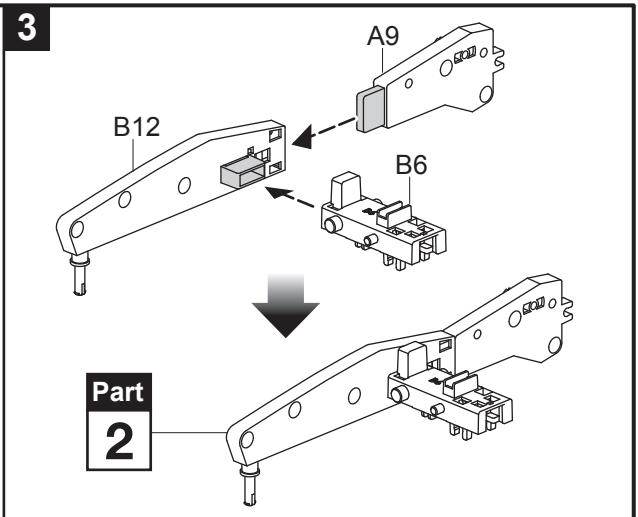
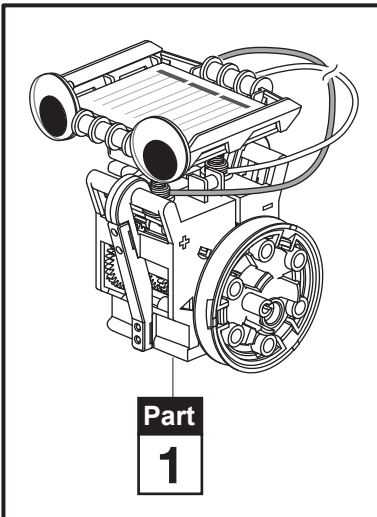

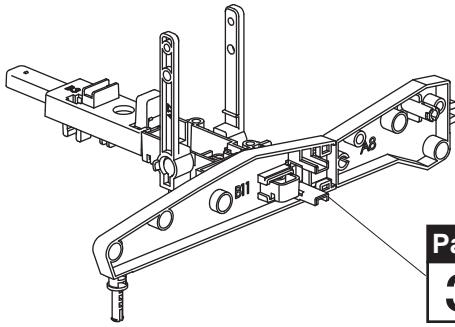

Part
3

6 Measure the size of the top of the can using the diagram below.

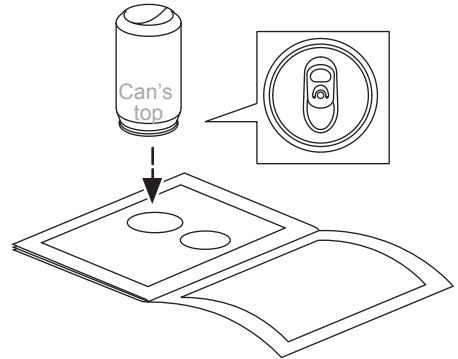

Soda can's top size 1:1

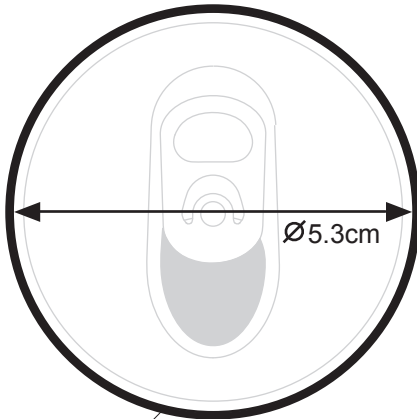

Small size

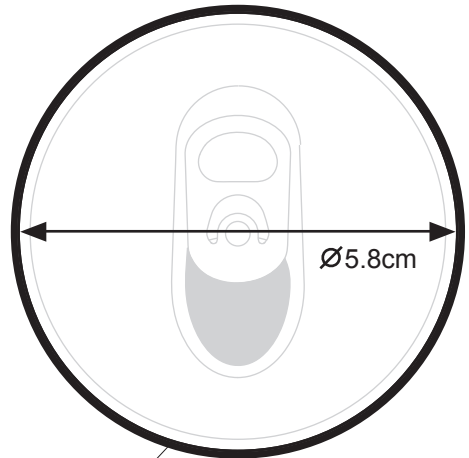

Large size

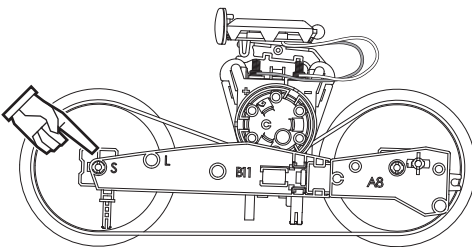

Notice:

If you're using a small size can (Ø 5.3cm), make sure to install into " S " hole at step **21** .

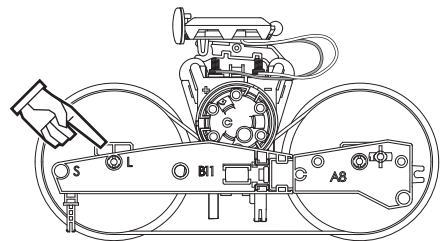

If you're using a large size can (Ø 5.8cm), make sure to install into " L " hole at step **21** .

7 Unfold colored gift box

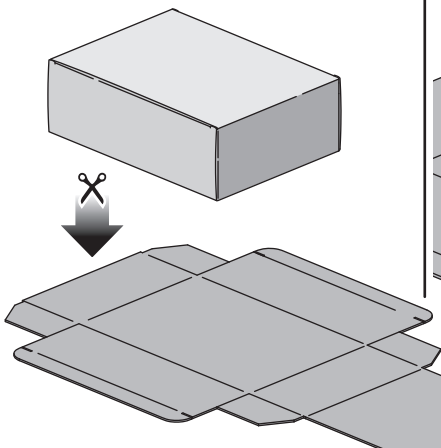

8 Trace around the top of the can to create two circles in the colored gift box.

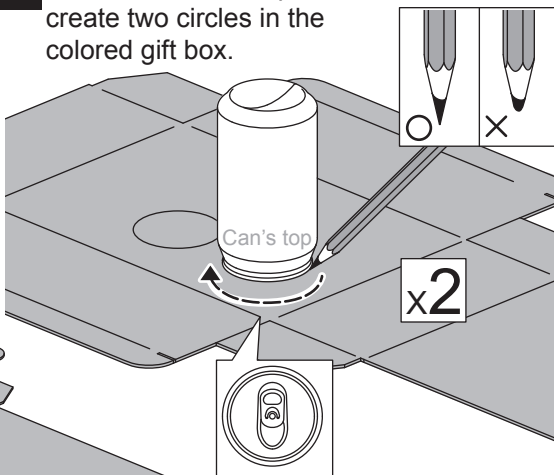

9 Using scissors cut out the two circles

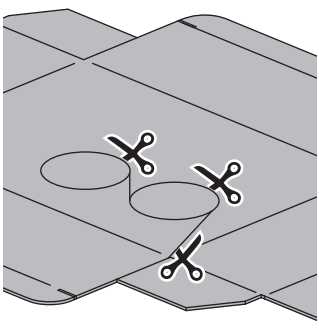

Part A
x2

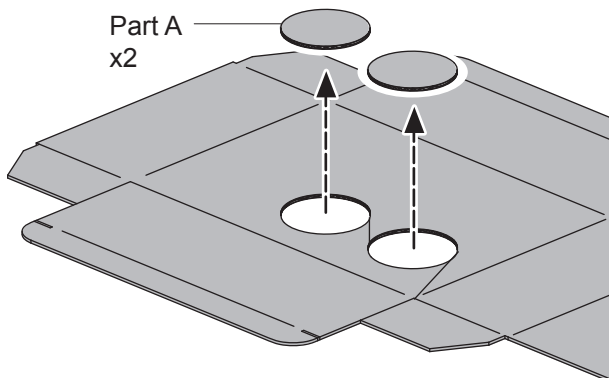

10 Using any sheet of paper, trace around the top of the can to create a circle and cut it out as shown below.

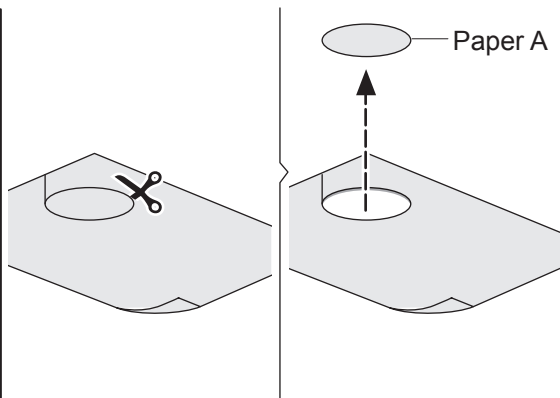
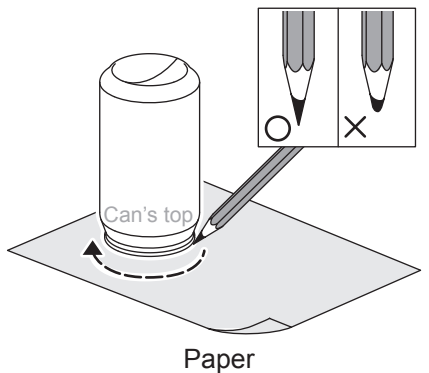

11 Locate a central point from paper A

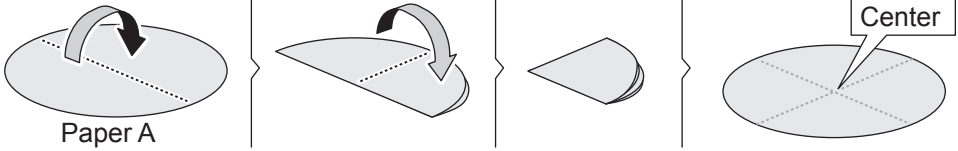

12

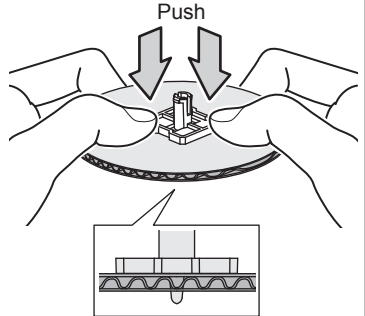
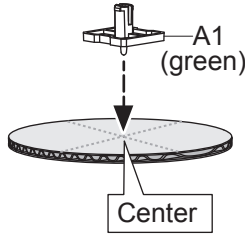
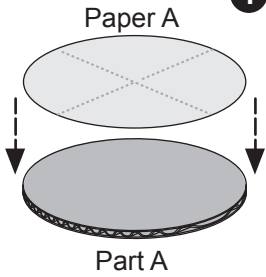

Push A1 through the circle's central point (as illustrated above)

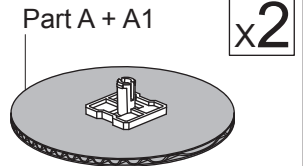
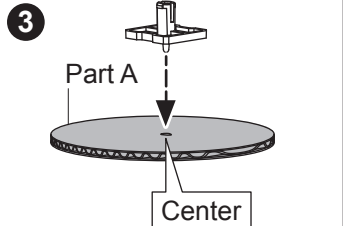
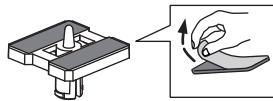
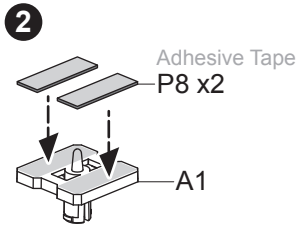
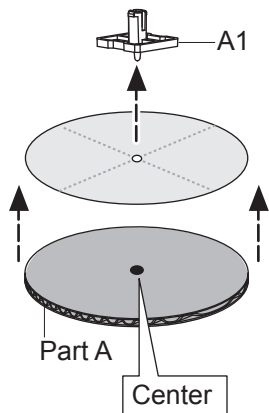

13

Sponge P9x2

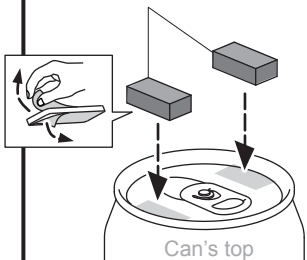

Part A + A1

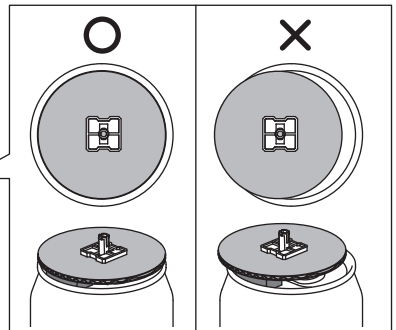
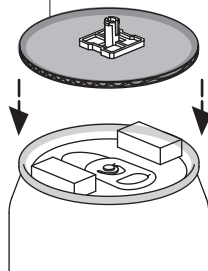

14 Trace around the bottom of the can to create two circles in the colored gift box. (See Below)

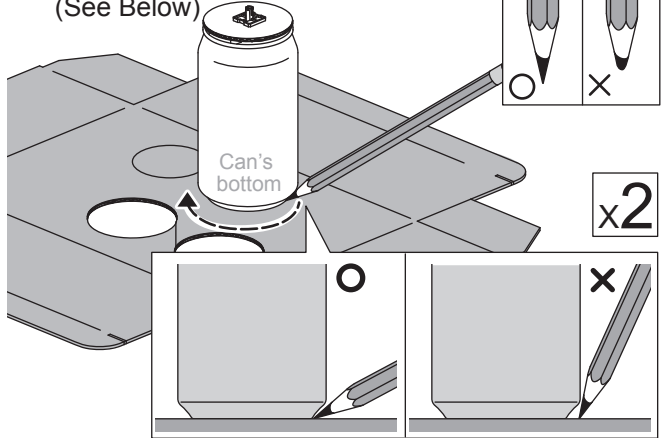

15

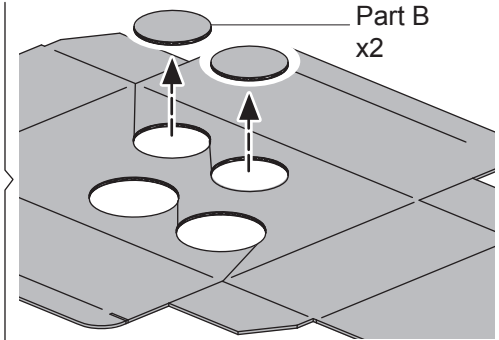
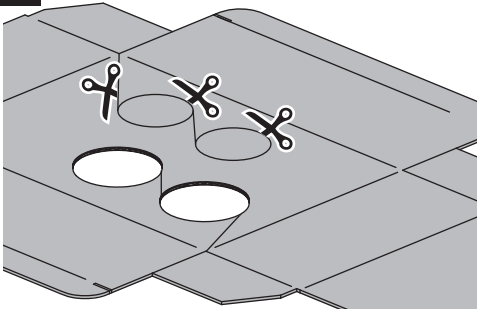

16 Using any sheet of paper, trace around the bottom of the can to create a circle and cut it out (See Below)

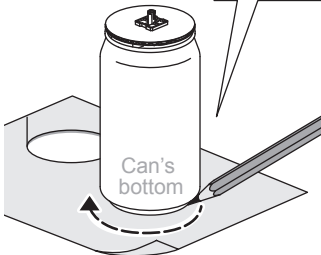
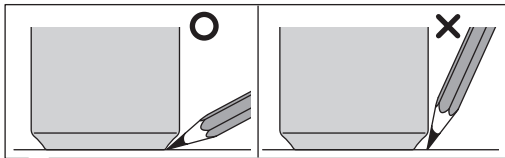
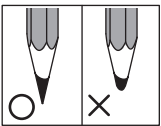

Normal Paper

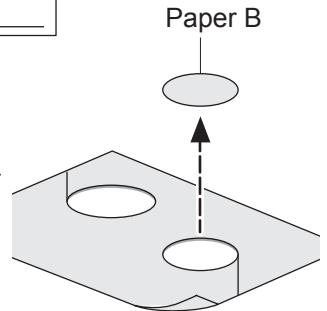
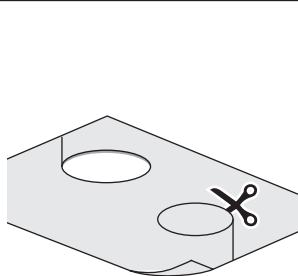

17 Locate a central point from paper B

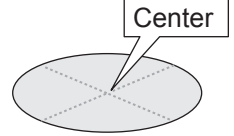
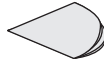
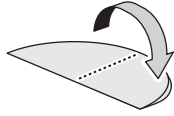
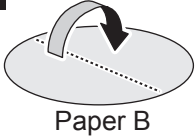

18

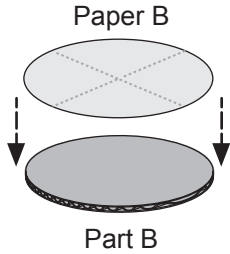

1

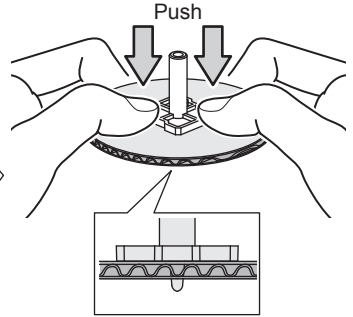
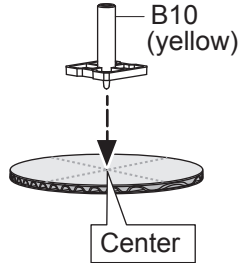

Push B10 through the circle's central point (as illustrated above)

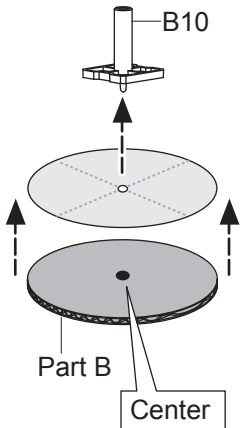

2

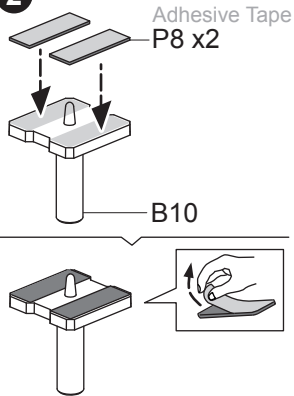

3

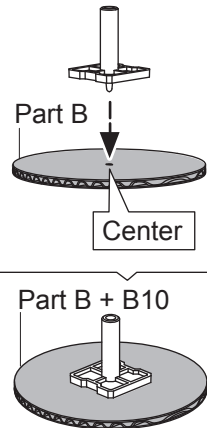

19

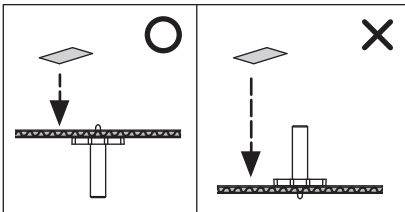

Adhesive Tape P8 x6

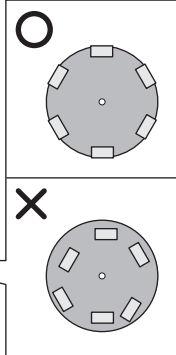
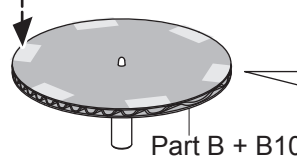

20

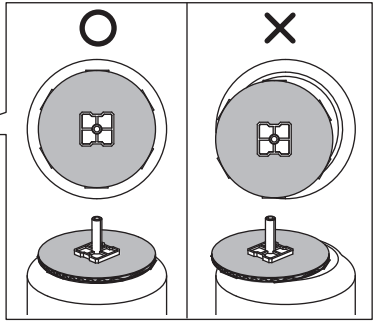
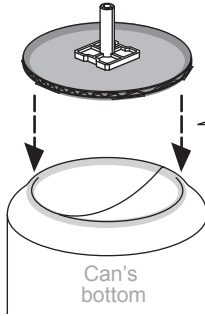
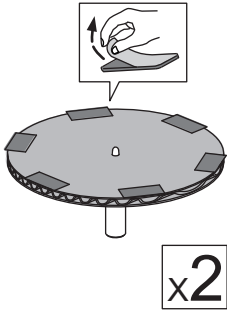

21

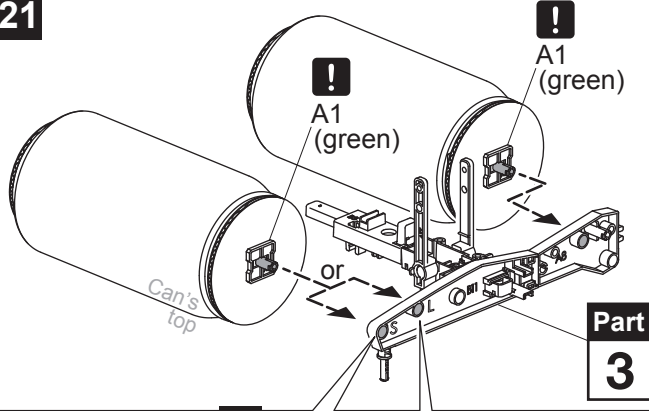

! Refer to Step **6** in order to install A1 in the correct opening ("S" Hole or "L" Hole)

22

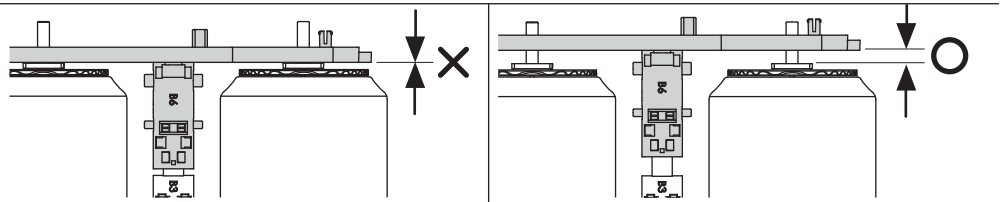
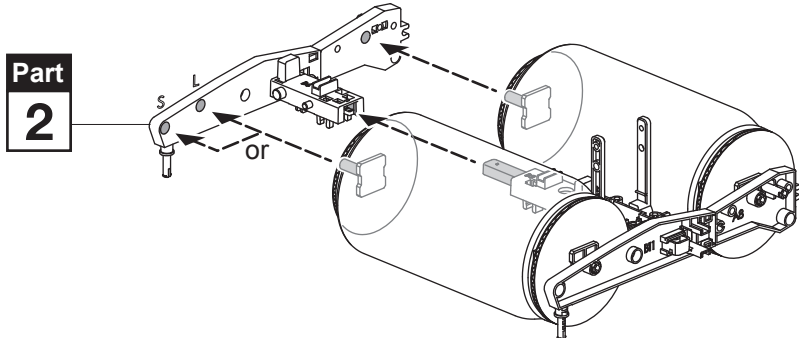

23

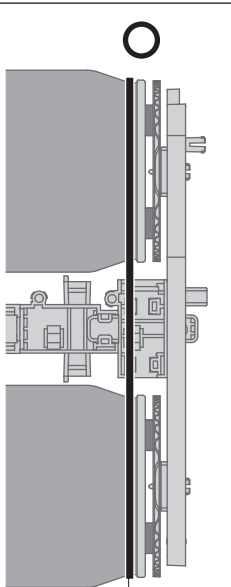

P13

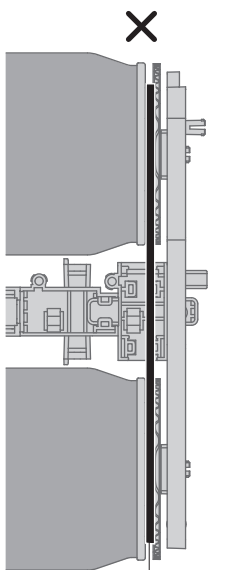

P13

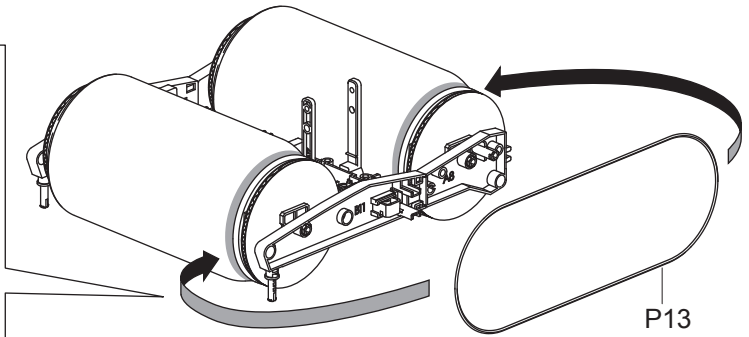

P13

24

Part
1

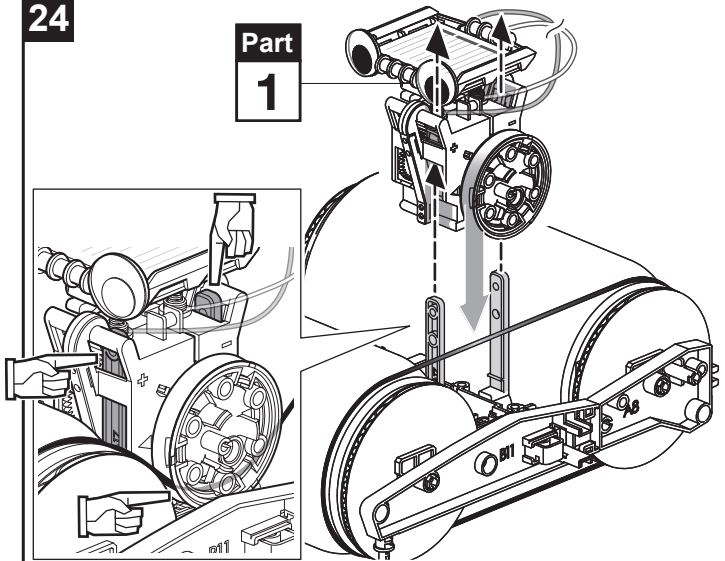

25 Running

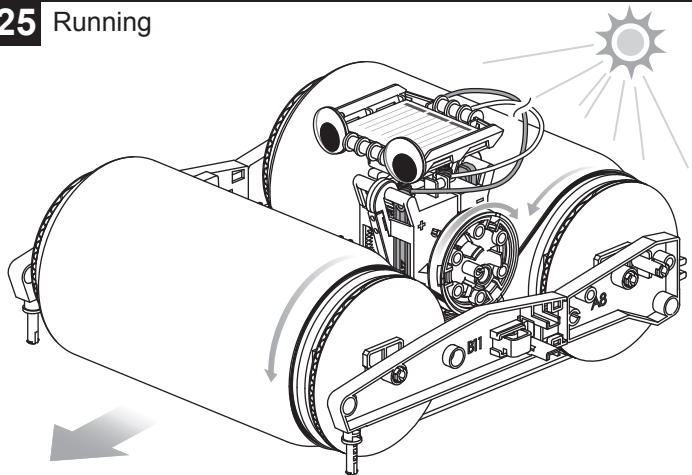

It's time to have some FUN !

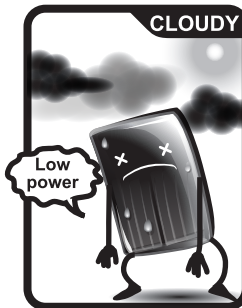
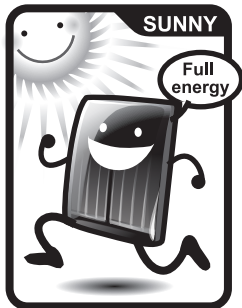

1. Take outside under direct sunlight. Best results are obtained when operated on a sunny day.
2. For indoor fun, use a 50 watt halogen light. The product will not run on a cloudy day, shaded locations, indirect sunlight, or under a Fluorescent light.

