



Mini Robot GT4217 User Manual

AGE 5+

Operation

1. Remove the sticky tape from the sides; twist and separate the top and bottom remote control.
2. Press and hold the button on the top of the remote control; while sliding the robot to the left position as shown in the diagram to release the robot from the controller.
3. Use a Phillips screwdriver (not included) to remove the screw from the bottom of the remote control. Remove the battery cover and insert 2 x AAA 1.5V Alkaline batteries (not included) using the correct positive and negative polarity. Replace the battery cover and tighten the screw in place.

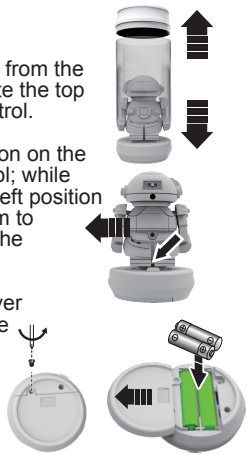

4. Press any button on the remote control; the LED indicator will light up showing that the battery is installed correctly.
5. Remove the battery tab from the rear of the robot to allow the batteries to make contact. There is already 3 pieces of LR44 button cell batteries included in the robot. To replace the batteries; use a philips screwdriver to loosen the battery cover and replace with 3 x LR44 1.5V button cell batteries.
6. The forward and backward buttons are shown below; the robot will go forwards and backwards with a right turn.

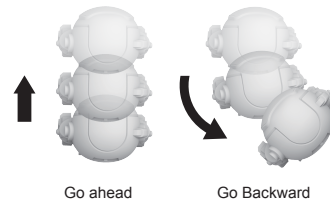
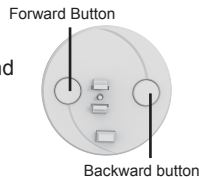
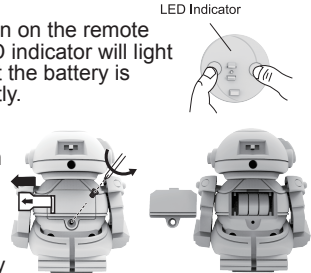

Go ahead

Go Backward

Specifications

Play Time:	Up to 40 minutes
Infrared Distance:	Up to 10m
Batteries:	
Robot:	3 x LR44 Button Cells (Included)
Remote Control:	2 x AAA (Not Included)

Safety

- o **WARNING - KEEP BATTERIES OUT OF REACH OF CHILDREN**
- o Swallowing may lead to serious injury in as little as 2 hours or death, due to chemical burns and potential perforation of the oesophagus.
- o If you suspect your child has swallowed or inserted a button battery immediately call the 24-hour Poisons Information Centre on 13 11 26 (Australia) or 0800 764 766 (New Zealand) for fast, expert advice.
- o Examine devices and make sure the battery compartment is correctly secured, e.g. that the screw or other mechanical fastener is tightened. Do not use if compartment is not secure.
- o Dispose of used button batteries immediately and safely. Flat batteries can still be dangerous. Tell others about the risk associated with button batteries and how to keep their children safe.

Distributed by:
TechBrands by Electus Distribution Pty. Ltd.
320 Victoria Rd, Rydalmere
NSW 2116 Australia
www.techbrands.com Made in China