

# GT-3741 Gyroscope Module Installation Instructions

Step 1: Unplug the steering servo's 3-pin male connector from Ch.1 on the receiver

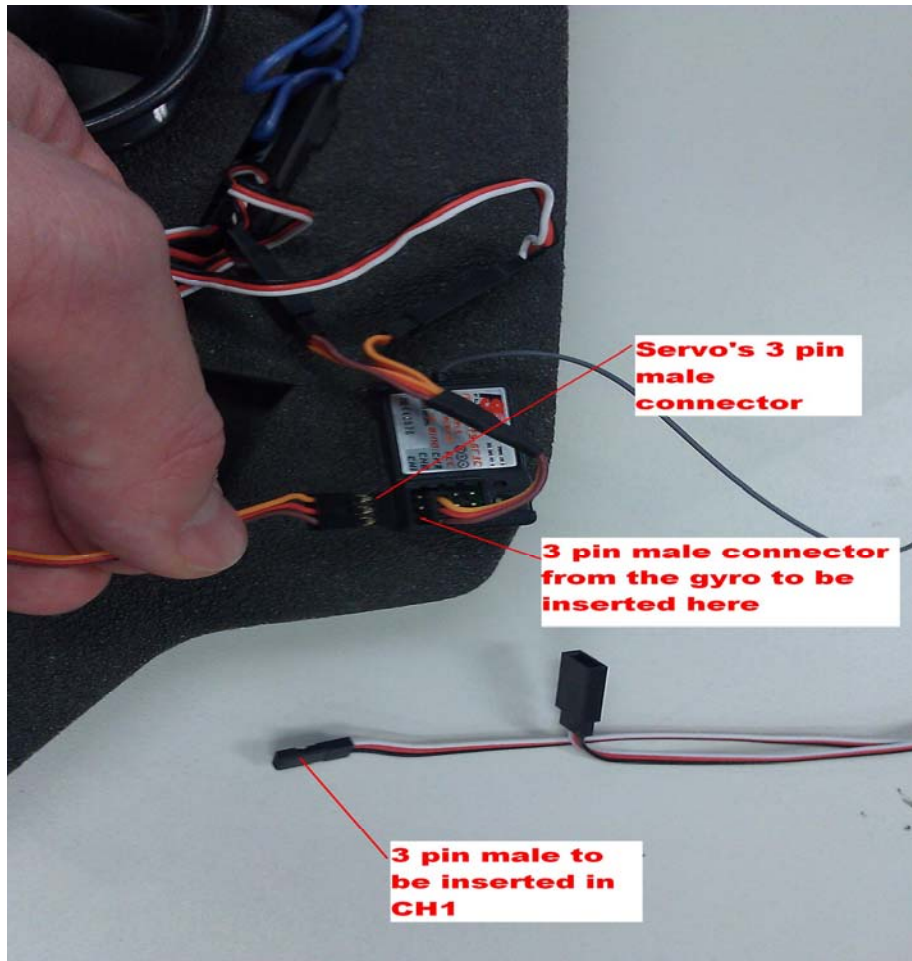

Step 2: Plug the gyroscopes male 3-pin connector from the gyro into Ch.1 on the receiver

Step 3: Plug 3-pin male connector from servo into female 3-pin socket of the gyroscope

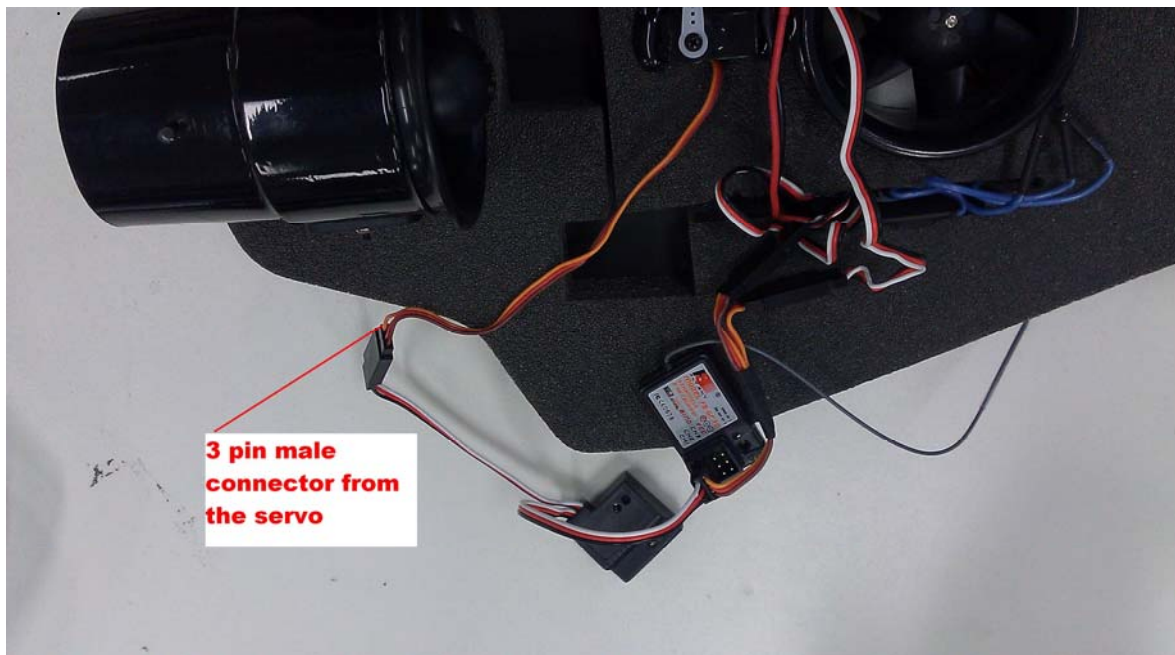

Step 4: Mount the gyroscope module into the provided space using the attached double sided tape, and neaten up wires

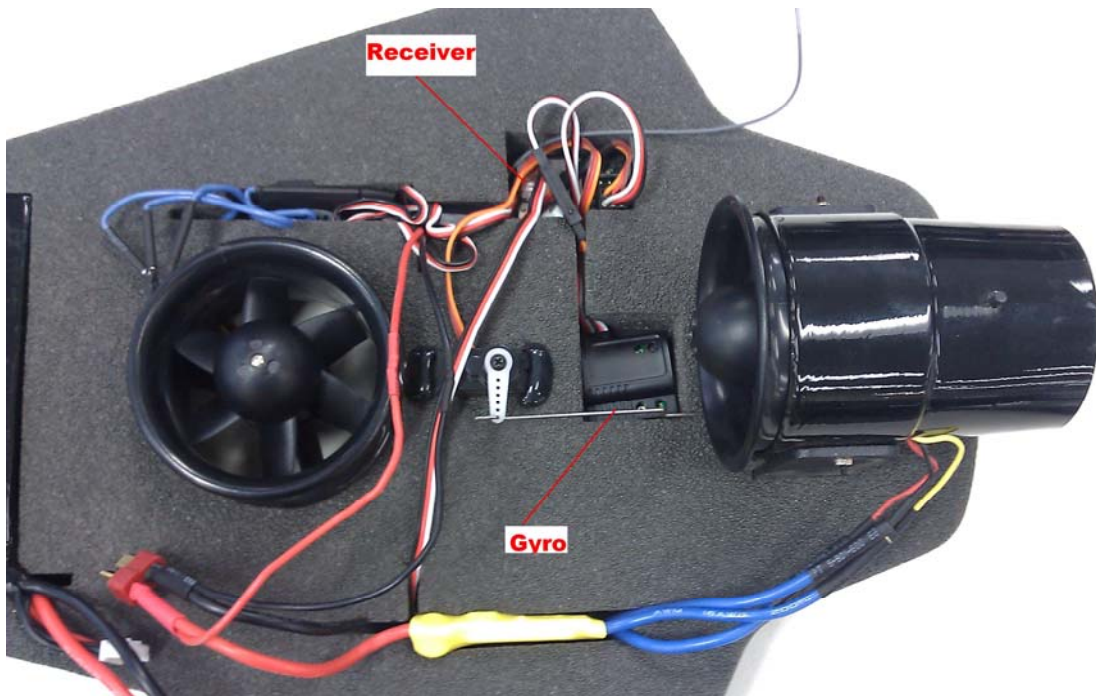

**Please Note:**

- Please ensure to unplug the battery from the hovercraft after each use.
- If these batteries are left connected for a long period of time, they will drain to a level where they can no longer be recharged.
- It is also recommended to charge the batteries before placing the hovercraft into storage to increase the life of the battery.
- **DO NOT** leave batteries connected when not in use.