



DIGITECH
Audio Visual

50m 1080p HDMI Cat5e/6 Extender



User Manual
AC-1783

Box Contents:



1 x HDMI Transmitter



1 x HDMI Receiver



1 x Infrared Emitter



1 x Infrared Receiver



1 x Mains Power Adaptor

Product Diagram:

Transmitter:

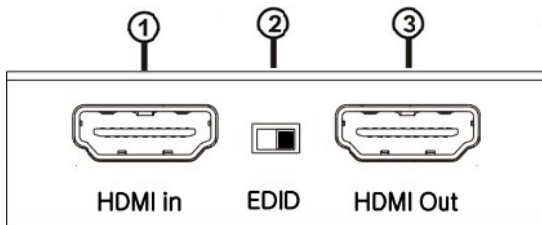

#	Feature:	Description:
1	HDMI Input	Connect to the HDMI source device
2	Extended Display Identification Data (EDID) Switch	Select the right EDID switch to copy the HDMI Pass-Through EDID information to the source. Select the left position to copy the receiver display EDID to the source.
3	HDMI Output	Connect to a TV or monitor

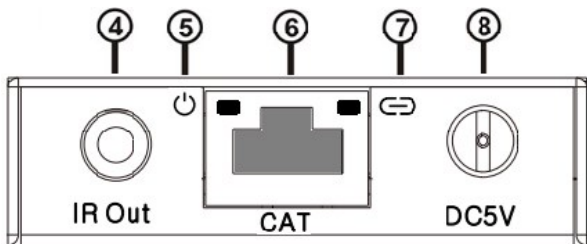

#	Feature:	Description:
4	Infrared Output	Connect with the infrared Emitter
5	Power LED Indicator	Displays the power status
6	Ethernet Output	Connect to a Cat5e or Cat6 ethernet network cable
7	Link LED Indicator	Indicates when a device is connected to the HDMI source
8	DC Power Socket	Connect to the 5VDC mains power adaptor

Receiver:

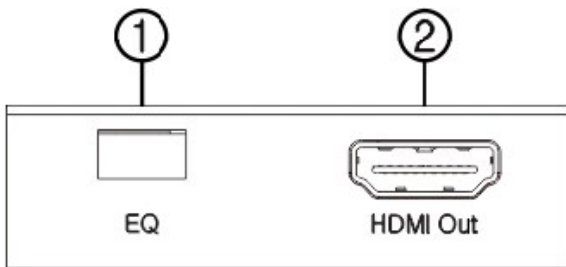

#	Feature:	Description:
1	EQ Switch	HDMI Receiver Equaliser Switch
2	HDMI Output	Connect to a TV or monitor

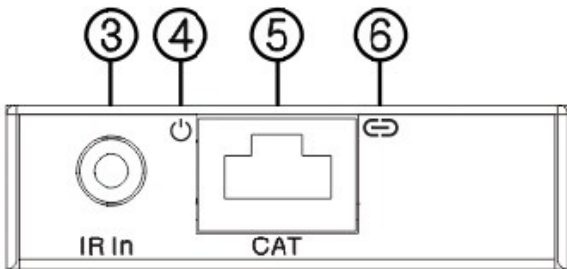

#	Feature:	Description:
3	Infrared Input	Connect with the infrared Receiver
4	Power LED Indicator	Displays the power status
5	Ethernet Input	Connect to a Cat5e or Cat6 ethernet network cable
6	Link LED Indicator	Indicates when a device is connected to the HDMI source

Connection Diagram:

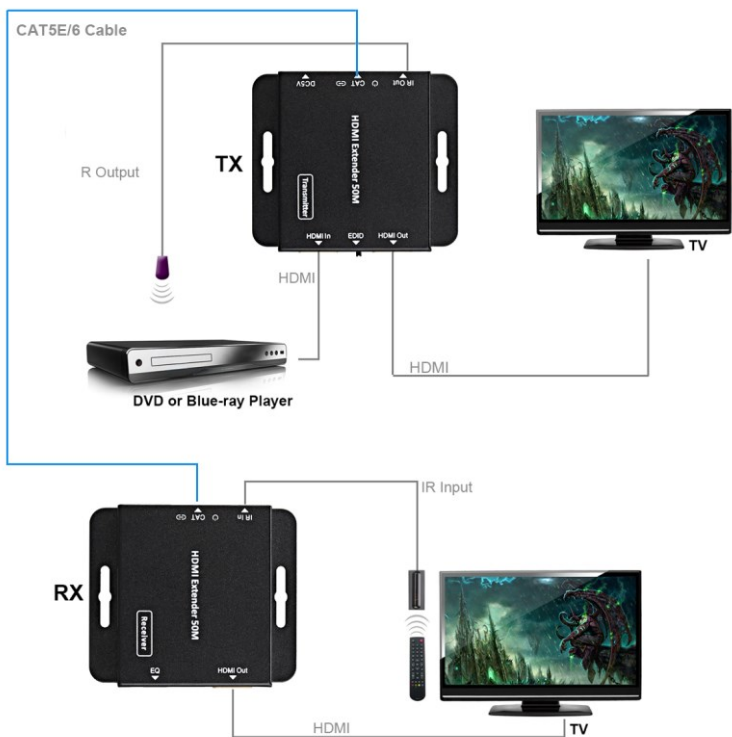

Operation:

Transmitter:

1. Connect the DC plug of the mains power adaptor to the power socket of the transmitter. Plug in the mains power adaptor to a 240VAC wall socket.
2. Connect a HDMI cable (not included) from your source device such as Pay TV, DVD player or media player to the HDMI input of the transmitter.
3. Connect a HDMI cable (not included) from the HDMI output of the transmitter to your TV or Monitor's HDMI input. This will allow you to view your TV or monitor while extending the signal.
4. Connect a Cat5e or Cat6 ethernet network cable to the ethernet output of the transmitter.
5. Connect the Infrared (IR) emitter cable to the IR output socket located on the transmitter.

6. Peel off the 3M sticker located on the back of the infrared emitter and stick the emitter in front of the infrared port of your device such as Pay TV, DVD player or media player. The remote control of your device will still work even with the emitter placed over the top of the infrared port.

Please refer to your devices user manual if you're unsure of where the infrared port is located.

Receiver:

1. Connect opposite end of the Cat5e or Cat6 ethernet network cable to the ethernet input of the receiver.
2. Connect a HDMI cable (not included) from the HDMI output of the receiver to your TV or Monitor's HDMI input.
3. Connect the infrared (IR) receiver cable to the IR input socket located on the receiver.
4. Place the infrared receiver end in front of your TV or monitor so the infrared can be controlled.

Troubleshooting:

Problem	Solution
No Video Output	Adjust the equaliser settings depending on the cable length of the ethernet cable. Refer to the above equaliser switch settings
	Adjust the EDID switch on the transmitter, switch it to the opposite position.
	Check to see your source device and monitors/TV's resolution and frequency matches the supported resolution of the HDMI extender.
	Check to see if your source device and TV's/monitors are all switched on
	Ensure you have a Cat5e/Cat6 standard ethernet cable connector, crossover cables will not work
	Check to see if the mains power adaptor is connected properly and switched on
	Reconnect the HDMI cables on both the transmitter and receiver

Problem	Solution
Image is flickering or unstable	Adjust the equaliser settings depending on the cable length of the ethernet cable. Refer to the above equaliser switch settings
	Check to see if the Link LED and Power LED indicators are lit
	Reconnect the HDMI cables on both the transmitter and receiver and make sure the HDMI cables are functioning correctly
Will not change channels on the infrared remote	Reattach the infrared emitter over the infrared port of your source device. The position may not be directly in line with your infrared port of your device.
	This device supports an infrared frequency of 20-60Khz, your device may not be compatible within this range. Refer to the manufacturers user manual of your device to confirm the range.
LED indicators won't show	Check to see if the mains power adaptors are connected properly and switched on
	Reconnect the HDMI cables on both the transmitter and receiver

Safety:

1. Do not open or repair the device without professional assistance to avoid electrical shock.
2. Do not expose this unit to water, moisture or any liquid.
3. Position the unit in a well ventilated area to prevent the unit from overheating.
4. Only use the supplied 5VDC, 1A power adaptor. If you use any third party power supplies, ensure the voltage is the same to prevent the unit from damage.

Features:

- . 40m (Cat5e), 50m (Cat6) Transmission Range
- . Power Over Cat5e/Cat6 Cable (PoC)
- . HDMI Pass-Through
- . HDCP & 3D Support
- . Adjustable Equaliser
- . EDID Data Transmission
- . Infrared Extender

Specifications:

Transmission Range: Up to 50m (Cat6)
Up to 40m (Cat5e)

HDMI: 1.4b

HDCP: 1.4

Resolution: 1080p (1920 x 1080) @ 50/60Hz
1080i (1920 x 1080) @ 50/60Hz
720p (1280 x 720) @ 50/60Hz
480p (640 x 480) @ 60Hz
480i (640 x 480) @ 60Hz

Video Bandwidth: 4.95Gbps

Audio: LPCM 2/5.1/7.1CH, Dolby Digital, DTS 5.1,
Dolby Digital+, Dolby TrueHD, DTS-HD
Master Audio, Dolby Atmos, DTS:X

Colour Depth: 24-bit

Infrared Frequency: 20-60KHz

Power: 5VDC, 1A (Transmitter)

Power Consumption: 200mA (Max)

Dimensions: 80(D) x 69(W) x 18(H)mm (Each)

Distributed by:
TechBrands by Electus Distribution Pty. Ltd.
320 Victoria Rd, Rydalmere
NSW 2116 Australia
Ph: 1300 738 555
Int'l: +61 2 8832 3200
Fax: 1300 738 500
www.techbrands.com